

LINTEL EL. ALONG GRID B BETWEEN 1 TO 11

SCALE: 1/8" = 1'-0"

1
S0151

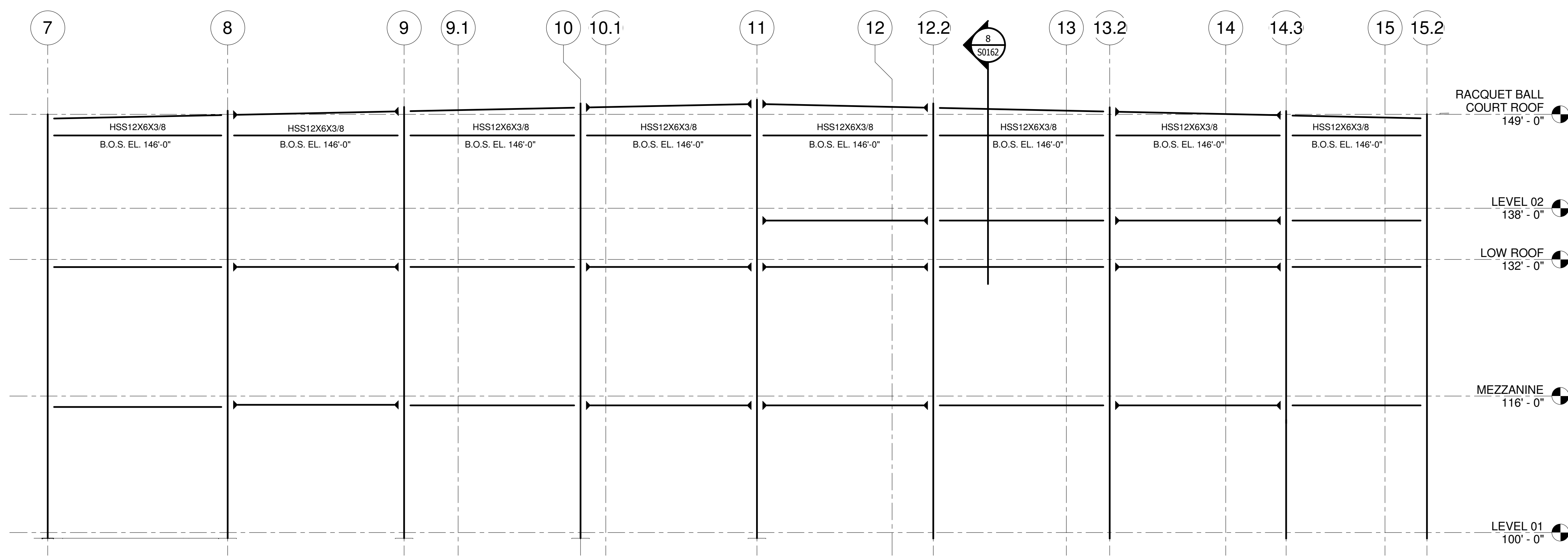

LINTEL EL. ALONG GRID F BETWEEN 7 TO 15.2

SCALE: 1/8" = 1'-0"

2
S0151

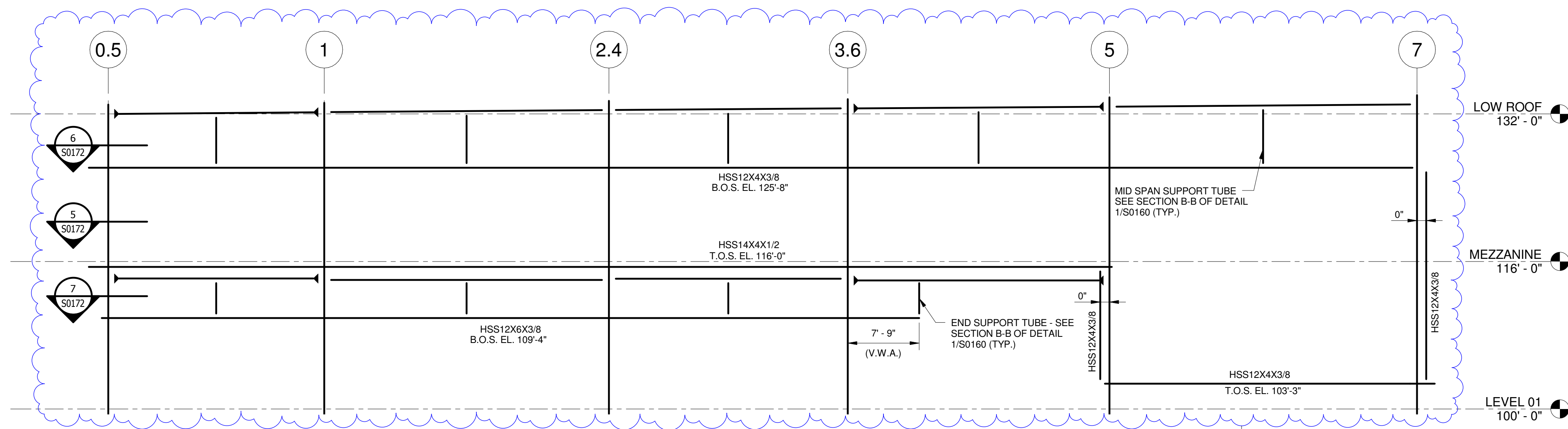

LINTEL EL. ALONG GRID N

SCALE: 1/8" = 1'-0"

3
S0151

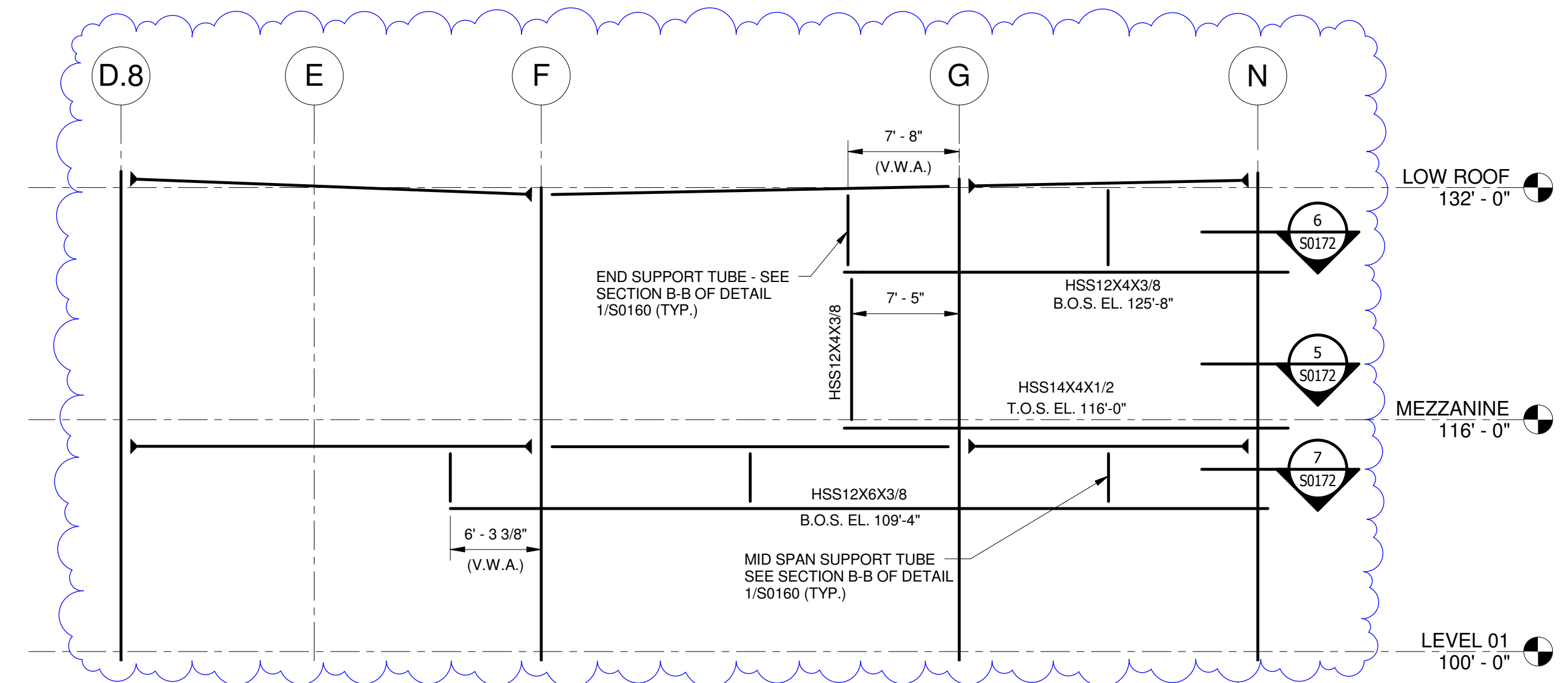

LINTEL EL. ALONG GRID 0.5

SCALE: 1/8" = 1'-0"

4
S0151

LEGEND:
 = CLOUDED ITEMS WHERE CHANGED PER ADDENDUM
 = ADDENDUM NUMBER

DISCLAIMER NOTE:
 THIS SET OF CONSTRUCTION DRAWINGS HAS BEEN UPDATED TO INCLUDE ANY CHANGES ISSUED THROUGH ADDENDUM OR OTHER MEANS. EVERY EFFORT HAS BEEN TAKEN TO INCLUDE ALL CHANGES TO DATE. THE CONTRACTOR IS STILL RESPONSIBLE FOR PROVIDING ANY ITEMS THAT WERE SHOWN AS PART OF THE ORIGINAL BID SET THAT MAY HAVE BEEN OVERLOOKED AND NOT INCLUDED IN THIS SET.

University of Louisville - Student Recreation Center (Phase #3 - Construction Set) Louisville, Ky

Omni ARCHITECTS
 212 North Upper Street
 Lexington, Kentucky 40507-1001
 p 859.252.6664 f 859.253.2358
 www.omniarchitects.com



UNIVERSITY OF LOUISVILLE



RANGASWAMY AND ASSOC., INC.
 Suite 420, The Landmark Building
 Louisville, Kentucky 40202
 Fax: (502) 586-2240; www.rangaswamy.com

#	Revision Date
2	Jan 24, 2012
3	Jan 31, 2012

Drawing Name: STRUCTURAL EXTERIOR LINTEL ELEVATIONS
 U of L Project Number: Omni - 1105.00
 Project Number: Cannon - 08667.00
 Date: March 02, 2012
 Drawn By: VPP
 Checked By: ANTHONY

S0151

© Cannon Design 2010. All rights reserved. No part of this drawing may be reproduced or utilized in any form without written authorization by The Cannon Corporation.
 02-03-2012 16:27:07