

GENERAL NOTES

APPROVAL #2, REV 1/2
DATE: 3-02-2012

- SEWAGE FROM THIS DEVELOPMENT SHALL BE TREATED AT THE MORRIS FOGHART TREATMENT PLANT.
- ALL PIPE TO BE PVC D-304 OR PVC CORRUGATED PIPE, ASTM F-349.
- APPLICABLE AND THE CAPACITY CHARGE FEES APPLICABLE AT THAT TIME ARE PAID (ALL FEES ARE TO BE PAID BY CONTRACTOR).
- LOUISVILLE AND JEFFERSON COUNTY METROPOLITAN SEWER DISTRICT STANDARD SPECIFICATIONS ARE TO BE USED BY CONTRACTOR.
- ERFC PLANS WILL BE SUBMITTED WITH STORM CONSTRUCTION PLANS.
- ALL MANHOLES MUST INCLUDE CHIMNEY SEALS. THE MANHOLE CHIMNEY SECTION SHALL BE SEALED AND MADE WATER-TIGHT USING EITHER A MECHANICALLY LOCKING INTERNAL BUTL CHIMNEY SEAL OR A CHEMICALLY BONDING CHIMNEY SEAL AS DETAILED ON THE PLANS. INSTALLATION OF THE CHIMNEY SEAL SHALL BE PERFORMED BY MANUFACTURER CERTIFIED PERSONNEL. THE CHIMNEY SEALING PRODUCT SHALL BE ON THE MSD PRE-APPROVED PRODUCT LIST AND THE PRODUCT USED SHALL BE IDENTIFIED ON THE AS BUILT DRAWINGS.
- A REQUEST FOR SANITARY SEWER CAPACITY WILL BE SUBMITTED AND APPROVED BY METROPOLITAN SEWER DISTRICT.
- ALL PIPE DETAILED SHOWN ON THESE PLANS REPRESENTS PROPOSED DRAINAGE.
- FOR LOCATIONS OF WATER-TIGHT AND NON-WATER-TIGHT MANHOLES, SEE PLAN AND PROFILE SHEETS.
- MANHOLES SHALL BE 4' INSIDE DIAMETER UNLESS OTHERWISE NOTED.
- FOR LOCATIONS OF WATER-TIGHT AND NON-WATER-TIGHT MANHOLES, SEE PLAN AND PROFILE SHEETS.
- ALL STAKES TO BE CONSTRUCTED TO A POINT 4 FEET BELOW THE GROUND SURFACE UNLESS OTHERWISE DIRECTED.
- A BRAP PIPE SHALL BE PROVIDED WHERE THE SEWER ENTERS THE MANHOLE AT TWO FEET OR MORE ABOVE THE MANHOLE INVERT. FIBER OPTIC CABLE SHALL BE PROVIDED AFTER THE FINAL BACKFILL HAS BEEN IN PLACE FOR AT LEAST 30 DAYS. SMO PIPE SHALL EXCEED A DEFLECTION OF 5% IF THE DEFLECTION TEST IS TO BE RUN USING A ROAD BALL OR WANDERL. IT SHALL HAVE A DIAMETER EQUAL TO 95% OF THE INSIDE DIAMETER OF THE PIPE. THE TEST SHALL BE PERFORMED WITHOUT MECHANICAL PULLING EITHER A MECHANICALLY LOCKING INTERNAL BUTL CHIMNEY SEAL OR A CHEMICALLY BONDING CHIMNEY SEAL AS DETAILED ON THE PLANS. INSTALLATION OF THE CHIMNEY SEAL SHALL BE PERFORMED BY MANUFACTURER CERTIFIED PERSONNEL. THE CHIMNEY SEALING PRODUCT SHALL BE ON THE MSD PRE-APPROVED PRODUCT LIST AND THE PRODUCT USED SHALL BE IDENTIFIED ON THE AS BUILT DRAWINGS.
- A REQUEST FOR SANITARY SEWER CAPACITY WILL BE SUBMITTED AND APPROVED BY METROPOLITAN SEWER DISTRICT.
- ALL PIPE DETAILED SHOWN ON THESE PLANS REPRESENTS PROPOSED DRAINAGE.
- FOR LOCATIONS OF WATER-TIGHT AND NON-WATER-TIGHT MANHOLES, SEE PLAN AND PROFILE SHEETS.
- MANHOLES SHALL BE 4' INSIDE DIAMETER UNLESS OTHERWISE NOTED.
- FOR LOCATIONS OF WATER-TIGHT AND NON-WATER-TIGHT MANHOLES, SEE PLAN AND PROFILE SHEETS.
- ALL STAKES TO BE CONSTRUCTED TO A POINT 4 FEET BELOW THE GROUND SURFACE UNLESS OTHERWISE DIRECTED.
- A BRAP PIPE SHALL BE PROVIDED WHERE THE SEWER ENTERS THE MANHOLE AT TWO FEET OR MORE ABOVE THE MANHOLE INVERT. FIBER OPTIC CABLE SHALL BE PROVIDED AFTER THE FINAL BACKFILL HAS BEEN IN PLACE FOR AT LEAST 30 DAYS. SMO PIPE SHALL EXCEED A DEFLECTION OF 5% IF THE DEFLECTION TEST IS TO BE RUN USING A ROAD BALL OR WANDERL. IT SHALL HAVE A DIAMETER EQUAL TO 95% OF THE INSIDE DIAMETER OF THE PIPE. THE TEST SHALL BE PERFORMED WITHOUT MECHANICAL PULLING EITHER A MECHANICALLY LOCKING INTERNAL BUTL CHIMNEY SEAL OR A CHEMICALLY BONDING CHIMNEY SEAL AS DETAILED ON THE PLANS. INSTALLATION OF THE CHIMNEY SEAL SHALL BE PERFORMED BY MANUFACTURER CERTIFIED PERSONNEL. THE CHIMNEY SEALING PRODUCT SHALL BE ON THE MSD PRE-APPROVED PRODUCT LIST AND THE PRODUCT USED SHALL BE IDENTIFIED ON THE AS BUILT DRAWINGS.
- A REQUEST FOR SANITARY SEWER CAPACITY WILL BE SUBMITTED AND APPROVED BY METROPOLITAN SEWER DISTRICT.
- ALL PIPE DETAILED SHOWN ON THESE PLANS REPRESENTS PROPOSED DRAINAGE.
- FOR LOCATIONS OF WATER-TIGHT AND NON-WATER-TIGHT MANHOLES, SEE PLAN AND PROFILE SHEETS.
- MANHOLES SHALL BE 4' INSIDE DIAMETER UNLESS OTHERWISE NOTED.
- FOR LOCATIONS OF WATER-TIGHT AND NON-WATER-TIGHT MANHOLES, SEE PLAN AND PROFILE SHEETS.
- ALL STAKES TO BE CONSTRUCTED TO A POINT 4 FEET BELOW THE GROUND SURFACE UNLESS OTHERWISE DIRECTED.
- A BRAP PIPE SHALL BE PROVIDED WHERE THE SEWER ENTERS THE MANHOLE AT TWO FEET OR MORE ABOVE THE MANHOLE INVERT. FIBER OPTIC CABLE SHALL BE PROVIDED AFTER THE FINAL BACKFILL HAS BEEN IN PLACE FOR AT LEAST 30 DAYS. SMO PIPE SHALL EXCEED A DEFLECTION OF 5% IF THE DEFLECTION TEST IS TO BE RUN USING A ROAD BALL OR WANDERL. IT SHALL HAVE A DIAMETER EQUAL TO 95% OF THE INSIDE DIAMETER OF THE PIPE. THE TEST SHALL BE PERFORMED WITHOUT MECHANICAL PULLING EITHER A MECHANICALLY LOCKING INTERNAL BUTL CHIMNEY SEAL OR A CHEMICALLY BONDING CHIMNEY SEAL AS DETAILED ON THE PLANS. INSTALLATION OF THE CHIMNEY SEAL SHALL BE PERFORMED BY MANUFACTURER CERTIFIED PERSONNEL. THE CHIMNEY SEALING PRODUCT SHALL BE ON THE MSD PRE-APPROVED PRODUCT LIST AND THE PRODUCT USED SHALL BE IDENTIFIED ON THE AS BUILT DRAWINGS.

BACKFILL NOTE

- TYPE 1 - SAND, TAMPED & SETTED.
TYPE 2 - SAND, TAMPED & SETTED.
(USE TYPE 2 BACKFILL UNLESS OTHERWISE NOTED)

UTILITY NOTE

ALL UTILITIES ON THESE PLANS ARE APPROXIMATE. HORIZONTAL SERVICE LINES ARE NOT SHOWN. THE CONTRACTOR OR SUBCONTRACTOR SHALL NOTIFY THE UTILITY PROTECTION CENTER (TOLL FREE PHONE NO. 1-800-752-4007 OR LOCAL NO. 502-266-5123) FORTY-EIGHT (48) HOURS IN ADVANCE OF ANY CONSTRUCTION ON THIS PROJECT. THIS NUMBER HAS BEEN ESTABLISHED TO PROVIDE ACQUAINTANCE OF EXISTING BELOW GROUND UTILITIES (I.E. CABLES, ELECTRIC WIRES, GAS & WATER LINES) WHEN CONTACTING THE KENTUCKY 811 CALL CENTER. PLEASE STATE THE WORK TO BE DONE IS FOR A UTILITY RECONSTRUCTION SET FORTH ON THE PLANS AND IN THE TECHNICAL SPECIFICATIONS & SPECIAL PROVISIONS.

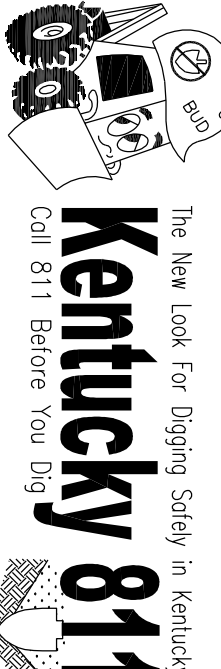

LEGEND

- 8" PVC TO BE CONSTRUCTED PER 5 AND PER MSD CONNECTION UNTIL THE CAPACITY CHARGE IS PAID PER MSD

SANITARY SEWER NOTES

- SANITARY SEWER MAIN PIPE MATERIAL SHALL BE SDR 35 PVC PIPE AS NOTED ON PLAN & PROFILE.
- MANHOLE AND PIPE MATERIAL INSTALLATIONS SHALL CONFORM TO THE STANDARDS OF THE MSD.
- CONTRACTOR SHALL PAY FOR ENGINEER'S TIME FOR SUBSEQUENT TESTS. THIS INCLUDES LOW PRESSURE AIR TEST, MANHOLE TEST, WANDERL TEST, AND TV SURVEY. THE DIVISION OF ENGINEERING AND DIVISION OF SANITARY SEWERS SHALL BE NOTIFIED 72 HOURS IN ADVANCE OF ANY TESTING.
- ALL SANITARY SEWER LATERAL LINES SHALL ALSO BE INSPECTED BY THE ENGINEER AND PLUMBING INSPECTOR PRIOR TO BACKFILLING OR COVERING OF THE PIPES.
- ALL SANITARY SEWERS SHALL BE PLACED IN 48" STONE BEDDING PER STANDARD DETAILS.
- AT ALL MANHOLE CONNECTIONS AND ALL OTHER POINTS OF CONNECTION, THE CONTRACTOR SHALL PROVIDE THE INSULATION OF THE SEWER SYSTEM. CONTRACTOR SHALL FURNISH DESIGN ENGINEER A CERTIFIED RECORD DRAWINGS REQUIRED BY STATE OR LOCAL AGENCY OF SANITARY LINES FOR PREPARATION OF AS-CONSTRUCTED RECORD DRAWINGS REQUIRED BY STATE OR LOCAL AGENCY.
- REQUIRED FIT UNDER SANITARY LINES SHALL BE COMPACTED TO 95% OF STANDARD PROCTOR MAXIMUM DENSITY.
- ALL LEAKS MANHOLES OR PENING DURING CONSTRUCTION OR INSPECTION SHALL BE CORRECTED BY THE CONTRACTOR.
- PVC PIPE MATERIALS AND JOINTS SHALL BE SDR 35 AND CONFORM TO ASTM D2034, OR LATEST REVISION.
- MANHOLE 18" MINIMUM CLEARANCE AT TOP OF WATER PIPES CROSSINGS WHERE PROSSIBLE.
- COORDINATE SANITARY SEWER SYSTEMS CONSTRUCTION WITH NEW WATER SERVICE, ELECTRIC LINES, TRANSDUCERS, ETC. TO PREVENT CONFLICTS.
- PROVIDE PROTECTIVE 12" BELOW ROUGH ON ALL UNDERGROUND UTILITIES.
- PROVIDE PROTECTIVE 12" BELOW ROUGH ON ALL UNDERGROUND UTILITIES.
- VISIBLE LEAKS IN MANHOLES OBSERVED DURING CONSTRUCTION OR INSPECTION SHALL BE CORRECTED BY THE CONTRACTOR.
- CONTRACTOR SHALL HEAVILY SWOOL AND REMOVE EXISTING PAVEMENT AS NECESSARY. THE TRENCH AND ALL PAVEMENT SHALL BE RETURNED AS DESCRIBED IN SITE DETAILS.

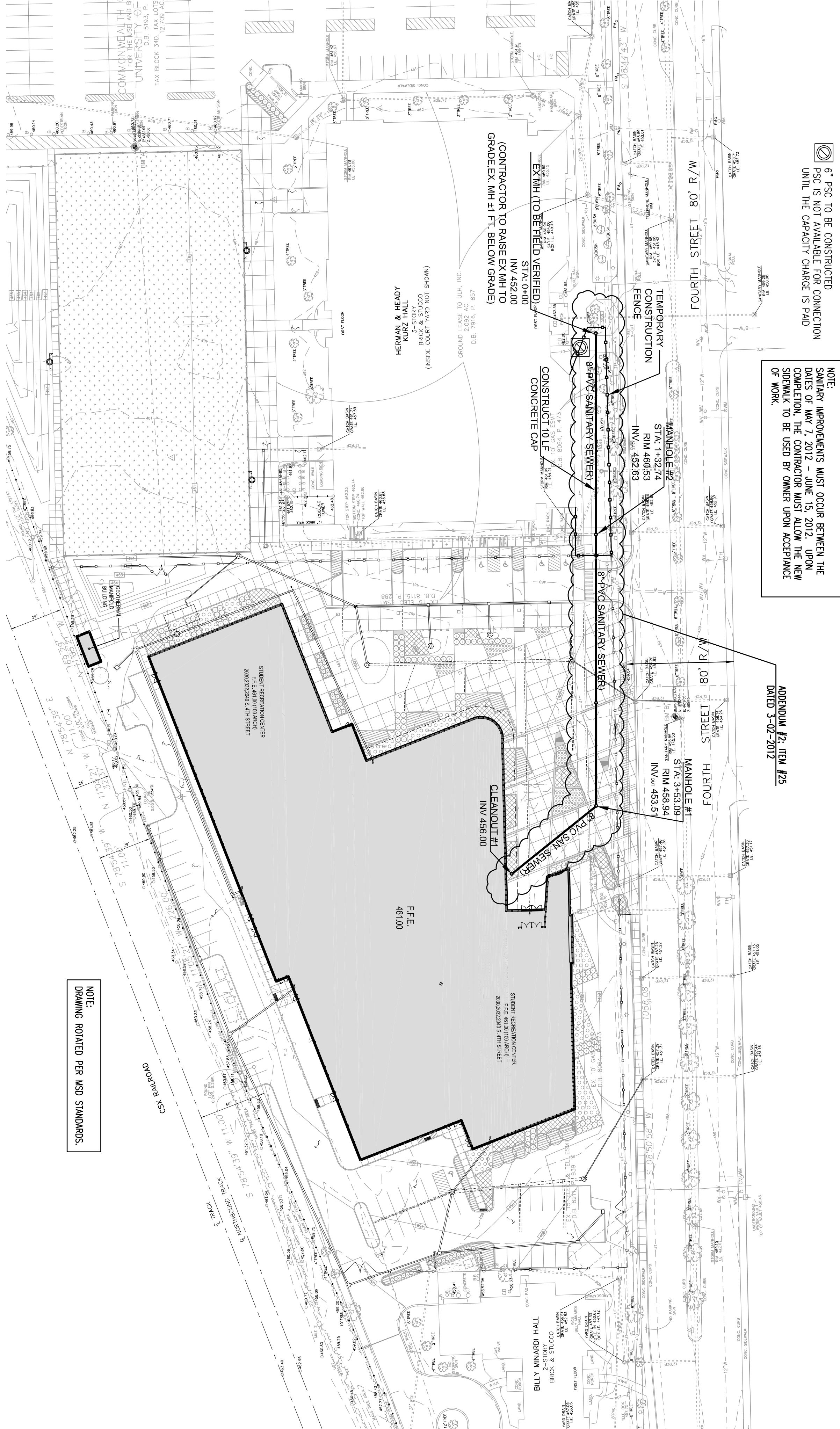

PRIVATE SANITARY PLAN

SCALE: 1"=30'-0"

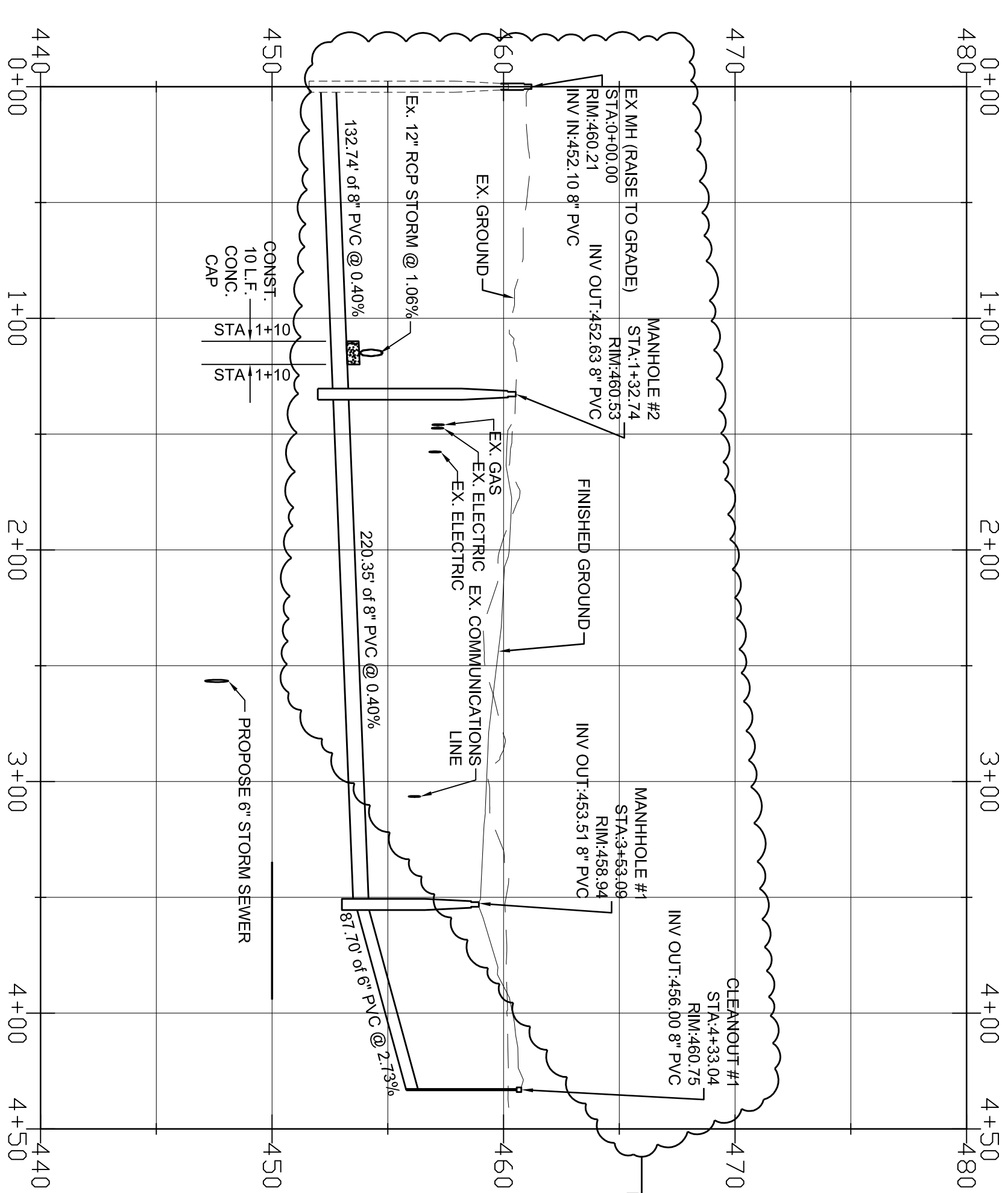
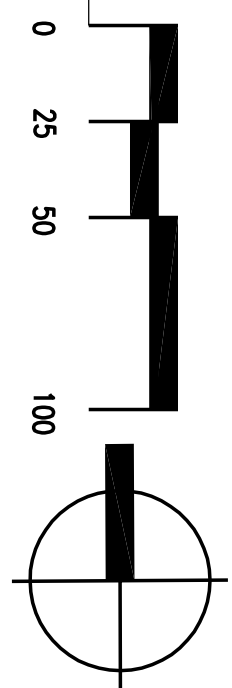

PRIVATE SANITARY PROFILE

SCALE: HORIZ: 1"=40'-0"
VERT: 1"=3'-0"
APPROVAL #2, REV 1/2
DATE: 3-02-2012

Consolidated Addenda 3-11-12

100 % CD's

University of Louisville - Student Recreational Facility (Bid Phase #4)

Louisville, Ky

Drawing Name / Description	#	Revision	Date
U of L Project Number:	1		
A&E Project Number:	2		
Date:	3		JANUARY, 2012
Drawn By:	4		SDS
Checked By:	5		JLC / KLW

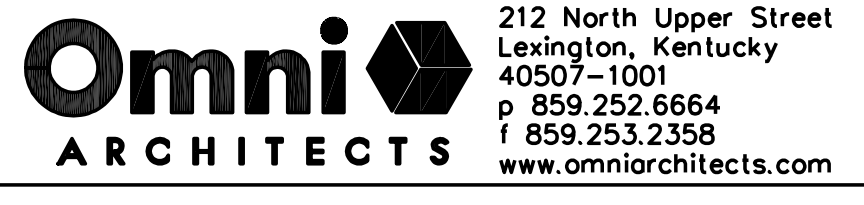

SD-8.3

FOR LOCATION OF UNDERGROUND UTILITIES, CALL B.U.D. 1-502-286-6123 (2) WORKING DAYS IN ADVANCE OF DIGGING

PURPOSE OF THESE DRAWINGS IS TO REFLECT ALL CHANGES AND CLARIFICATIONS MADE THRU PREVIOUSLY ISSUED ADDENDA. CONTRACTOR IS RESPONSIBLE FOR ADHERENCE TO IMPROVEMENTS REFLECTED IN THE CONTRACT BIDS AND SPECIFICATIONS.