

BROWNING DAY MULLINS DIERDORF ARCHITECTS

Browning Day Mullins Dierdorf Architects
Architecture
Landscape Architecture
Planning

334 North Senate Avenue
Indianapolis, Indiana 46204
P: 317.685.5030
F: 317.634.5409
E-Mail: jindistad@bdmd.com

Circle Design Group, Inc.
Mechanical Electrical Plumbing Engineers

5510 South East Street, Suite F
Indianapolis, Indiana 46227
P: 317.781.6000
F: 317.574.8201
E-Mail: kerry@circledesigngroup.com

Lawson Elser Engineering Consultants
Structural Engineers

650 East Carmel Drive, Suite 150
Carmel, Indiana 46032
P: 317.574.9409
F: 317.574.9431
E-Mail: mlawson@lawsonelser.com

Skees Engineering, Inc.
Civil Engineers

400 Blankenbaker Parkway, Suite 300
Louisville, KY 40243
P: 502.254.2344
F: 502.254.3008
E-Mail: dmckinnon@skees.com

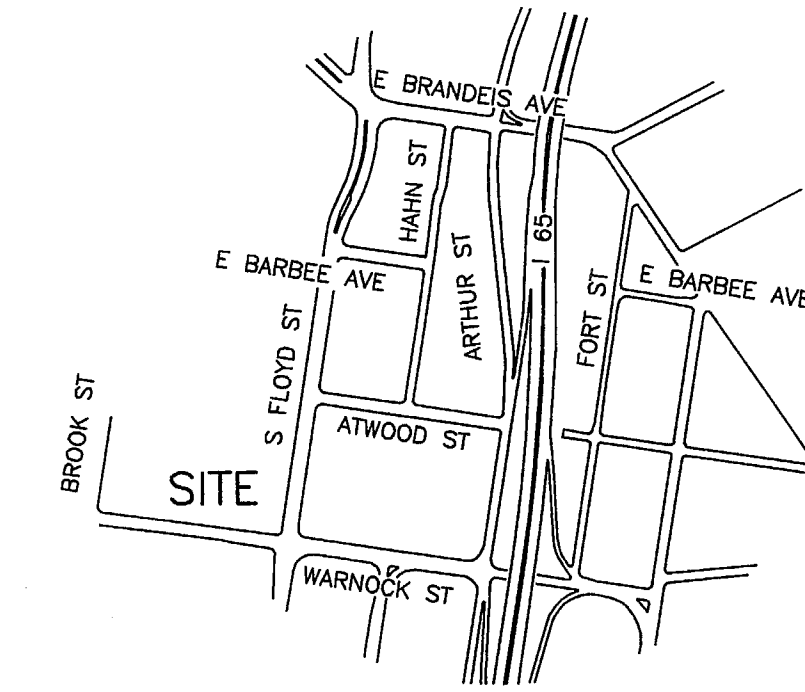

LOCATION MAP
NO SCALE

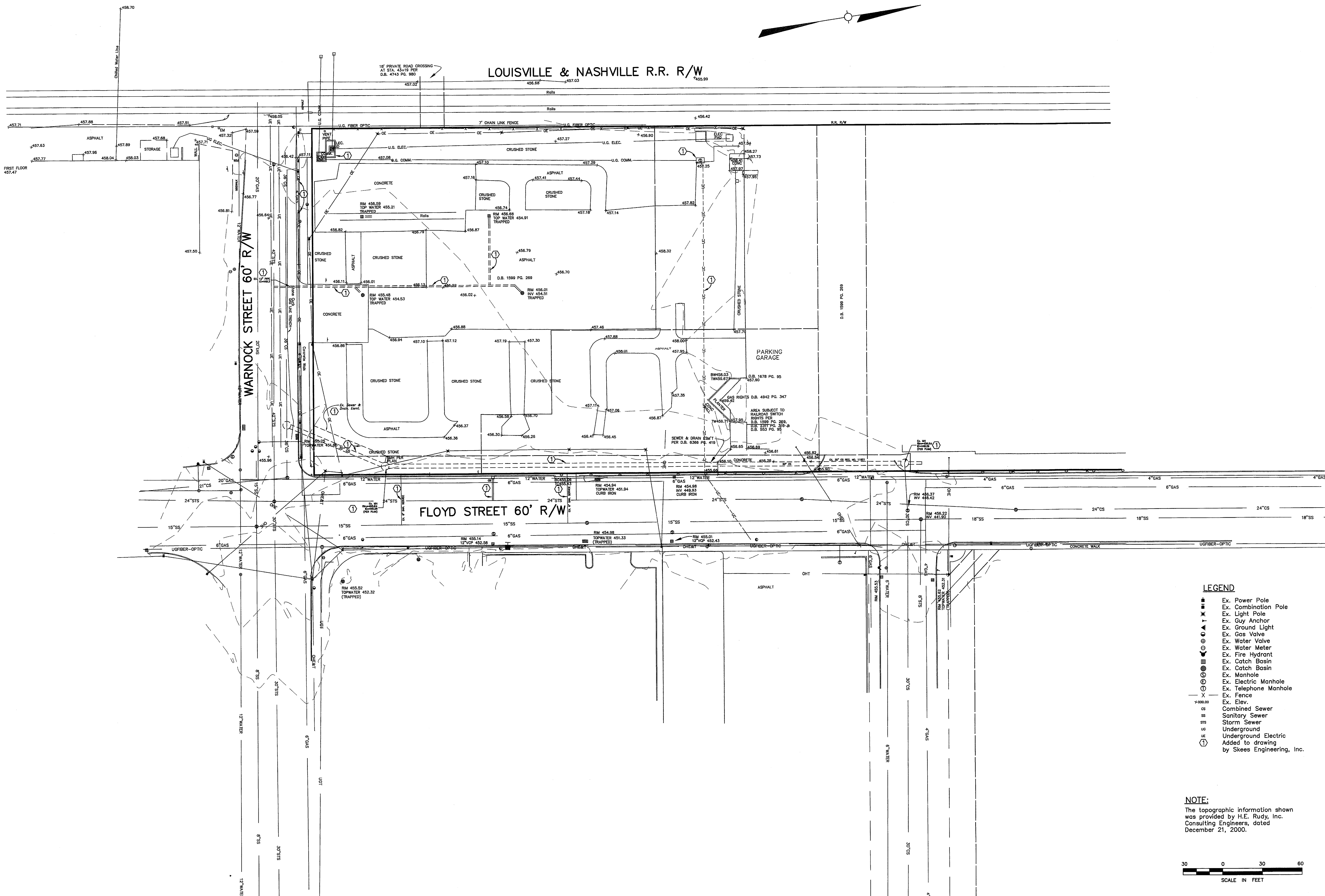

LEGEND

- Ex. Power Pole
- Ex. Combination Pole
- Ex. Light Pole
- ▲ Ex. Guy Anchor
- Ex. Ground Light
- Ex. Gas Valve
- Ex. Water Valve
- Ex. Water Meter
- Ex. Fire Hydrant
- Ex. Catch Basin
- Ex. Catch Basin
- Ex. Manhole
- Ex. Electric Manhole
- Ex. Telephone Manhole
- Ex. Fence
- Ex. Elev.
- Combined Sewer
- Sanitary Sewer
- Storm Sewer
- Underground
- Underground Electric
- Ⓢ Added to drawing by Skees Engineering, Inc.

NOTE:
The topographic information shown was provided by H.E. Rudy, Inc. Consulting Engineers, dated December 21, 2000.

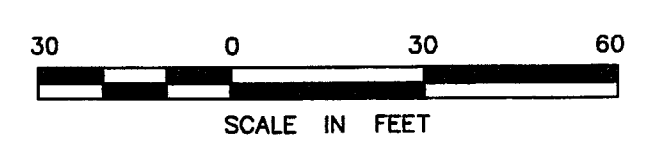

CERTIFICATION
CONSTRUCTION DOCUMENTS

CARDINAL PARK NATATORIUM

UNIVERSITY OF LOUISVILLE

Project: 03006
Drawn: BDH
Checked: DPM
Scale: 1"=30'
Issue Date: AUGUST 27, 2003
Revision:

EXISTING SITE SURVEY

C1.00