

UNIVERSITY LOFTS - Renovate Academic Facility UK School of Art & Visual Studies

SECOND FLOOR PLAN RCP



PHASE 3 - CONSTRUCTION DOCUMENTS
50% REVIEW SUBMITTAL

A-6.2

NOT FOR CONSTRUCTION Job Number: 1205 Date: 05/2013

Drawn By: Author Checked By: Checker

Revision:

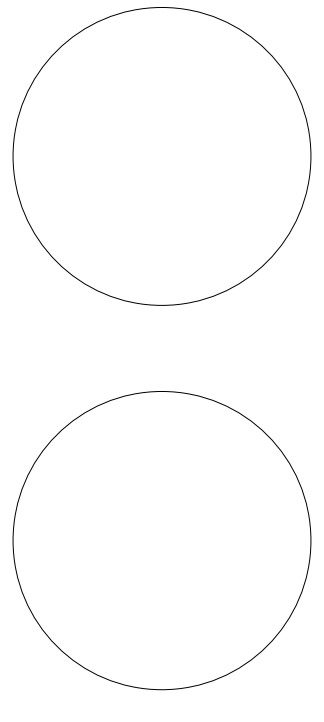

This Drawing and the Design shown thereon are the property of Omni Architects. The reproduction, copying or other use of this drawing without the written consent of Omni Architects is prohibited.

REFLECTED CEILING PLAN LEGEND

NOTES
REFER TO M.E.P. DRAWINGS FOR EXACT QTY. AND LOCATION OF MECH., ELEC., AND FIRE PROTECTION WORK. PROVIDE SLOTTED CHANNEL FRAMING SUPPORTS FOR CEILING MOUNTED ITEMS, TYPICAL.

FULL HEIGHT DRYWALL (NON-RATED) SMOKE TIGHT	-----	HIGH VOLUME FAN	
ONE HOUR RATING	----	WALL MOUNTED LIGHT FIXTURE	
NEW GYPSUM BOARD CEILING / SOFFIT		WALL MOUNTED EXIT LIGHT FIXTURE	
EXISTING GYPSUM BOARD CEILING / SOFFIT		CEILING MOUNTED EXIT LIGHT FIXTURE	
2x2 ACOUSTIC PANEL CEILING		2x2 RETURN AIR GRILL	
ROLLER SHADE		1x1 RETURN AIR GRILL	
PENDANT MOUNT FLUORESCENT LIGHT FIXTURE		2x2 SUPPLY DIFFUSER	
2x2 RECESSED FLUORESCENT LIGHT FIXTURE		1x1 SUPPLY DIFFUSER	
2x4 RECESSED FLUORESCENT LIGHT FIXTURE		ACOUSTICAL CEILING MOUNTED POWER DROP. SEE ELECTRICAL DWGS.	
RECESSED DOWNLIGHT		TRACK LIGHT	
LINEAR FLUORESCENT LIGHT FIXTURE (IN GRID & PENDANT MOUNT)		WALL WASHER	
1x4 SURFACE MOUNTED FLUORESCENT LIGHT FIXTURE		GENERAL NOTES	
4' SURFACE MOUNTED STRIP LIGHT FIXTURE		1. SEE A-1.0 FOR ACCESSORY SCHEDULE.	
COVE LIGHT		2. CLEAN, REPAIR, PREPARE, AND PAINT ALL GYPSUM BOARD SOFFIT AND CEILING SURFACES.	
PENDANT WALL WASH		3. CEILING AND SOFFIT SURFACES MAY BE PAINTED A DIFFERENT COLOR THAN ADJACENT WALL COLOR.	
		4. VERIFY EXISTING SUBSTRATES ARE DRY AND FREE FROM LEAKS BEFORE REPAIRING GYPSUM BOARD SURFACES OR INSTALLING NEW CEILING FINISHES. NOTIFY ARCHITECT IF LEAKS, OR WET SURFACES ARE DISCOVERED.	
		5. ALL WALLS ARE FULL HEIGHT EXCEPT AS NOTED OTHERWISE.	
		6. SEE MECHANICAL, ELECTRICAL AND PLUMBING SHEETS FOR ALL MEP ITEMS. ALL MEP ITEMS SHOWN ON THE REFLECTED CEILING PLANS ARE FOR REFERENCE ONLY AND SHOULD NOT BE USED FOR CONSTRUCTION.	

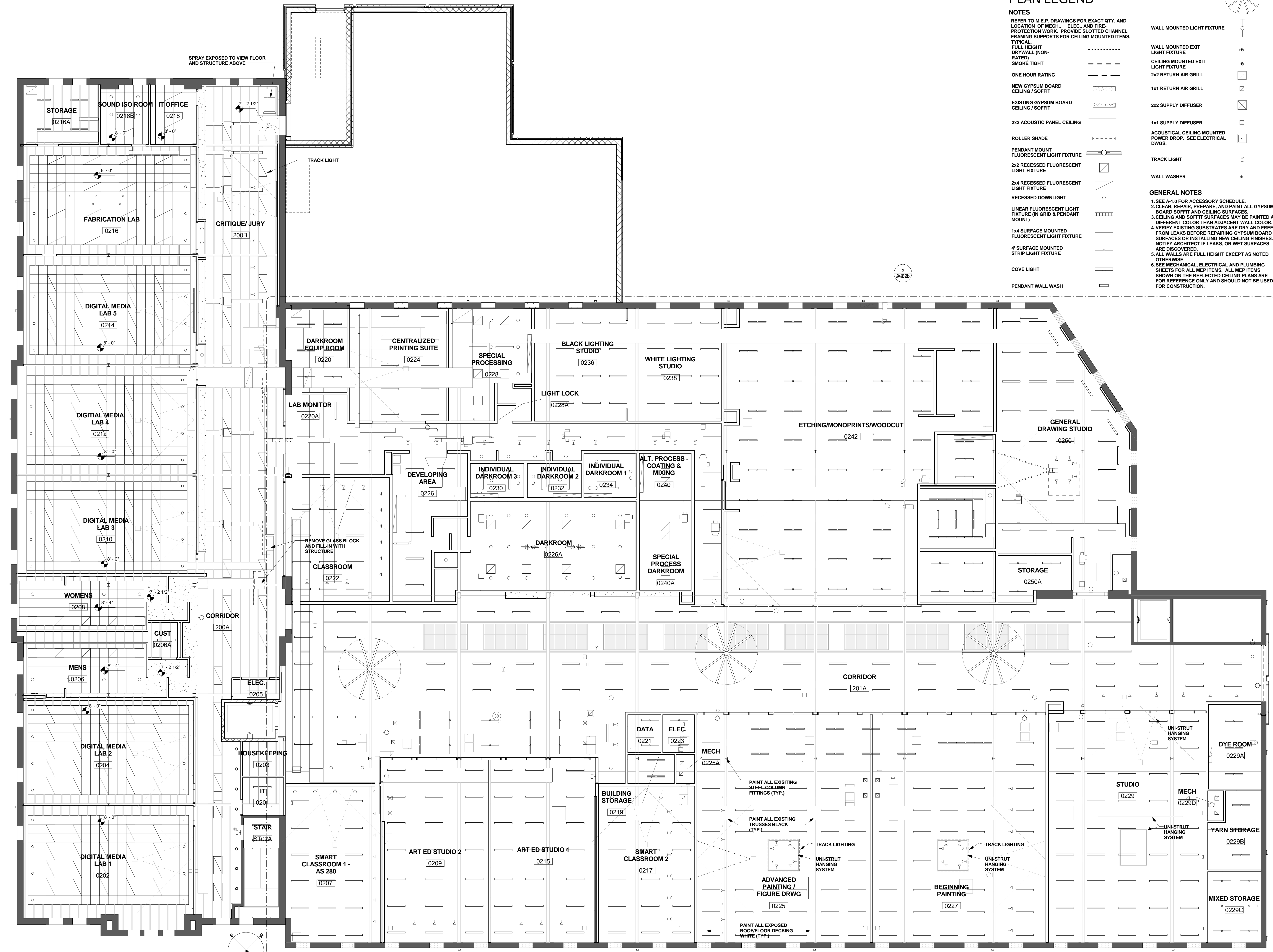

1 2ND LEVEL REFLECTED CEILING PLAN
A-6.2 1/8" = 1'-0"
0 20' 40' 60'