

IceTray® Curved Wall Direct Direct T8

Type:

Project:

SPECIFICATIONS

Wall Mount

ICDW8

LAMPING OPTIONS

☐ CDW8 - 1 Wall Mount

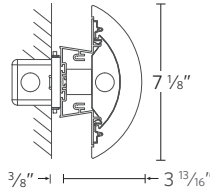

SPECIFICATIONS

Construction

Nominal 4" x 7" with extruded aluminum spine and nominal four 4' one-piece aluminum baffle assemblies. Steel and die-cast aluminum sculptured end cap.

Reflectors

White painted center reflector (nominal 90% reflectance).

Shielding

Straight blade baffles with intermediate brightness opal acrylic diffuser overlay.

Finish

Satin anodized or white polyester powder paint. Satin anodized finish consists of satin anodized housing, clear-coated aluminum baffles and end caps painted C110 to match. Note that clear coated aluminum baffles retain the slight imperfections and characteristics of the raw aluminum source material. Custom colors available, consult factory.

Electrical

Specify 120V, 277V or 347V. Pre-wired with 16AWG fixture wires. For special circuiting or wire gauge, consult factory. Plug-in electrical connectors included. UL and C-UL listed.

Luminaire Length

4', 8', and 12' lengths in a single section for exact suspension spacing of 4', 8' and 12'. For total luminaire length, add 1 3/8" for each end cap. Using internal joiners 4', 8', and 12' sections can be joined to form longer rows. Individual 2' and 3' units also available, consult factory

CATALOG NUMBER

Examples: ICDW8 1 32 OPI 40FT R12 277 GEB10 SCT LP835 C100 — ICDW8 1 32 OPI 32FT R8 277 GEB10 1SE EL SCT LP835 CO41

Luminaire	# of Lamps in Cross Section	Lamp Type	Shielding	Luminaire Row Length	Maximum Section Length	Voltage	Ballast Type	# of Emergency Modules
ICDW8	1	32 32W T8	OPI Intermediate brightness opal diffuser OPD Standard brightness opal diffuser	X FT (4' increments)	R4 4' section(s) R8 8' section(s) R12 12' section(s)	120 277 347	GEB10 <10% THD Electronic ADEZ ¹ Advance Mark 10 dim DMHL3D ¹ Lutron Hi-Lume dim OSSC Osram Line or 0-10V <i>Reference Ballast Wizard on website or consult factory for other options.</i>	(Blank) None 1SE 1 section 2SE 2 sections XSE X sections

Emergency Type ²	Switching	Lamp Color	Finish	Options
(Blank) None EC Emergency circuit EL ¹ Emergency battery pack EN ¹ Emergency battery pack w/night light circuit	SCT Single circuit	L/LP No lamp L/LPE No lamp. Wired for energy saving lamps. LP830 3000K 80+ CRI LP835 3500K 80+ CRI LP841 4100K 80+ CRI <i>Reference Lamp Chart on website or consult factory for other options.</i>	C041 White white (low gloss) C100 Satin anodized finish C099 Custom finish	DL Damp location label ELH Emergency through wiring w/separate feed ELS Emergency through wiring w/single feed, shared neutral ELS2 Emergency through wiring w/single feed, separate neutrals GLR Fusing (fast blow) GMF Fusing (slow blow) NYC New York City code

Notes:

¹ Not available in 347V

² Emergency type is installed in last 4' of luminaire sections.

Separate feed required unless ELS or ELS2 is specified

2246 5th Street, Berkeley, CA 94710 • Tel: 510.845.2760 • Fax: 510.845.2776 • Email: techsupport@peerlesslighting.com • PeerlessLighting.com

IceTray® Curved Wall Direct Direct T8

Type:

Project:

Wall Mount

ICDW8

MOUNTING DETAIL

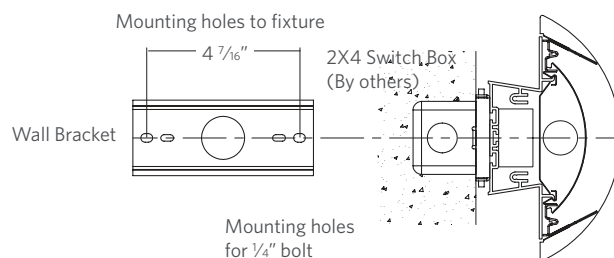

WEIGHTS & SUPPORT SPACING

Suspension spacing equals section length. Consult factory for stem mounting suspension spacing.

STANDARD SECTIONS

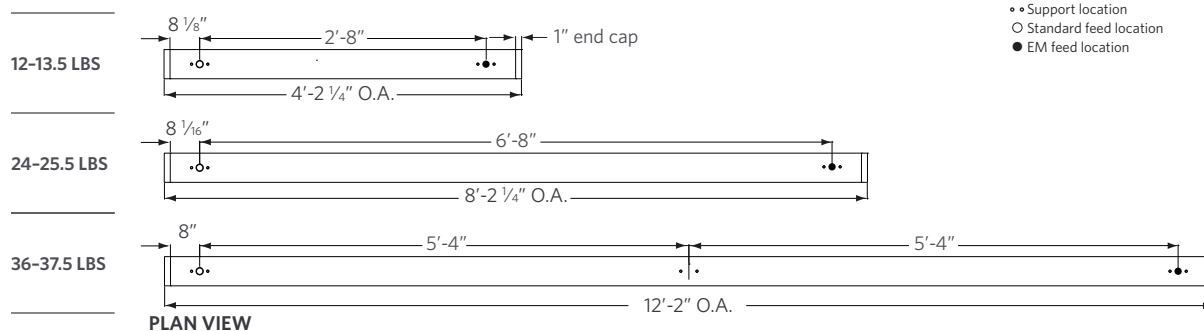

CONFIGURATIONS



Tenon inside, outside "L" and straight connectors available for suspended configurations. Reference [Pattern Connector Guide](#) for additional details.

PHOTOMETRICS

Actual performance may differ as a result of end-user environment and application.

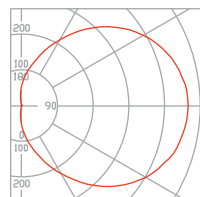

1-LAMP T8 OPI
 42.7% efficiency
 1216 delivered lumens
 50.1% up / 49.9% down