

Darkroom Safelites

SURFACE

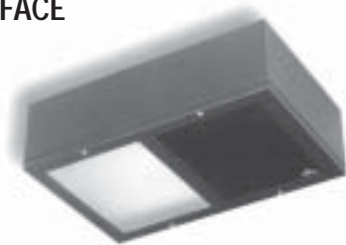

Shown with Distributing Lens -DL
in one compartment

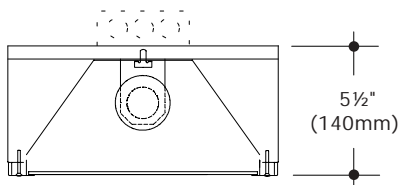

Description

Darkroom Safelites are task lighting fixtures required wherever photographic or X-ray film processing is performed. Filters must be selected to meet the requirements of the particular type of film that will be exposed to the light. Multiple-compartment fixtures allow safe processing of different types of film. Stainless steel construction for exposed surfaces is available for rooms with a corrosive atmosphere.

Construction

- Housing and trim are 20 gauge steel
- Standard finish on surface models and trim of recessed models is black enamel
- Recessed housing has white polyester coating
- Trim is fully gasketed to insure light-tight compartments
- Plaster frame with attached junction box is provided for recessed models
- One 8" x 10" Eastman Kodak filter is provided for each compartment
- UL/cUL listed

Electrical

- Wired for one medium base 120V incandescent lamp in each compartment
- Each compartment is to be individually switched
- Lamps over 15W are not recommended in filter compartments
- 75W maximum in distributing lens compartment in surface models
- Maximum lamp wattage in recessed models varies with ceiling condition

To Specify

- Select catalog number.
- Add filter number and/or -DL for each compartment of model selected. Refer to filter data on back of this page.
- For recessed models, add appropriate suffix (-T or -IC) for ceiling condition.
- Add suffixes for options required to meet job conditions.



C. W. Cole & Company, Inc.
2560 N. Rosemead Boulevard
South El Monte, CA 91733-1593

Fax (626) 443-9253
Tel. (626) 443-2473
info@colelighting.com
www.colelighting.com

Catalog Numbers	Configuration	Dimensions
PH810-S-*		11 3/4" x 9 3/4" (299mm x 248mm)
PH810-2S-**-*		11 3/4" x 18 1/4" (299mm x 464mm)
PH810-3S-***-*		11 3/4" x 27 3/8" (299mm x 695mm)
PH810-4S-****-*		11 3/4" x 35 5/8" (299mm x 905mm)
PH810-S4S-****-*		18 1/4" x 22 1/2" (464mm x 572mm)

* Specify -DL and/or required filter Feed location shown

RECESSED



Shown with Distributing Lens -DL
in one compartment

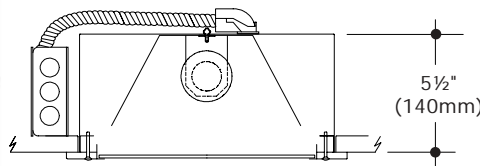

Catalog Numbers	Configuration	Dimensions inches (millimeters)	
		Housing	Trim
PH810-PB-*-†		11 3/4" x 9 3/4" (299 x 248)	13" x 10 7/8" (330 x 276)
PH810-2PB-**-†		11 3/4" x 18 1/4" (299 x 464)	13" x 19 1/2" (330 x 495)
PH810-3PB-***-†		11 3/4" x 27 3/8" (299 x 695)	13" x 28 5/8" (330 x 727)
PH810-4PB-****-†		11 3/4" x 35 5/8" (299 x 905)	13" x 36 7/8" (330 x 937)
PH810-4SPB-****-†		18 1/4" x 22 1/2" (464 x 572)	19 1/2" x 22 1/2" (495 x 572)

* Specify -DL and/or required filter Junction box location shown

† Specify Ceiling Condition

- T Non-insulated. 200W maximum lamp in distributing lens compartment. Thermal protection provided.
- IC Insulated. 40W maximum lamp in distributing lens compartment.

Options

Stainless Steel: Provides stainless steel housing and trim for surface models; trim for recessed models. Add suffix -N.

Distributing Lens: Clear prismatic lens in one compartment for general illumination. Add suffix -DL.

Larger Size: Fixtures with 10 x 12 filters. Dimensions are proportionately larger. Substitute **1012** for **810** in catalog number.

Darkroom Safelites \ Warning Signs

WALL

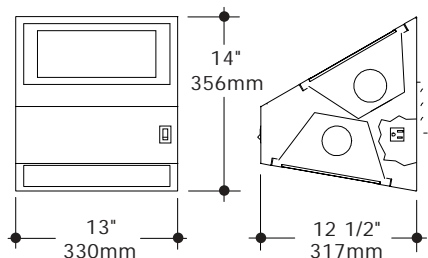

Shown with optional Rocker Switch -SW and Convenience Outlet -CO

Catalog Number

PHB-810-(filter number)

Options

Convenience Outlet: Add suffix -CO.

Rocker Switch: 3-way (up/off/down). Add suffix -SW.

WARNING SIGNS

See complete line in Directional Signs section.

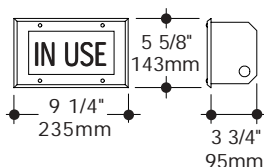

Catalog Number

S252-IN USE

Construction: 18 gauge steel, aluminum paint. Red letters on white.

Electrical: One 25W A19 medium base incandescent

Mounting: Recessed housing has flanges with holes for mounting.

Options

Stainless steel faceplate: Add suffix -N.

Fluorescent: One 7W (G23 base) compact fluorescent. 120V standard. Add suffix -F.



Catalog Number

S193-DARKROOM IN USE

Construction: Extruded and formed aluminum, satin finish with clear anodize. Red letters on white.

Electrical: Two 25W T6½ intermediate base incand.

Mounting: Surface housing mounts to junction box

Options

Bracket Mounting: Ceiling: -C; End: -LE or -RE.

Recessed Mounting: Specify S191.

Fluorescent: Two 7W (G23 base) compact fluorescent. 120V standard. Add suffix -F.

Darkroom Safelites

Specifications

Construction

- Fixture is 20 gauge steel with black enamel finish
- Diffuser in general illumination uplite compartment is clear prismatic glass
- 8" x 10" Eastman Kodak filter is provided in downlite compartment
- UL/cUL listed

Electrical

- Uplite is wired for one 150W incandescent lamp
- Downlite filter compartment is wired for one 15W incandescent lamp
- Each compartment is to be individually switched
- 120V only

Mounting

- Fixture mounts to recessed junction box in wall.



Catalog Number

S130A-A14

Construction: Die-cast and extruded aluminum with white polyester coating. Red letters on white.

Electrical: Two 25W T6½ intermediate base incand.

Mounting: Surface housing mounts to junction box

Options

Bracket Mounting: Ceiling: -C; End: -LE or -RE.

Fluorescent: Two 7W (G23 base) compact fluorescent. 120V standard. Add suffix -F.

Eastman Kodak Safelight Filters

Number	Color	Material Usage
OA	Greenish Yellow	Black-and-white contact and duplicating materials and projection films
OC	Light Amber	Contact and enlarging papers
1	Red	Blue-sensitive materials and most photo-typesetting materials
1A	Light Red	Slow orthochromatic materials
2	Dark Red	Fast orthochromatic materials, green-sensitive x-ray films
3	Dark Green	Some panchromatic materials
6B	Brown	Blue-sensitive x-ray films
8	Dark Yellow	Color print and color intermediate motion picture films
10	Dark Amber	Color negative papers, materials, panchromatic black-and-white papers
13	Amber	Color negative papers, panchromatic black-and-white papers
GBX		Most blue-sensitive x-ray films, most green-sensitive medical x-ray films



C. W. Cole & Company, Inc.
2560 N. Rosemead Boulevard
South El Monte, CA 91733-1593

Fax (626) 443-9253
Tel. (626) 443-2473
info@colelighting.com