

**2 ENLARGED ELEVATOR #2 & #3 PLAN**

1/2" = 1'-0"

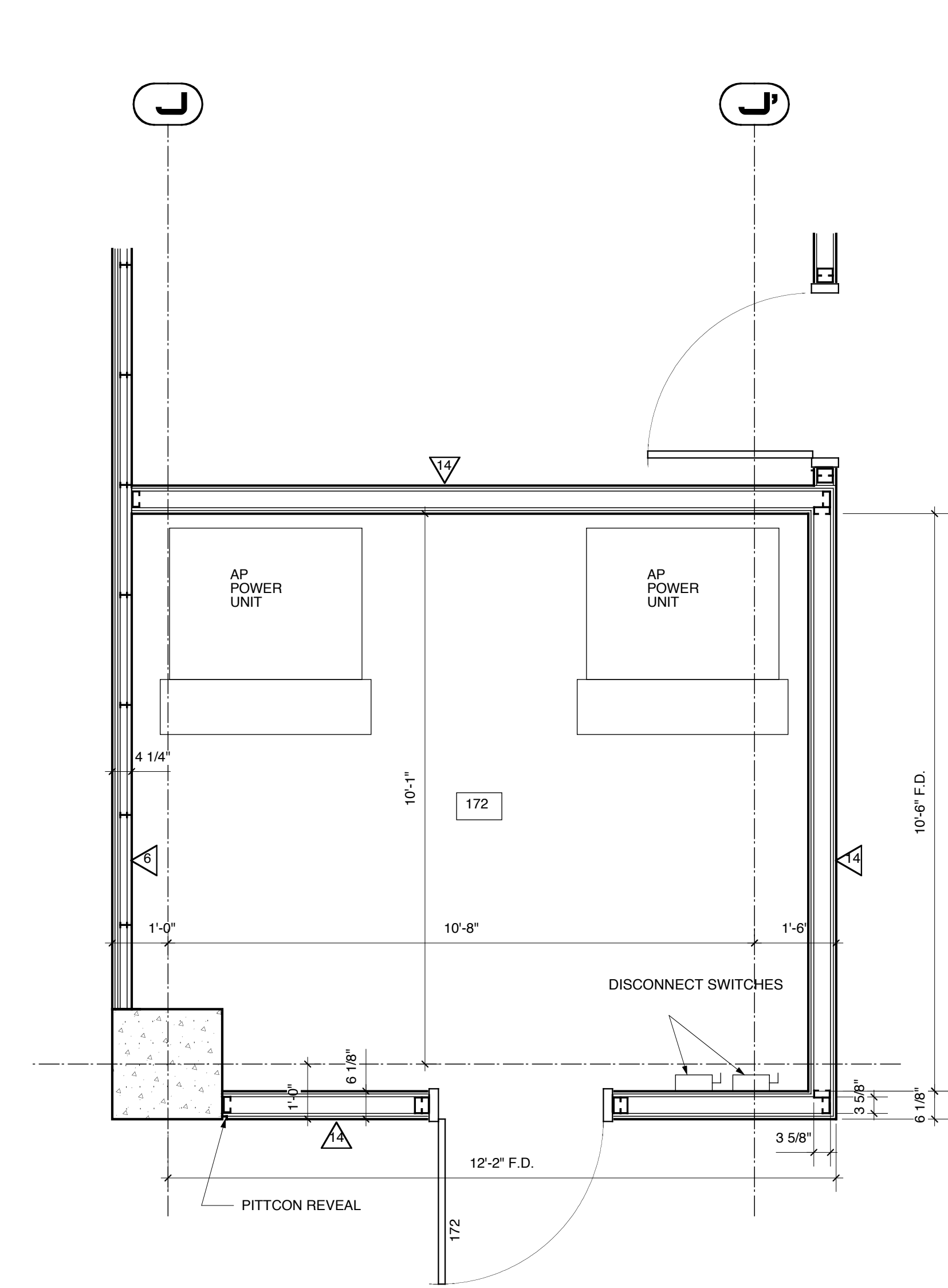

**3 ENLARGED PLAN- ELEVATOR EQUIPMENT**

1/2" = 1'-0"

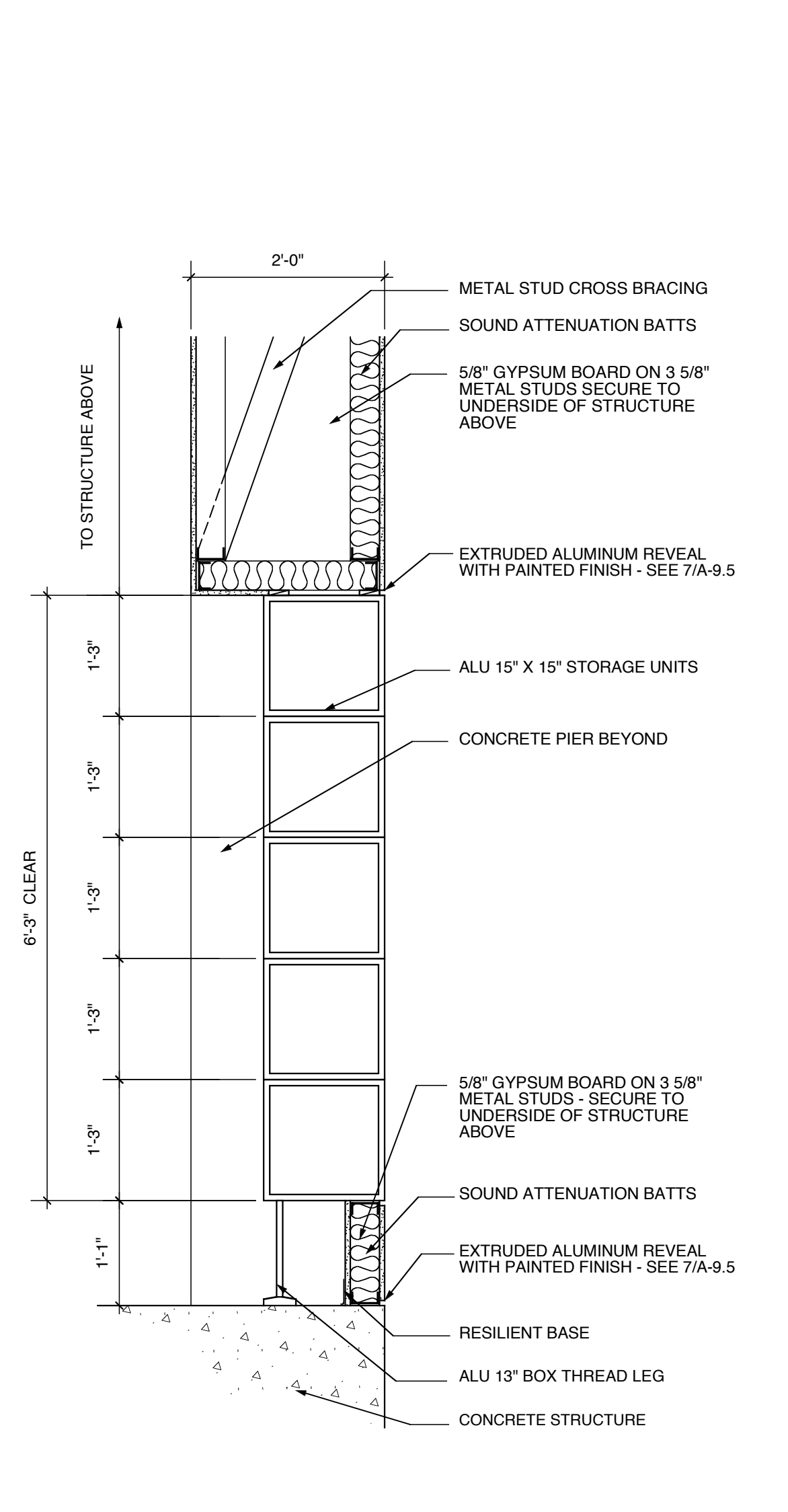

**4 CASEWORK DETAIL**

3/4" = 1'-0"

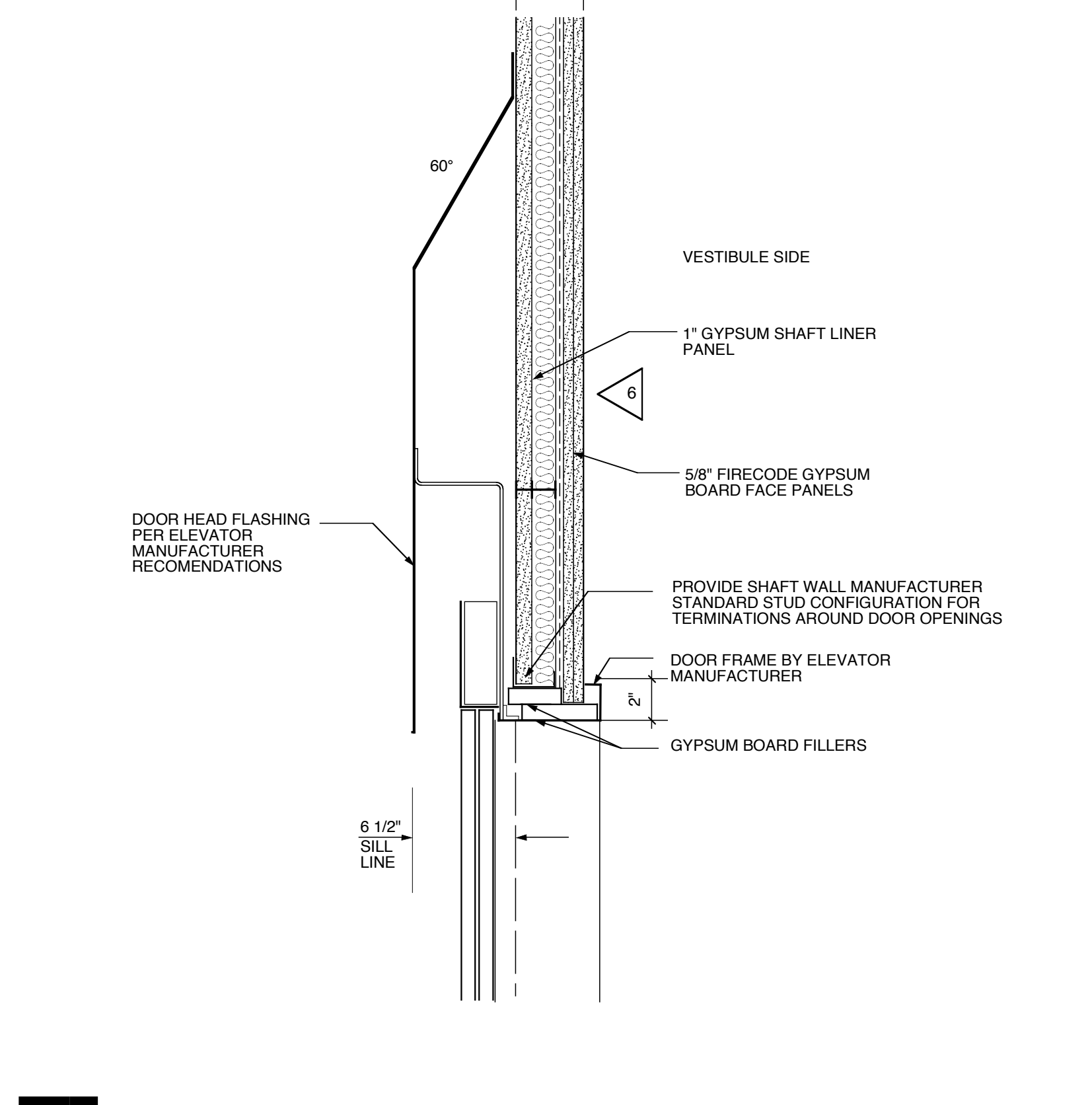

**5 TWO SPEED HEAD DETAIL**

1 1/2" = 1'-0"

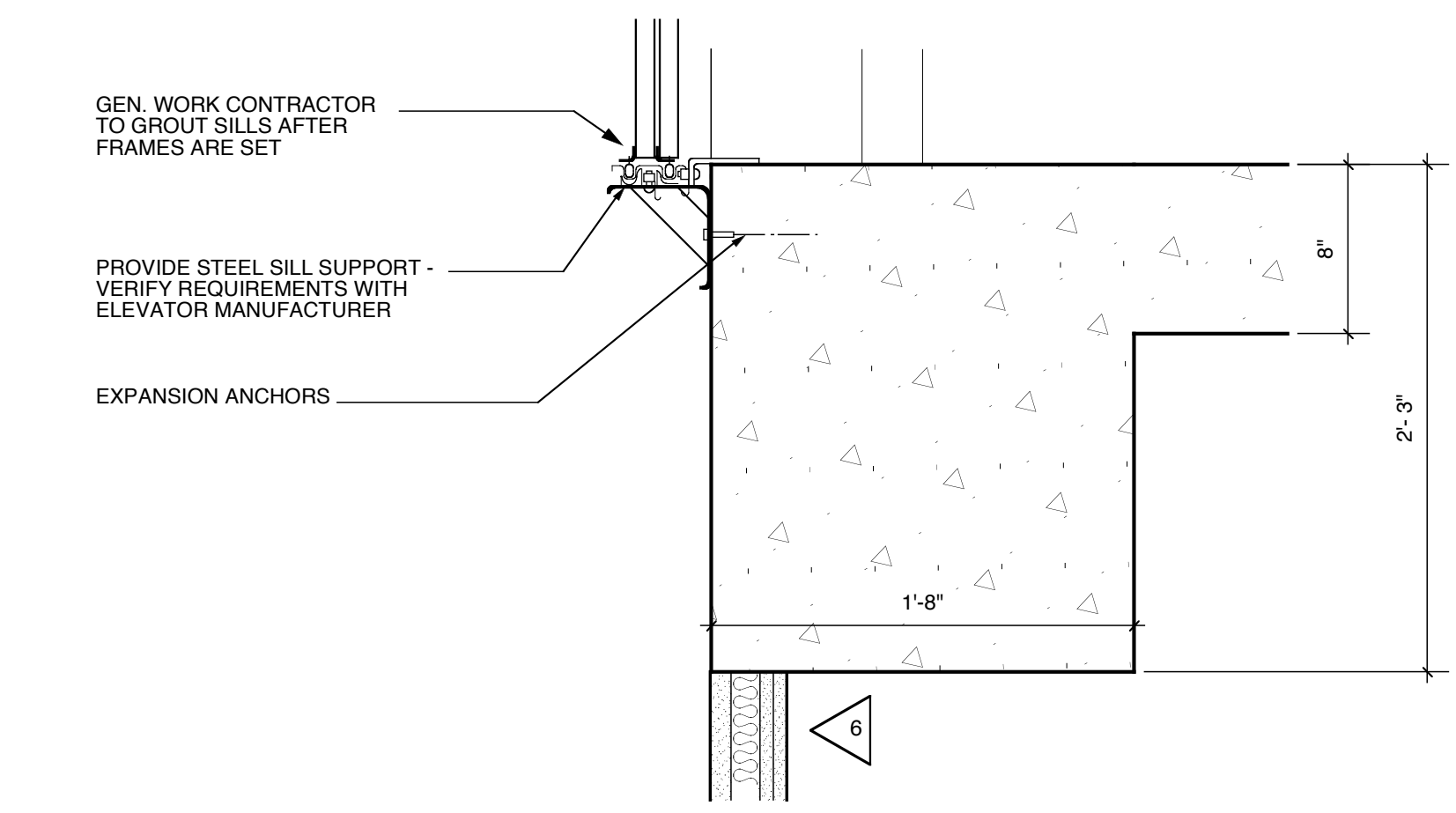

**6 TWO SPEED SILL SUPPORT @ 2nd,3rd,4th FLOOR**

1 1/2" = 1'-0"

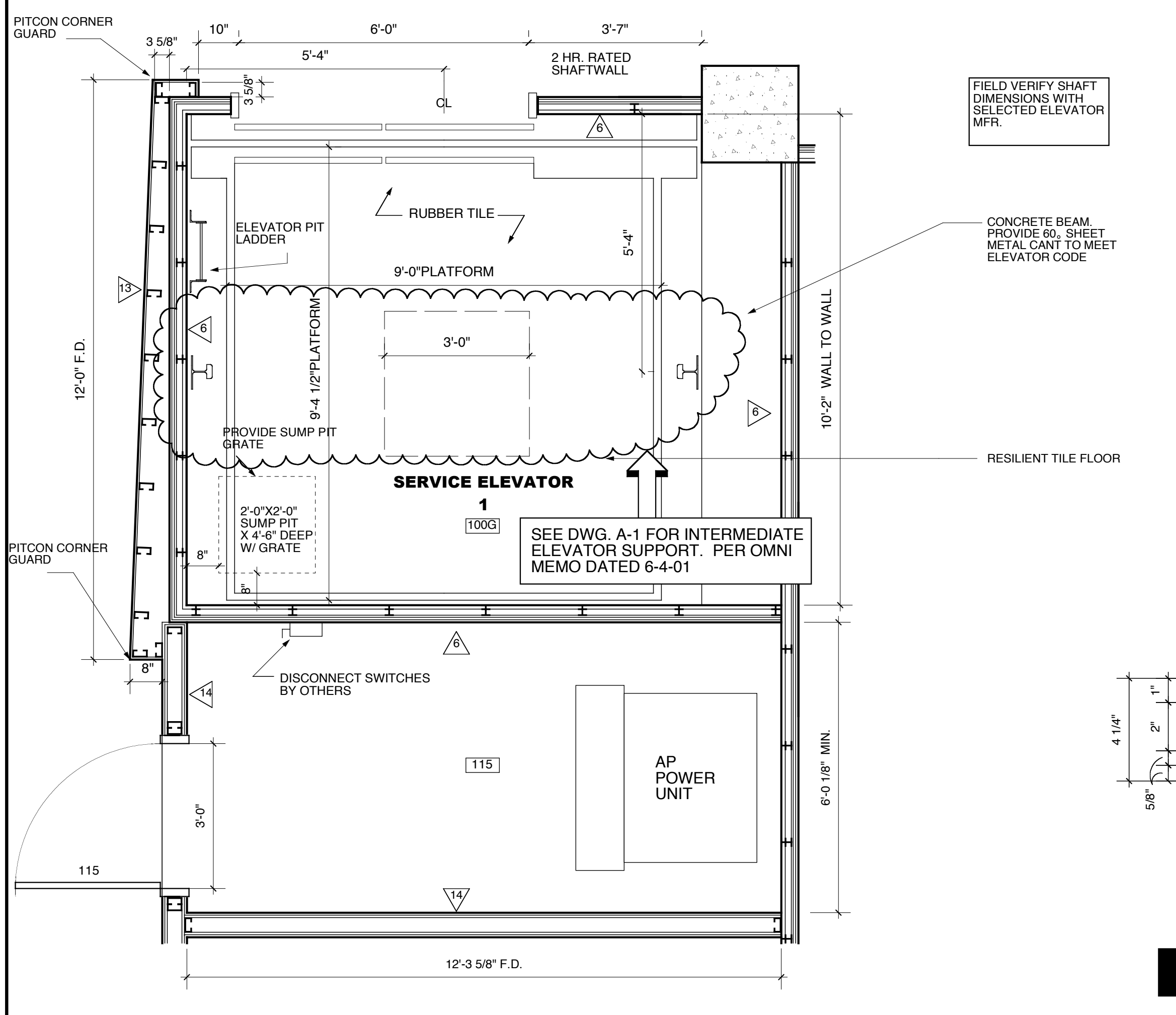

**1 ENLARGED ELEVATOR #1 PLAN W/ EQUIPMENT ROOM**

1/2" = 1'-0"

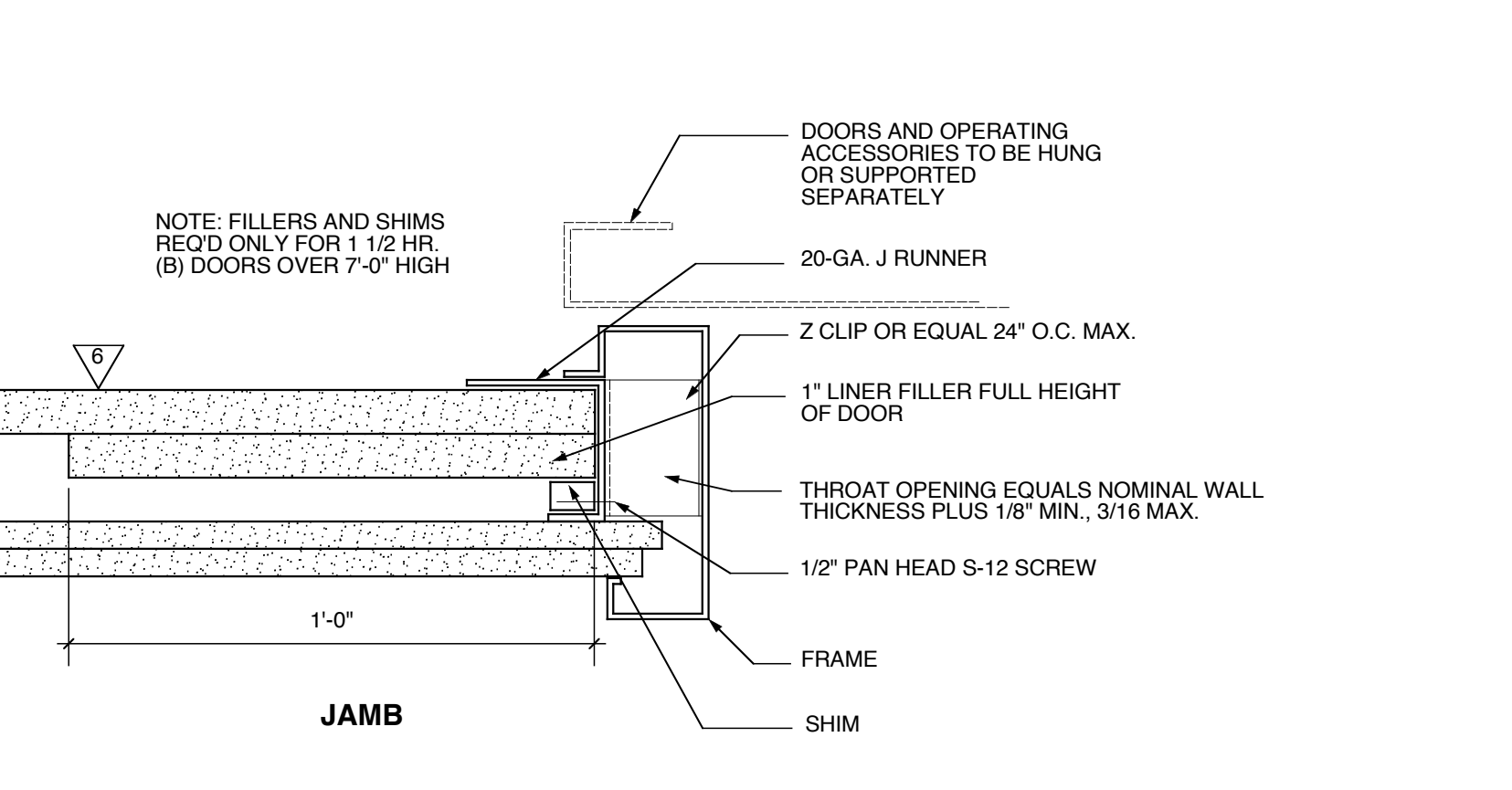

**4 ELEVATOR DOOR FRAMES**

3" = 1'-0"

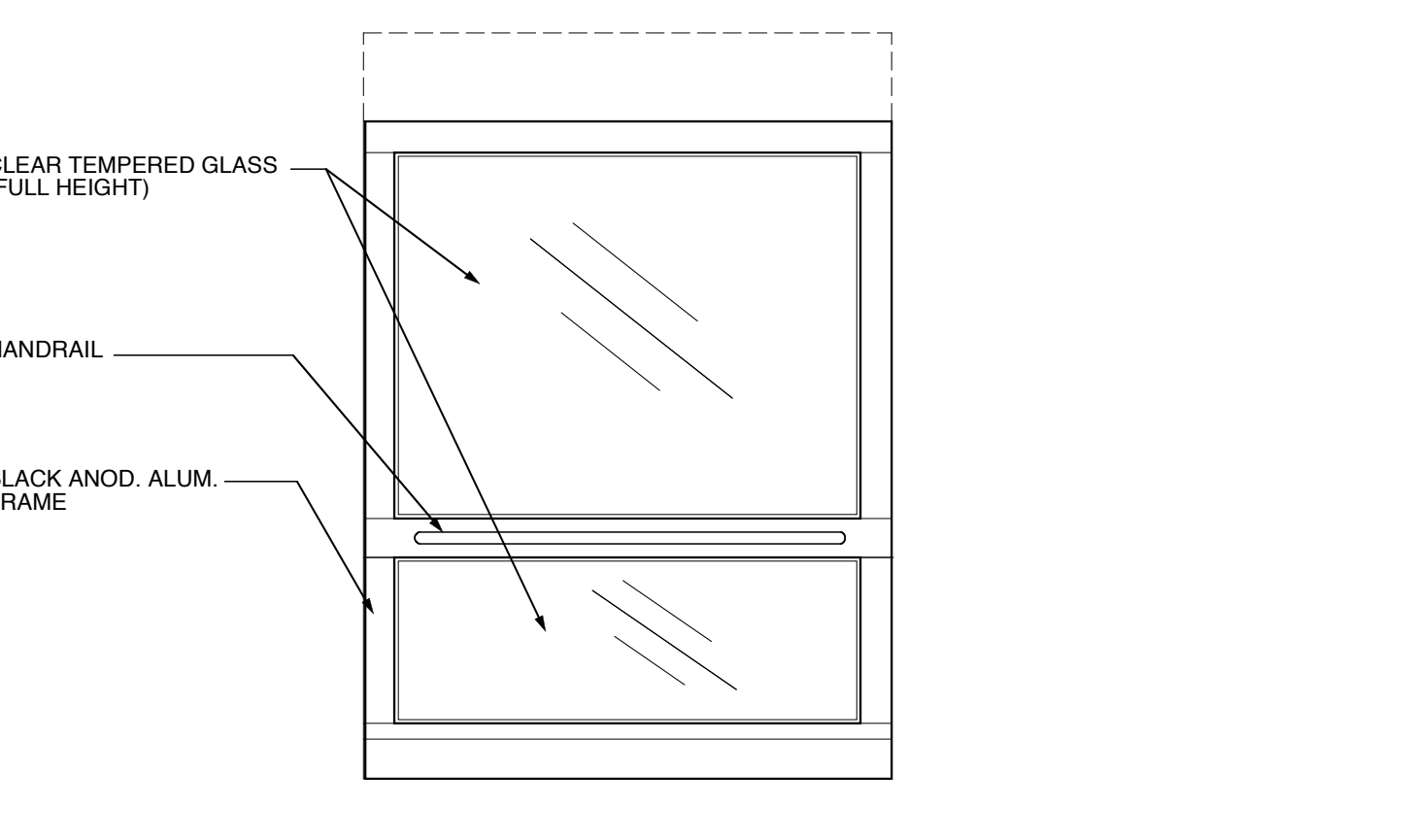

**5 GLASSBACK ELEVATOR CAR**

1/2" = 1'-0"

**RECORD DOCUMENTS**  
 These Record Documents have been prepared based on information provided by others. The Consultant has not verified the accuracy and/or completeness of this information and shall not be responsible for any errors or omissions that may be incorporated as a result of erroneous information provided by others.

**Omni ARCHITECTS** 12/1/02 DATE

- 1 STRUCTURAL CONCRETE FOUNDATION - SEE STRUCTURAL DRAWINGS FOR DIMENSIONS, BEARING POINTS AND REINFORCING
- 2 STRUCTURAL CONCRETE SLAB - SEE STRUCTURAL DRAWINGS FOR DIMENSIONS, REINFORCING, AND ENGINEERED FILL
- 3 EXPOSED CAST-IN-PLACE CONCRETE SURFACE - DO NOT PAINT
- 4 EXPOSED CAST-IN-PLACE CONCRETE SURFACE BEYOND
- 5 EXPOSED CAST-IN-PLACE CONCRETE WEARING SLAB OVER RIGID INSULATION OVER MEMBRANE FLASHING OVER STRUCTURAL CONCRETE SLAB
- 6 LIGHTWEIGHT CONCRETE TOPPING OVER STRUCTURAL CONCRETE SLAB - SLOPE AT 1/4" PER FOOT TO DRAIN AS SHOWN ON ROOF PLAN
- 7 EXPOSED CAST-IN-PLACE CONCRETE WITH ARCHITECTURAL FINISH AND RUSTICATION JOINTS
- 8 CONCRETE REVEAL FOR SURFACE-MOUNTED LIGHT FIXTURE
- 9 CONCRETE MASONRY UNITS WITH HORIZONTAL JOINTS AND CORNICES AT 16" ON CENTER VERTICALLY - SEE FINISH SCHEDULE FOR FINISH
- 10 EXPOSED STEEL STRUCTURE WITH INTUMESCENT PAINTED FINISH - SEE STRUCTURAL DRAWINGS FOR SIZE AND DIMENSIONS
- 11 STEEL STRUCTURE - SEE STRUCTURAL DRAWINGS FOR SIZE AND DIMENSIONS
- 12 EXPOSED STEEL STRUCTURE WITH PAINTED FINISH - SEE STRUCTURAL DRAWINGS FOR SIZE AND DIMENSIONS
- 13 METAL ROOF DECK - SEE STRUCTURAL DRAWINGS FOR DEPTH AND GAUGE
- 14 STEEL EDGE ANGLE - SEE STRUCTURAL DRAWINGS FOR SIZE AND DIMENSIONS
- 15 16 GAUGE COLD-FORMED METAL STUDS AT 16" ON CENTER
- 16 16 GAUGE COLD-FORMED METAL FRAMING AT 16" ON CENTER
- 17 SECURE EACH COLD-FORMED FRAMING MEMBER TO STEEL STRUCTURE WITH SLIP JOINT FOR DEFLECTION
- 18 SLOPED CONCRETE SURFACE
- 19 PROVIDE DOUBLE STUDS AT THIS LOCATION, TYPICAL
- 20 METAL STUDS AT 16" ON CENTER
- 21 METAL FRAMING AT 16" ON CENTER
- 22 EXTERIOR ALUMINUM GUARDRAIL WITH BLACK FLUOROPOLYMER FINISH - 42" HIGH
- 23 METAL HANDRAIL / GUARDRAIL WITH PAINTED FINISH
- 24 HOLLOW METAL DOOR AND FRAME WITH PAINTED FINISH
- 25 FIRE-TREATED WOOD BLOCKING
- 26 SHIM AS REQUIRED AT PERIMETER
- 27 SOLID SURFACING WINDOW SILL
- 28 APPROXIMATE FINISH GRADE - SEE SITE DRAWINGS FOR ELEVATION
- 29 AIR IN-FILTRATION BARRIER WITH TAPE JOINTS OVER 1/2" GLASS/MT FACED EXTERIOR OVERSUBSTRATE/FLASHING ON EXTERIOR FACE OF WALL AND 6 MIL VAPOR BARRIER ON INTERIOR FACE OF WALL - FILL WALL CAVITY WITH BATT INSULATION
- 30 BACKER ROD AND SEALANT IN COMPOSITE ALUMINUM PANEL JOINTS IN THIS LOCATION ONLY
- 31 COMPOSITE ALUMINUM SPANDREL PANEL WITH FINISH TO MATCH SURROUNDING FRAME
- 32 COMPOSITE ALUMINUM PANEL SYSTEM WITH FLUOROPOLYMER FINISH (COLOR SELECTED BY ARCHITECT) WITH CONCEALED FASTENERS, ALUMINUM MOUNTING TRACKS, AND SHIMS AS REQUIRED - FASTENERS TO MATCH ROOFING MANUFACTURER - PROVIDE FLASHING AND WEEP HOLES - DO NOT MATCH ALUMINUM COMPOSITE PANEL
- 33 COMPOSITE ALUMINUM PANEL SYSTEM BEYOND
- 34 COMPOSITE ALUMINUM PANEL SYSTEM WITH FLUOROPOLYMER FINISH (COLOR SELECTED BY ARCHITECT) WITH CONCEALED FASTENERS, ALUMINUM MOUNTING TRACKS, AND SHIMS AS REQUIRED - FASTENERS TO MATCH ROOFING MANUFACTURER - PROVIDE FLASHING AND WEEP HOLES - DO NOT MATCH ALUMINUM COMPOSITE PANEL
- 35 COMPOSITE ALUMINUM PANEL SYSTEM WITH FLUOROPOLYMER FINISH (COLOR SELECTED BY ARCHITECT) WITH CONCEALED FASTENERS, ALUMINUM MOUNTING TRACKS, AND SHIMS AS REQUIRED - FASTENERS TO MATCH ROOFING MANUFACTURER - PROVIDE FLASHING AND WEEP HOLES - DO NOT MATCH ALUMINUM COMPOSITE PANEL
- 36 EXTRUDED ALUMINUM COPING WITH FLUOROPOLYMER FINISH TO MATCH ALUMINUM COMPOSITE PANEL COLOR
- 37 EXTRUDED ALUMINUM FASCIA ROOF EDGE WITH FLUOROPOLYMER FINISH TO MATCH ALUMINUM COMPOSITE PANEL COLOR
- 38 NOT-ASPHALT-APPLIED MULTIPLY SBS MODIFIED BITUMEN ROOFING SYSTEM OVER POLYSTYRENE INSULATION BOARD - INSULATION TO BE APPROVED BY ROOFING MANUFACTURER - PROVIDE PROTECTION BOARD WHERE REQUIRED BY ROOFING MANUFACTURER
- 39 SLOPE RIGID INSULATION SHOWN AT 1/4" PER FOOT TO DRAIN AS SHOWN ON ROOF PLAN - R-20 MINIMUM
- 40 UNIFORM THICKNESS RIGID INSULATION
- 41 1/2" GLASS/MT FACED GYPSUM THERMAL BARRIER BOARD
- 42 THERMALLY-BROKEN ALUMINUM STOREFRONT FRAMING SYSTEM WITH BLACK FLUOROPOLYMER FINISH
- 43 TRANSLUCENT COMPOSITE FIBERGLASS PANELS WITH ALUMINUM FRAME WITH FLUOROPOLYMER FINISH TO MATCH ALUMINUM COMPOSITE PANEL COLOR
- 44 THERMALLY-BROKEN ALUMINUM STOREFRONT FRAMING SYSTEM WITH FLUOROPOLYMER FINISH TO MATCH ALUMINUM COMPOSITE PANEL COLOR
- 45 CURTAINWALL FRAMING SYSTEM WITH FLUOROPOLYMER FINISH TO MATCH ALUMINUM COMPOSITE PANEL COLOR
- 46 THERMALLY-BROKEN ALUMINUM STOREFRONT FRAMING SYSTEM WITH FLUOROPOLYMER FINISH
- 47 1" INSULATING CLEAR GLAZING WITH LOW-EMISSION COATING
- 48 1" INSULATING GREY TINTED GLAZING WITH LOW-EMISSION COATING
- 49 5/8" GYPSUM BOARD OVER VAPOR BARRIER OVER RIGID INSULATION OVER 2" METAL FURRING
- 50 5/8" GYPSUM BOARD - SEE FINISH SCHEDULE FOR FINISHES AND WALL TYPE SCHEDULE FOR RATED MATERIALS
- 51 5/8" GYPSUM BOARD BEYOND
- 52 SUSPENDED ACOUSTIC CEILING SYSTEM WITH 2'x2' PANELS - SEE FINISH SCHEDULE FOR PANEL TYPES
- 53 3/16" TAPERED RESILIENT BASE - SEE SCHEDULE FOR TYPE
- 54 WALL BASE - SEE SCHEDULE FOR TYPE
- 55 STEEL ACOUSTIC COVER WITH FLUOROPOLYMER FINISH TO MATCH ALUMINUM COMPOSITE PANEL COLOR
- 56 LABORATORY CASEWORK - SEE ENLARGED PLANS AND ELEVATIONS FOR CONFIGURATION AND DIMENSIONS
- 57 LIGHTWEIGHT CONCRETE TOPPING OVER STRUCTURAL METAL DECK - SLOPE AT 1/4" PER FOOT TO DRAIN AS SHOWN ON ROOF PLAN
- 58 EXPOSED CONCRETE FLOOR SLAB WITH TROWEL FINISH AND CLEAR HARDENER / SEALER
- 59 8" HIGH SURFACE-MOUNTED CAST ALUMINUM LETTERS / NUMBERS
- 60 COMPOSITE DRAINAGE / PROTECTION BOARD WITH INTEGRAL FILTER FABRIC OVER RUBBERIZED ASPHALT WATERPROOFING MEMBRANE - PROVIDE FOUNDATION DRAINS AS SHOWN
- 61 1" DEEP REVEAL IN CONCRETE SURFACE
- 62 5/8" GYPSUM BOARD OVER METAL FRAMING AT 16" ON CENTER
- 63 STRUCTURAL CONCRETE FRAME AND SLAB - SEE STRUCTURAL DRAWINGS FOR DIMENSIONS AND REINFORCING
- 64 EXPOSED STEEL STAIR SYSTEM WITH PAINTED FINISH - FULL STEEL TREAD PANS WITH CONCRETE AND PROVIDE 1 1/2" DIAMETER PIPE HANDRAILS AND GUARDRAILS AT 42" ABOVE FLOOR FLOOR FINISH - SEE ROOM FINISH SCHEDULE FOR TYPE

**7 TWO SPEED SILL SUPPORT @ 1st FLOOR**

1 1/2" = 1'-0"

ENLARGED PLANS, ELEVATIONS

# A-5.6

REVISIONS	DATE	NORTHERN KENTUCKY UNIVERSITY		DRAWING NO.
1		FINANCE AND ADMINISTRATION CABINET		A-5.6
2		DIVISION OF ENGINEERING		
3		DEPARTMENT FOR FACILITIES MANAGEMENT		
4		FRANKFORT, KENTUCKY		
5		REVIEWED		
6		DIV. OF ENGR.		
7		DATE		
8		APPROVED FOR PROGRAM CONCEPT ONLY		
9		DATE		

