

L24 and L26 STATIONARY LOUVERS FORMED STEEL

STANDARD CONSTRUCTION

FRAME

L24 - 4" (102mm) deep, 20 gage (.9mm) galvanized steel.

L26 - 6" (152mm) deep, 20 gage (.9mm) galvanized steel.

BLADES

L24 - 20 gage (.9mm) galvanized steel chevron style blades on approximately 2 1/2" (64mm) centers.

L26 - 20 gage (.9mm) galvanized steel chevron style blades on approximately 3 1/2" (89mm) centers.

SCREEN

1/2" (13mm) mesh x 19 gage (1.3mm) screen in removable frame. Screen adds approximately 1/2" (13mm) to louver depth.

FINISH

Mill.

MINIMUM SIZE

12" wide x 12" high (305mm x 305mm)

MAXIMUM FACTORY ASSEMBLY SIZE

64 sq. ft. (6m²). Sections must fit into standard enclosed trailer 90" high x 240" deep (2286mm x 6096mm).

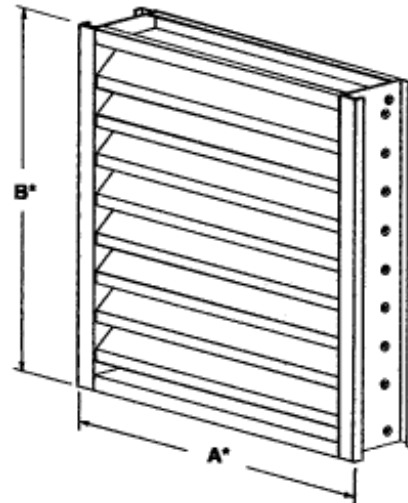

FEATURES

The L24 and L26 offer:

- Sightproof and vandal resistant blades.
- Economical galvanized steel construction.
- Approximate free area for a 48" wide unit: 42% for L24; 47% for L26

VARIATIONS

Variations to the basic design of this louver are available at additional cost. They include:

- Extended sill
- Hinged frame
- Front or rear security bars
- Filter racks
- A variety of bird and insect screens
- Selection of finishes: baked enamel (modified fluoropolymer), epoxy, integral color and clear anodize, Kynar, Fluoridize and prime coat.
- Heavier 18 gage (1.2mm) and 16 gage (1.5mm) construction.

Consult Ruskin for other special requirements.

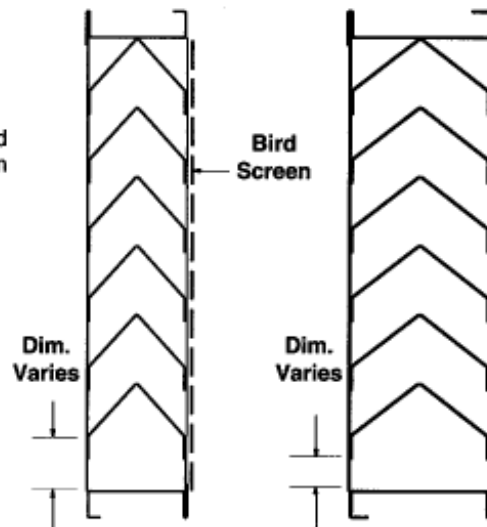

FRAME CONSTRUCTION

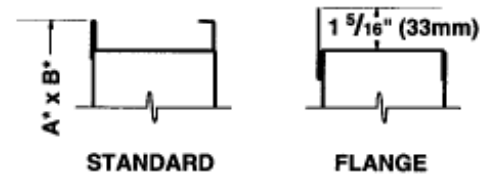

Units furnished 1/4" (6mm) smaller than given opening dimensions

TAG	QTY.	SIZE		FRAME	VARIATIONS
		A" - WIDE	B" - HIGH		
PROJECT			LOCATION		
ARCH/ENGR.			CONTRACTOR		
REPRESENTATIVE			DATE		

TYPICAL INSTALLATION DETAILS

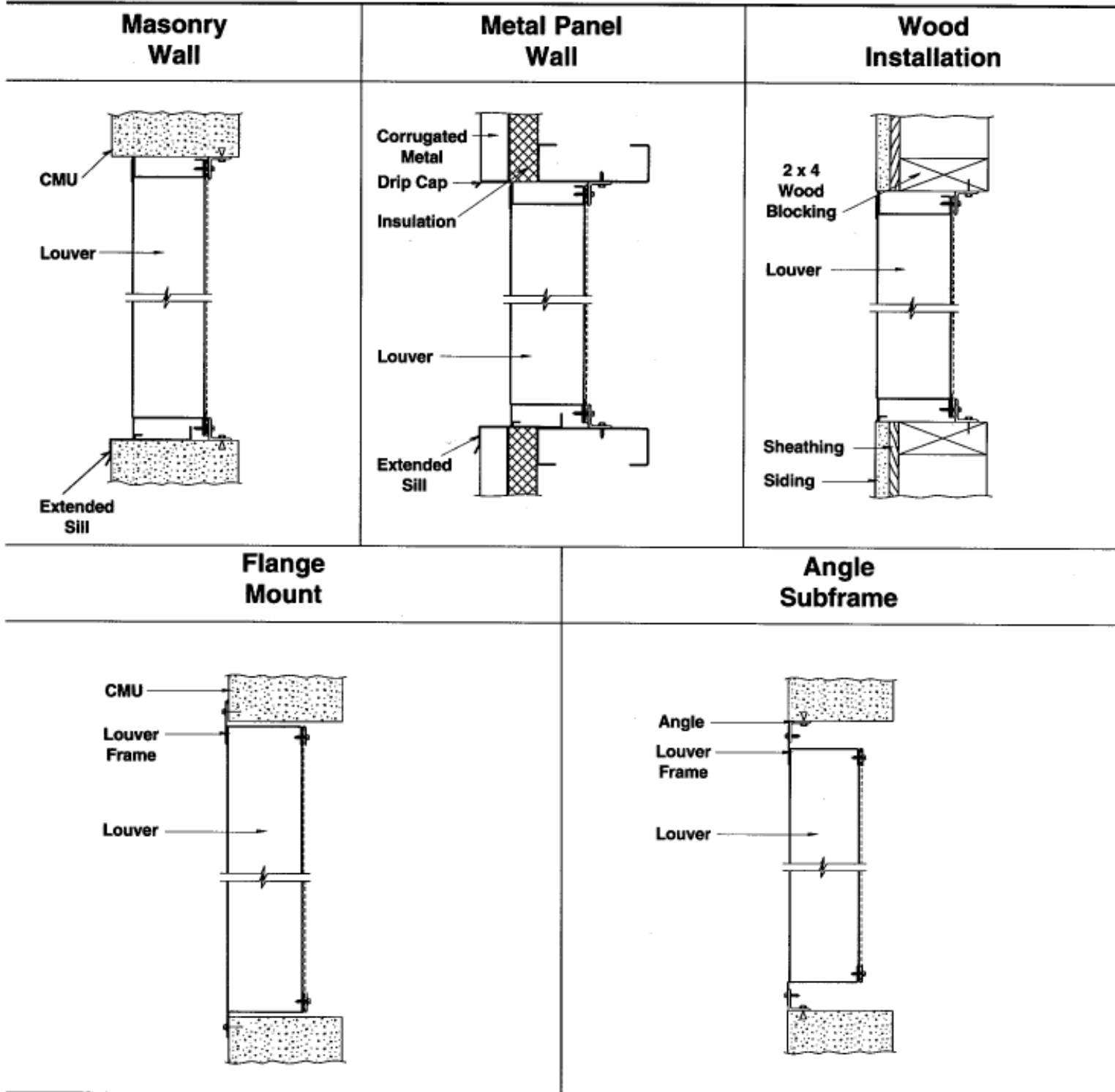

SUGGESTED SPECIFICATION

Furnish and install louvers as hereinafter specified where shown on plans or as described in schedules. Louvers shall be stationary type entirely contained within a 4" or 6" (102mm or 152mm) frame. Louver components (heads, jambs, sills, blades & mullions) shall be factory assembled by the louver manufacturer. Louver sizes too large for shipping shall be built up by the contractor from factory assembled louver sections to provide overall sizes required. Louver design shall limit span between visible mullions to 6 feet (2m) and shall incorporate structural supports required to withstand a wind load of 20 lbs. per sq. ft. (.96kPa) (equivalent to a 90 mph wind - specifier may substitute any loading required.)

Louvers shall be Ruskin Model L24 or L26 construction as follows:

- Frame: 20 gage (.9mm) galvanized steel
- Blades: 20 gage (.9mm) galvanized steel chevron style on approximately 2 1/2" (L24) or 3 1/2" (L26) centers (64mm or 89mm).
- Screen: 1/2" mesh x 19 gage galvanized steel (13mm x 1.1mm)
- Finish: Select finish specification from Ruskin Finishes Brochure.

RUSKIN®

3900 Dr. Greaves Rd.
Grandview, MO 64030
(816) 761-7476
FAX (816) 765-8955