

Mammoth Inc. certifies that it will furnish equipment in accordance with this drawing and specifications, and subject to its published warranty. Purchaser's approval of this drawing signifies that the equipment is acceptable under the provisions of the job specifications. Any change made hereon by any person whomever is subject to acceptance by Mammoth Inc. 13200 Pioneer Trail, Ste 150, Eden Prairie, MN 55347.

General Specifications

CABINET - Outer casing of G-60 galvanized steel.
REFRIGERANT CIRCUIT - Hermetically sealed 410A circuitry with reversing valve (HP only), TX metering device, and high/low side access valve.
COMPRESSOR - Hermetic type with PSC or three phase motor, overload protection and mounted on neoprene isolators.
AIR COIL - Seamless copper tubes and aluminum fins.
HEAT EXCHANGER - Coaxial water to refrigerant with steel outer tube and convoluted copper inner tube.
FILTER - 1-inch thick disposable
INSULATION - Thermally and acoustically optimized 3/4 inch thick, 1 1/2 lb. density faced.

FAN - Direct drive, dynamically balanced, airfoil shaped plug fan.
FAN MOTOR - Premium efficiency TEAO with sealed, locked bearings, and overload protection.
ELECTRICAL - 24-volt microprocessor control system with fan relay, compressor contactor, reversing valve coil (HP only).
CONTROL - Standard CAV operation by field mounted, wall type thermostat. Optional VAV operation with MDDC.

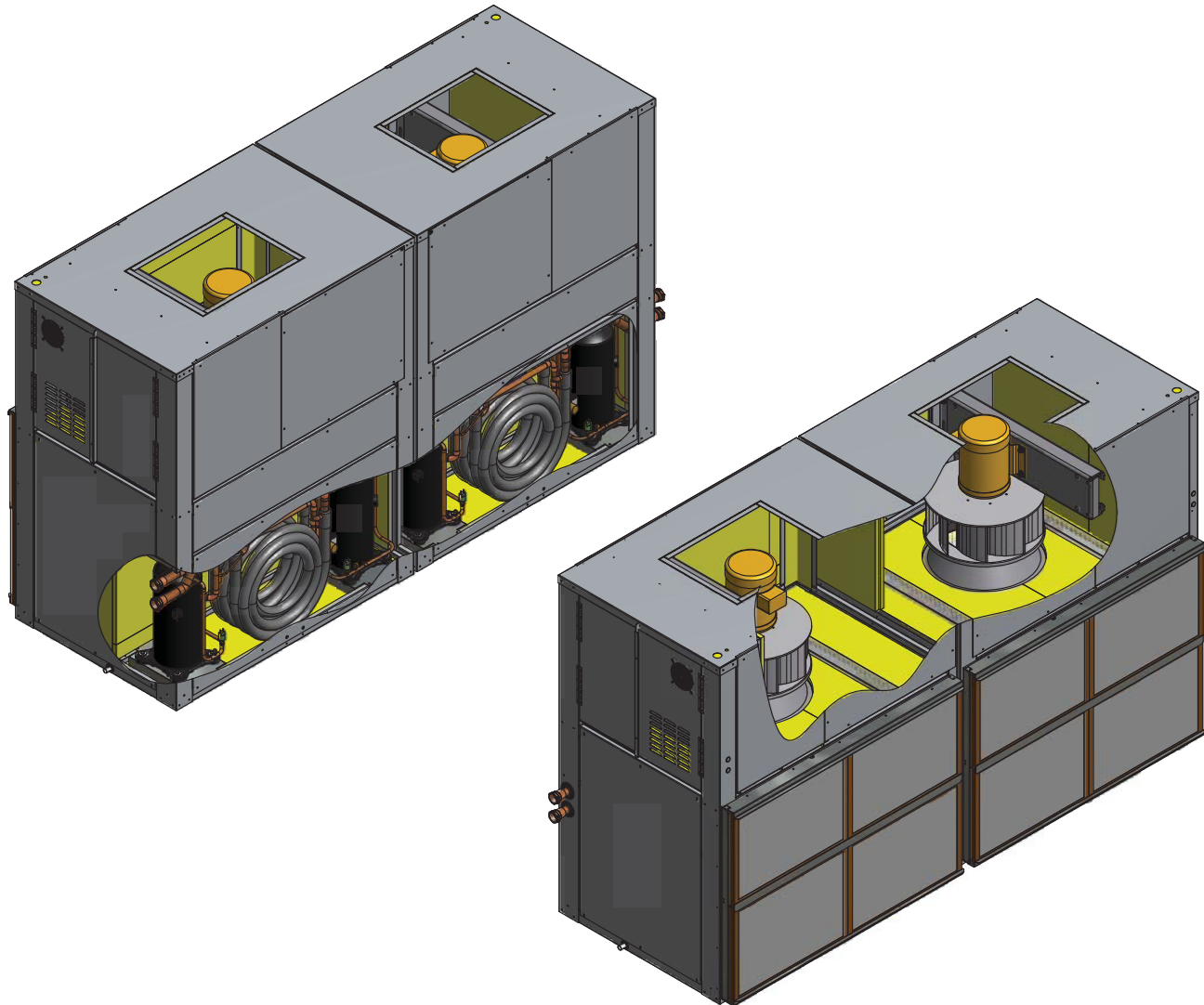

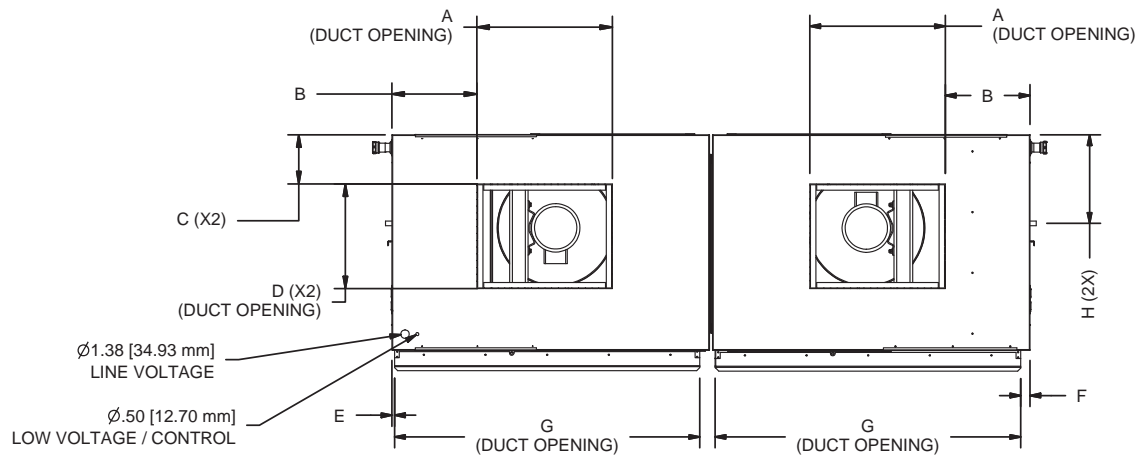

TOP VIEW

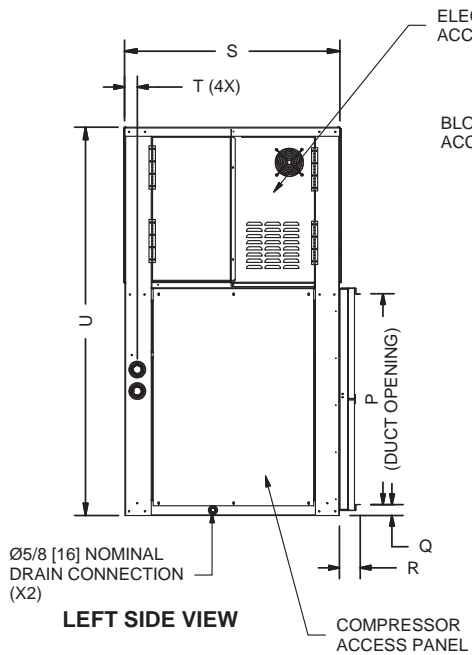

LEFT SIDE VIEW

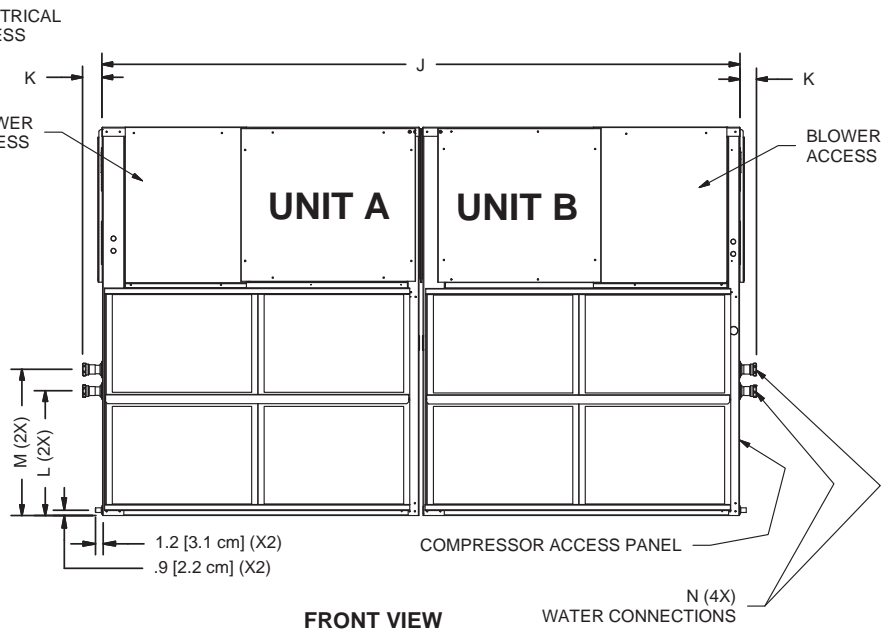

FRONT VIEW

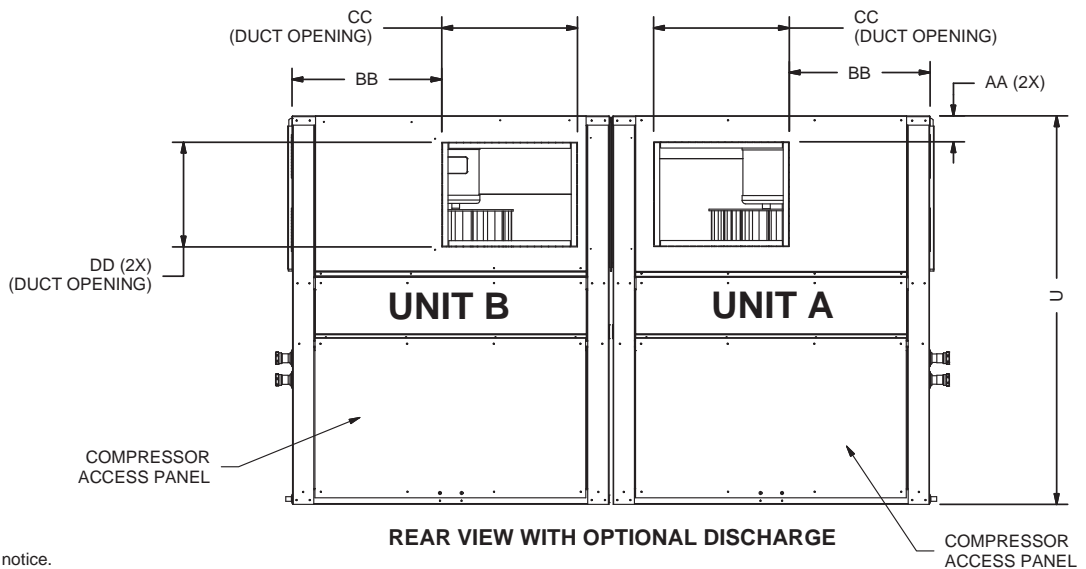

REAR VIEW WITH OPTIONAL DISCHARGE

Specifications subject to change without notice.

DIMENSION INCHES [CM]	UNIT SIZE			
	168	192	240	288
A	22 [55.9]	22 [55.9]	22 [55.9]	22 [55.9]
B	13.8 [34.9]	13.8 [34.9]	13.8 [34.9]	13.8 [34.9]
C	8 [20.3]	8 [20.3]	8 [20.3]	8 [20.3]
D	17 [43.2]	17 [43.2]	17 [43.2]	17 [43.2]
E	.4 [1]	.4 [1]	.4 [1]	.4 [1]
F	1.5 [3.8]	1.5 [3.8]	1.5 [3.8]	1.5 [3.8]
G	49.5 [125.7]	49.5 [125.7]	49.5 [125.7]	49.5 [125.7]
H	14.4 [36.6]	14.4 [36.6]	14.4 [36.6]	14.4 [36.6]
J	103 [261.6]	103 [261.6]	103 [261.6]	103 [261.6]
K	1.9 [4.8]	1.9 [4.8]	1.9 [4.8]	1.9 [4.8]
L	20.1 [51]	20.1 [51]	20.1 [51]	20.1 [51]
M	23.1 [58.7]	23.1 [58.7]	23.1 [58.7]	23.1 [58.7]
N	1-1/4 [3.2] FNPT	1-1/4 [3.2] FNPT	1-1/4 [3.2] FNPT	1-1/4 [3.2] FNPT
P	24 [61]	24 [61]	34.2 [86.9]	34.2 [86.9]
Q	2.6 [6.6]	2.6 [6.6]	1.8 [4.4]	1.8 [4.4]
R	3.4 [8.6]	3.4 [8.6]	3.4 [8.6]	3.4 [8.6]
S	37.5 [95.3]	37.5 [95.3]	37.5 [95.3]	37.5 [95.3]
T	2.1 [5.4]	2.1 [5.4]	2.1 [5.4]	2.1 [5.4]
U	63 [160]	63 [160]	63 [160]	63 [160]
AA	4.2 [10.7]	4.2 [10.7]	4.2 [10.7]	4.2 [10.7]
BB	22.8 [57.9]	22.8 [57.9]	22.8 [57.9]	22.8 [57.9]
CC	22 [55.9]	22 [55.9]	22 [55.9]	22 [55.9]
DD	17 [43.2]	17 [43.2]	17 [43.2]	17 [43.2]

FILTER SIZE & QTY'S.				
UNIT SIZE	168	192	240	288
FILTER SIZE	25 X 25 X 1 (4)	16 X 25 X 1 (6)	18 X 25 X 1 (8)	18 X 25 X 1 (8)

WEIGHTS Lbs [Kg]	UNIT SIZE			
	168	192	240	288
SHIPPING	1900 [862]	1980 [900]	2120 [962]	2180 [990]

ELECTRICAL DATA

Unit Size	Voltage	Compressor		Blower Motor HP	Blower Motor FLA	VFD Input Current	Total Amps	Min/Max Voltages	Minimum Circuit Amps	Maximum Overcurrent Protection (MOPD)
		RLA	LRA							
168	208-230/60/3	12.2	101	2 @ 1.5 2 @ 2	13.8 15.6	21.6	70.4	187/253	76.6	100
168	460/60/3	5.4	44	2 @ 1.5 2 @ 2	6 6.4	8.6	30.2	414/506	33	45
168	380-415/50/3	5.5	46	2 @ 1.5 2 @ 2	5 7	8.6	26.2	342/456	33.4	40
168	575/60/3	4.4	34	2 @ 1.5 2 @ 2	4.8 5.4	8.6	26.2	518/633	28.4	40

Unit Size	Voltage	Compressor		Blower Motor HP	Blower Motor FLA	VFD Input Current	Total Amps	Min/Max Voltages	Minimum Circuit Amps	Maximum Overcurrent Protection (MOPD)
		RLA	LRA							
192	208-230/60/3	13	127	2 @ 1.5 2 @ 2 2 @ 3	13.8 15.6 22	21.6 27.8	73.6 74.8	187/253	76.9 83.1	125
192	460/60/3	5.5	52	2 @ 1.5 2 @ 2 2 @ 3	6 6.8 9.6	8.6 11.8	30.6 33.8	414/506	32 35.2	45
192	380-415/50/3	5.6	43	2 @ 1.5 2 @ 2 2 @ 3	5 7 10.8	8.6 10.8	31 33.2	342/456	32.4 34.6	45 45
192	575/60/3	4.9	33	2 @ 1.5 2 @ 2 2 @ 3	4.8 5.4 7.8	7.2 7.2 10.2	28.2 31.2	518/633	29.4 31	45

Unit Size	Voltage	Compressor		Blower Motor HP	Blower Motor FLA	VFD Input Current	Total Amps	Min/Max Voltages	Minimum Circuit Amps	Maximum Overcurrent Protection (MOPD)
		RLA	LRA							
240	208-230/60/3	16.7	127	2 @ 3 2 @ 5	22 35	27.8 48	94.6 114.8	187/253	98.8 119.1	150
240	460/60/3	7.2	62	2 @ 3 2 @ 5	9.6 15.2	11.8 18.8	40.6 47.6	414/506	42.4 49.4	70
240	380-415/50/3	7	51.5	2 @ 3 2 @ 5	10.4 17.2	10.8 18.8	38.8 46.8	342/456	40.6 48.6	50 60
240	575/60/3	5.7	39	2 @ 3 2 @ 5	3.9 6.1	4.3 8.8	15.7 20.2	518/633	32.8 37.2	45

Unit Size	Voltage	Compressor		Blower Motor HP	Blower Motor FLA	VFD Input Current	Total Amps	Min/Max Voltages	Minimum Circuit Amps	Maximum Overcurrent Protection (MOPD)
		RLA	LRA							
288	208-230/60/3	19.3	179	2 @ 3 2 @ 5	22 35	27.8 48	105 125.2	187/253	109.8 139.9	175
288	460/60/3	8.3	62	2 @ 3 2 @ 5	9.6 15.2	11.8 18.8	45 52	414/506	47.1 54.1	70
288	380-415/50/3	8.3	64	2 @ 3 2 @ 5	10.4 17.2	10.8 18.8	44 52	342/456	46.1 54.1	60 70
288	575/60/3	6.8	50	2 @ 3 2 @ 5	7.8 12.2	8.6 18.8	35.8 46	518/633	37.5 47.7	50 60

Mammoth Inc. certifies that it will furnish equipment in accordance with this drawing and specifications, and subject to its published warranty. Purchaser's approval of this drawing signifies that the equipment is acceptable under the provisions of the job specifications. Any change made hereon by any person whomever is subject to acceptance by Mammoth Inc. 13200 Pioneer Trail, Ste 150, Eden Prairie, MN 55347.

General Specifications

CABINET - Outer casing of G-60 galvanized steel.
REFRIGERANT CIRCUIT - Hermetically sealed 410A circuitry with reversing valve (HP only), TX metering device, and high/low side access valve.
COMPRESSOR - Hermetic type with PSC or three phase motor, overload protection and mounted on neoprene isolators.
AIR COIL - Seamless copper tubes and aluminum fins.
HEAT EXCHANGER - Coaxial water to refrigerant with steel outer tube and convoluted copper inner tube.
FILTER - 1-inch thick disposable
INSULATION - Thermally and acoustically optimized 3/4 inch thick, 1 1/2 lb. density faced.

FAN - Direct drive, dynamically balanced, airfoil shaped plug fan.
FAN MOTOR - Premium efficiency TEAO with sealed, locked bearings, and overload protection.
ELECTRICAL - 24-volt microprocessor control system with fan relay, compressor contactor, reversing valve coil (HP only).
CONTROL - Standard CAV operation by field mounted, wall type thermostat. Optional VAV operation with MDDC.

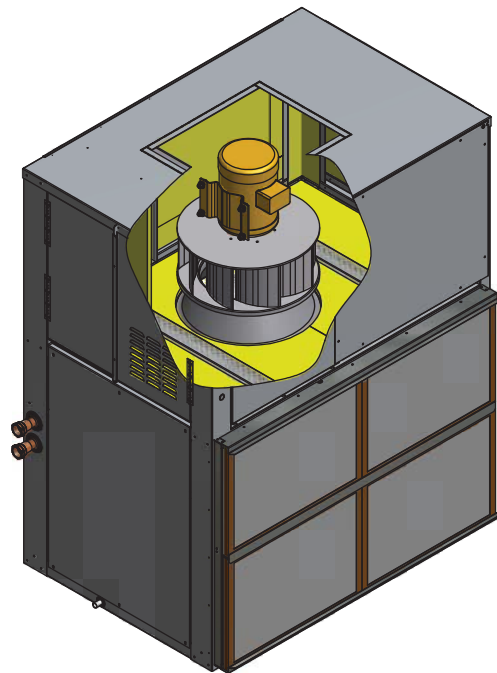
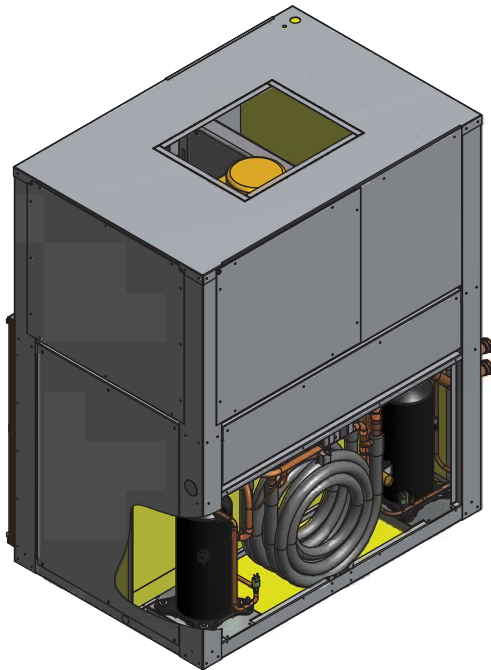

Left hand water connections and electrical box location viewed looking into the return air duct connection.

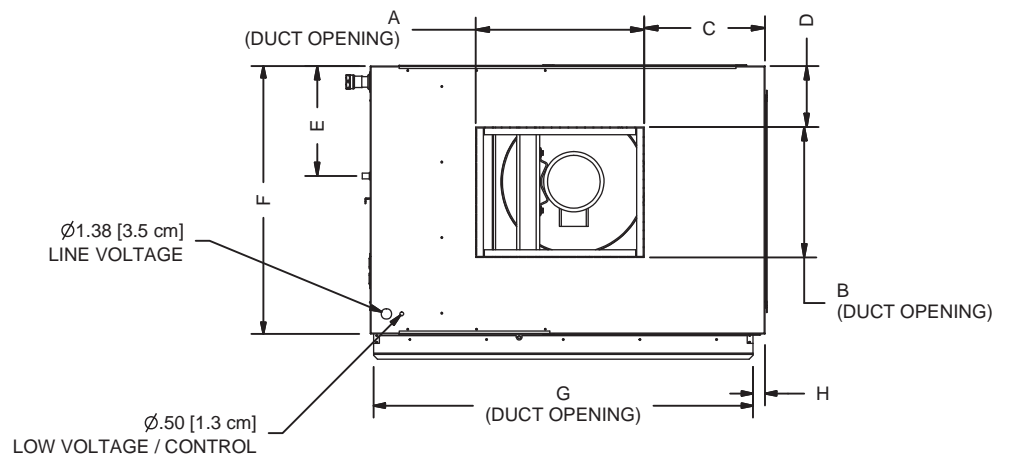

TOP VIEW

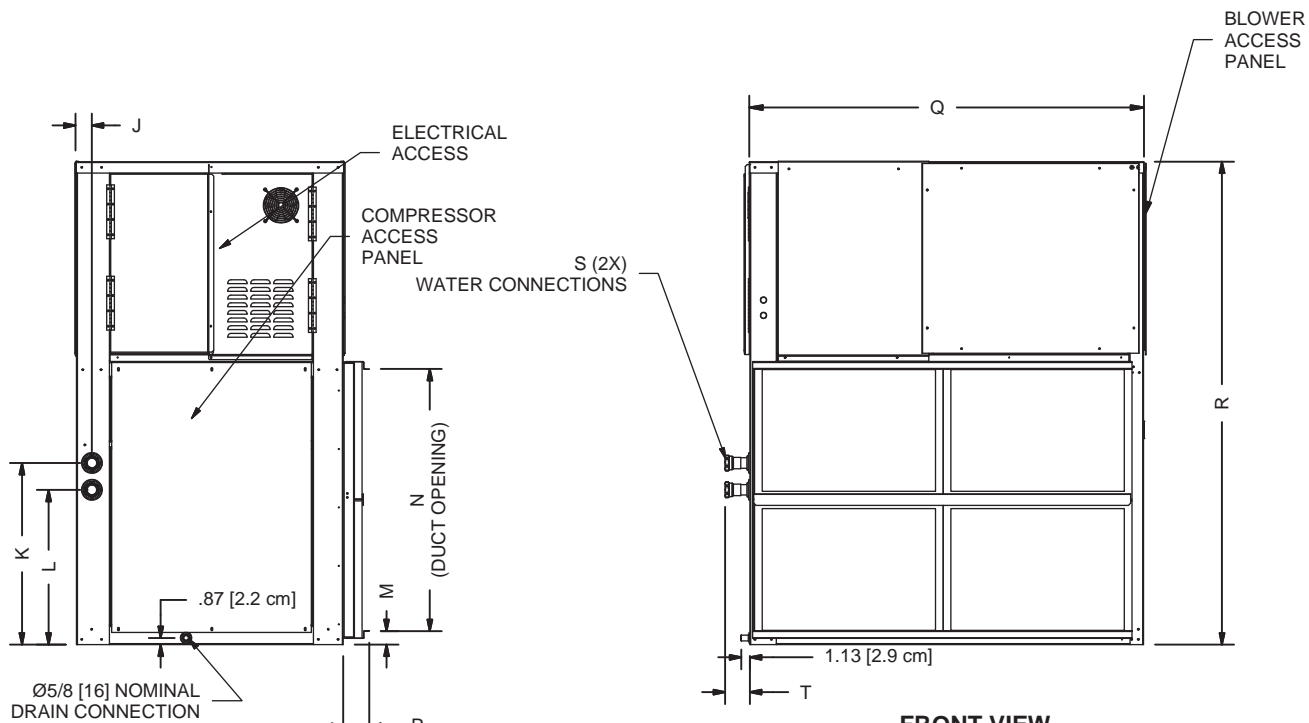

LEFT SIDE VIEW

FRONT VIEW

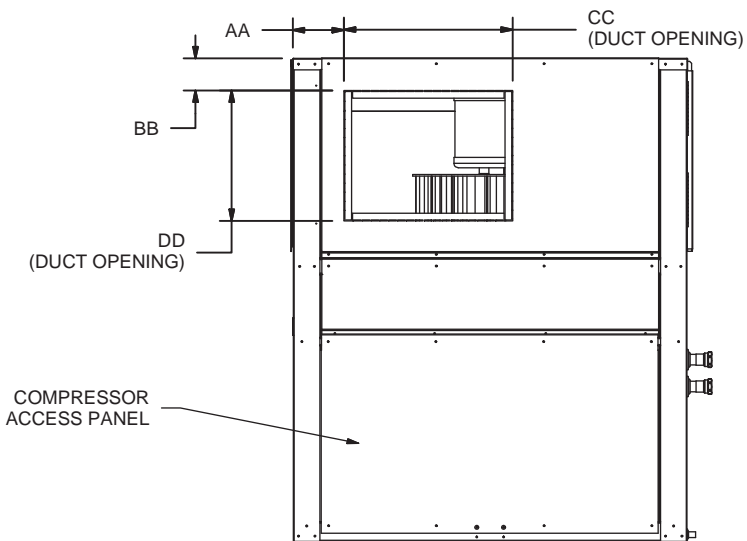

BACK VIEW WITH REAR DISCHARGE OPTION

Specifications subject to change without notice.

DIMENSIONS INCH [CM]	UNIT SIZE			
	084	096	120	144
A	22 [55.9]	22 [55.9]	22 [55.9]	22 [55.9]
B	17 [43.2]	17 [43.2]	17 [43.2]	17 [43.2]
C	15.8 [40]	15.8 [40]	15.8 [40]	15.8 [40]
D	8 [20.3]	8 [20.3]	8 [20.3]	8 [20.3]
E	14.4 [36.6]	14.4 [36.6]	14.4 [36.6]	14.4 [36.6]
F	35 [89]	35 [89]	35 [89]	35 [89]
G	49.5 [125.7]	49.5 [125.7]	49.5 [125.7]	49.5 [125.7]
H	1.5 [3.8]	1.5 [3.8]	1.5 [3.8]	1.5 [3.8]
J	2.1 [5.4]	2.1 [5.4]	2.1 [5.4]	2.1 [5.4]
K	23.8 [60.5]	23.8 [60.5]	23.8 [60.5]	23.8 [60.5]
L	20.3 [51.6]	20.3 [51.6]	20.3 [51.6]	20.3 [51.6]
M	2.6 [6.6]	2.6 [6.6]	1.8 [4.6]	1.8 [4.6]
N	24 [61]	24 [61]	34.2 [86.9]	34.2 [86.9]
P	3.8 [9.5]	3.8 [9.5]	3.8 [9.5]	3.8 [9.5]
Q	51.5 [130.8]	51.5 [130.8]	51.5 [130.8]	51.5 [130.8]
R	63 [160]	63 [160]	63 [160]	63 [160]
S	1-1/4 [3.2]FNPT	1-1/4 [3.2]FNPT	1-1/4 [3.2]FNPT	1-1/4 [3.2]FNPT
T	2.4 [6]	2.4 [6]	2.4 [6]	2.4 [6]
AA	6.6 [16.8]	6.6 [16.8]	6.6 [16.8]	6.6 [16.8]
BB	4.3 [10.8]	4.3 [10.8]	4.3 [10.8]	4.3 [10.8]
CC	22 [55.9]	22 [55.9]	22 [55.9]	22 [55.9]
DD	17 [43.2]	17 [43.2]	17 [43.2]	17 [43.2]

FILTER SIZE & QTY'S.				
UNIT SIZE	084	096	120	144
FILTER SIZE	25 X 25 X 1 (2)	16 x 25 x 1 (3)	18 x 25 x 1 (4)	18 x 25 x 1 (4)

WEIGHTS Lbs [Kg]	UNIT SIZE			
	084	096	120	144
SHIPPING	950 [431]	990 [450]	1060 [481]	1090 [495]

ELECTRICAL DATA

Unit Size	Voltage	Compressor		Blower	Blower	VFD Input Current	Total Amps	Min/Max Voltages	Minimum Circuit Amps	Maximum Overcurrent Protection (MOPD)
		RLA	LRA	Motor HP	Motor FLA					
084	208-230/60/3	12.2	101	1.5 2	6.9 7.8	10.8	35.2	187/253	38.3	50
084	460/60/3	5.4	44	1.5 2	3 3.4	4.3	15.1	414/506	16.5	25
084	380-415/50/3	5.5	46	1.5 2	2.5 3.5	4.3	13.1	342/456	16.7	25
084	575/60/3	4.4	34	1.5 2	2.4 2.7	4.3	13.1	518/633	14.2	25
Unit Size	Voltage	Compressor		Blower	Blower	VFD Input Current	Total Amps	Min/Max Voltages	Minimum Circuit Amps	Maximum Overcurrent Protection (MOPD)
		RLA	LRA	Motor HP	Motor FLA					
096	208-230/60/3	13	127	1.5 2 3	6.9 7.8 11	10.8	36.8	187/253	40.1 43.2	60
096	460/60/3	5.5	52	1.5 2 3	3 3.4 4.8	4.3 5.9	15.3 16.9	414/506	16.7 18.3	25
096	380-415/50/3	5.6	43	1.5 2 3	2.5 3.5 5.4	4.3 5.9	15.5 17.1	342/456	16.9 18.5	25
096	575/60/3	4.9	33	1.5 2 3	2.4 2.7 3.9	4.3	13.1	518/633	15.3	25
Unit Size	Voltage	Compressor		Blower	Blower	VFD Input Current	Total Amps	Min/Max Voltages	Minimum Circuit Amps	Maximum Overcurrent Protection (MOPD)
		RLA	LRA	Motor HP	Motor FLA					
120	208-230/60/3	16.7	127	3 5	11 17.5	13.9 24	47.3 57.4	187/253	51.5 61.2	70 80
120	460/60/3	7.2	62	3 5	4.8 7.6	5.9 9.4	20.3 23.8	414/506	22.1 25.6	35
120	380-415/50/3	7	51.5	3 5	5.4 8.6	5.9 9.4	19.9 23.4	342/456	21.7 25.2	30 35
120	575/60/3	5.7	39	3 5	3.9 6.1	4.3 8.8	15.7 20.2	518/633	17.1 21.6	25 30
Unit Size	Voltage	Compressor		Blower	Blower	VFD Input Current	Total Amps	Min/Max Voltages	Minimum Circuit Amps	Maximum Overcurrent Protection (MOPD)
		RLA	LRA	Motor HP	Motor FLA					
144	208-230/60/3	19.3	179	3 5	11 17.5	13.9 24	52.5 62.6	187/253	57.3 67.4	80 90
144	460/60/3	8.3	62	3 5	4.8 7.6	5.9 9.4	22.5 26	414/506	24.6 28.1	35 40
144	380-415/50/3	8.3	64	3 5	5.4 8.6	5.9 9.4	22.5 26	342/456	24.6 28.1	35 40
144	575/60/3	6.8	50	3 5	3.9 6.1	4.3 9.4	17.9 23	518/633	19.6 24.7	30 35