

GENERAL NOTES

- A. THE CONTRACTOR IS RESPONSIBLE FOR LOCATING AND PROTECTING UTILITIES PRIOR TO START OF WORK.
- B. FIELD VERIFY EXISTING ELEVATIONS AS INDICATED. REPORT ANY DISCREPANCY TO CONSTRUCTION MANAGER PRIOR TO START OF GRADING OPERATIONS.
- C. CONSTRUCT 3" FORCEMAIN WITH CLEANOUTS AT 50' SPACING PER SANITARY DISTRICT 1 TECHNICAL SPECIFICATIONS.

CODED NOTES

- 1. PROPOSED ARTIFICIAL TURF FIELDS. REFER TO LANDSCAPE ARCHITECTURE DRAWINGS.
- 2. PROPOSED SUPPORT BUILDING. REFER TO ARCHITECTURAL DRAWINGS.
- 3. PROPOSED STORM SEWER. REFER TO SHEET C-1.0.
- 4. PROPOSED CONDUIT RUNS. REFER TO MEP PLANS.
- 5. PROPOSED SANITARY FORCEMAIN.

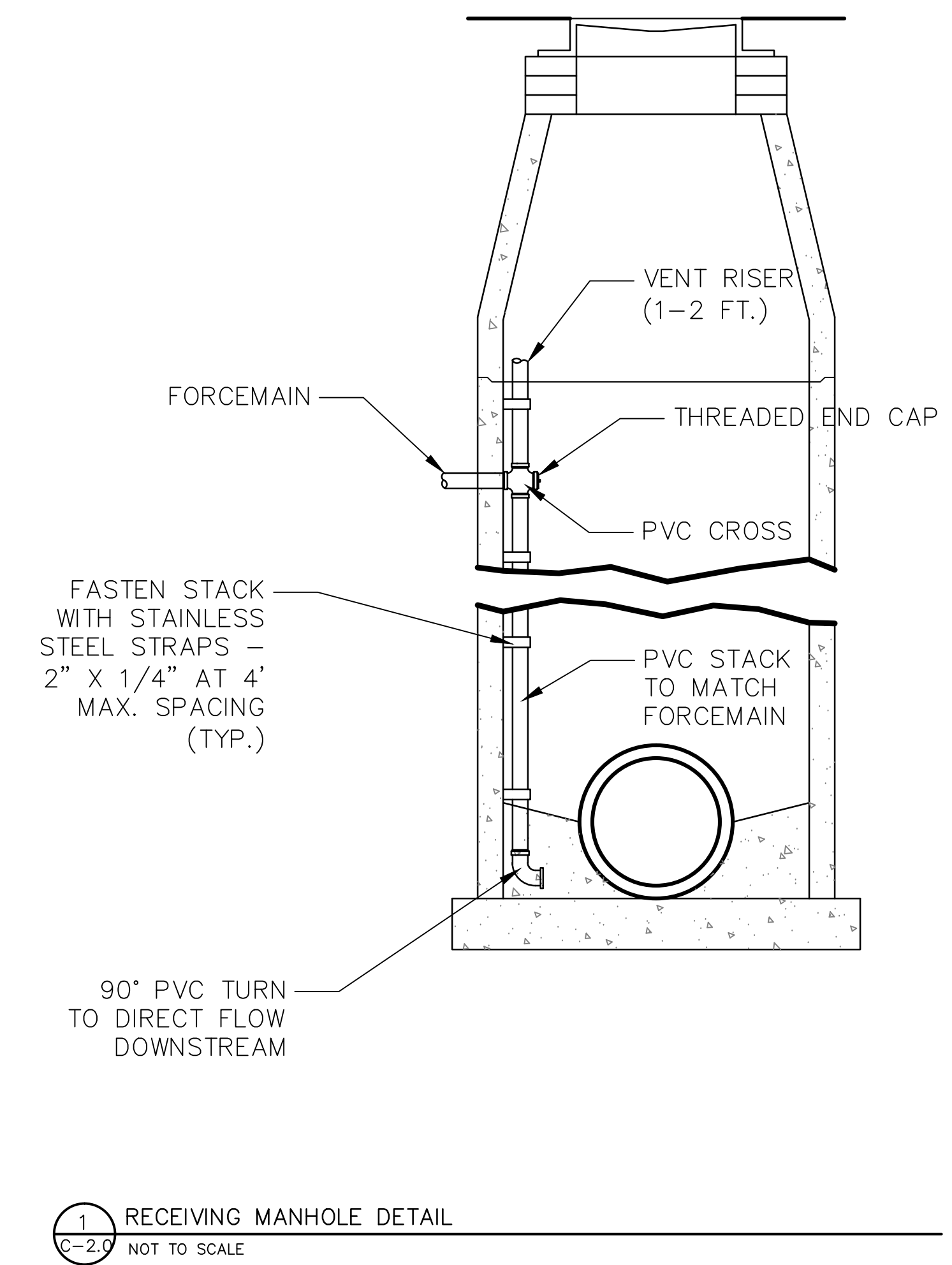
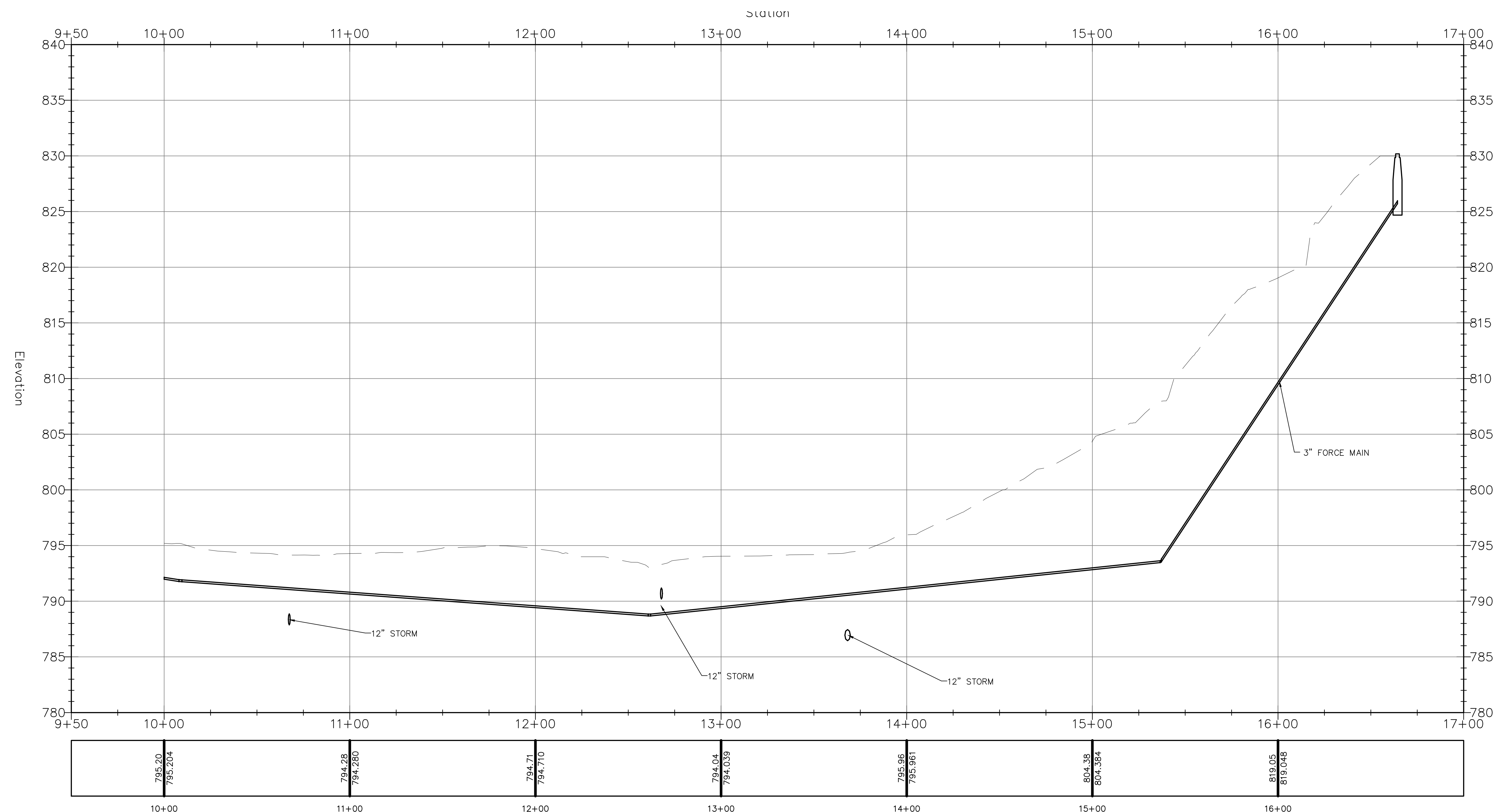
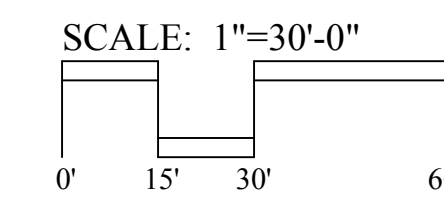
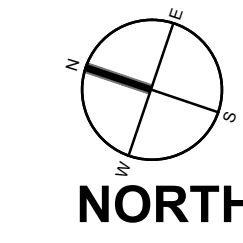

Northern Kentucky University -Intramural Fields and Support Building

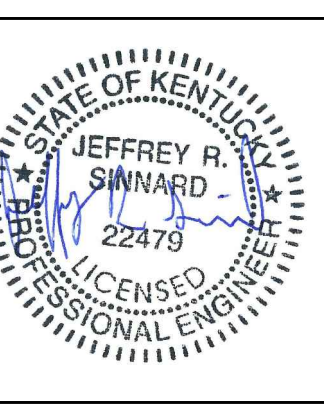

VIVIAN LLAMBI & ASSOCIATES, INC.
 ENVIRONMENTAL ENGINEERING ARCHITECTURE
 2312 Park Avenue, Cincinnati, Ohio 45206
 Phone: 513.533.3444 Fax: 513.533.0104
 Mobile: 502.480.9475, 502.502.5134/44

212 North Upper Street
 Lexington, Kentucky 40507-1001
 p 859.252.6664 f 859.253.2558
 www.omniarchitects.com

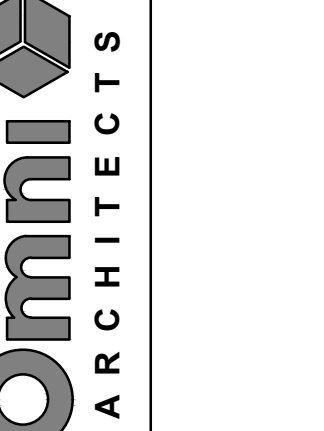

NORTHERN KENTUCKY UNIVERSITY



Revision Date	#	Checked By:
	1203	TRW
	08/31/2012	JRS

Sanitary Sewer Plan and Profile

Drawing Name: NKU Project Number: 1203
 Project Number: 08/31/2012
 Date: TRW
 Drawn By: JRS
 Checked By: