

VICINITY MAP - NTS

SURVEY NOTES:

By graphic plotting only, subject property appears to be located in Zone X (Areas determined to be outside the 0.2% annual chance floodplain)...

Underground pipes and conduits are plotted from structure to structure or from field markings or utility plans where applicable...

Right-of-way and proposed improvements for Johns Hill Road are based on KYTC Plans titled "Plans of Proposed Project, Campbell County, Johns Hill Road (KY 2345)..."

*Tree sizes shown are measured in Diameter at Breast Height.

The tunnels shown are per record drawings provided by NKU, and are not located during the course of this survey.

Current Zoning Classification: INST

Setbacks shall be per the Campbell County Zoning Ordinance.

*Requirements shall be in accordance with the approved Site Plan.

All plat and deed references are to the Campbell County Clerk's Office at Newport, Kentucky.

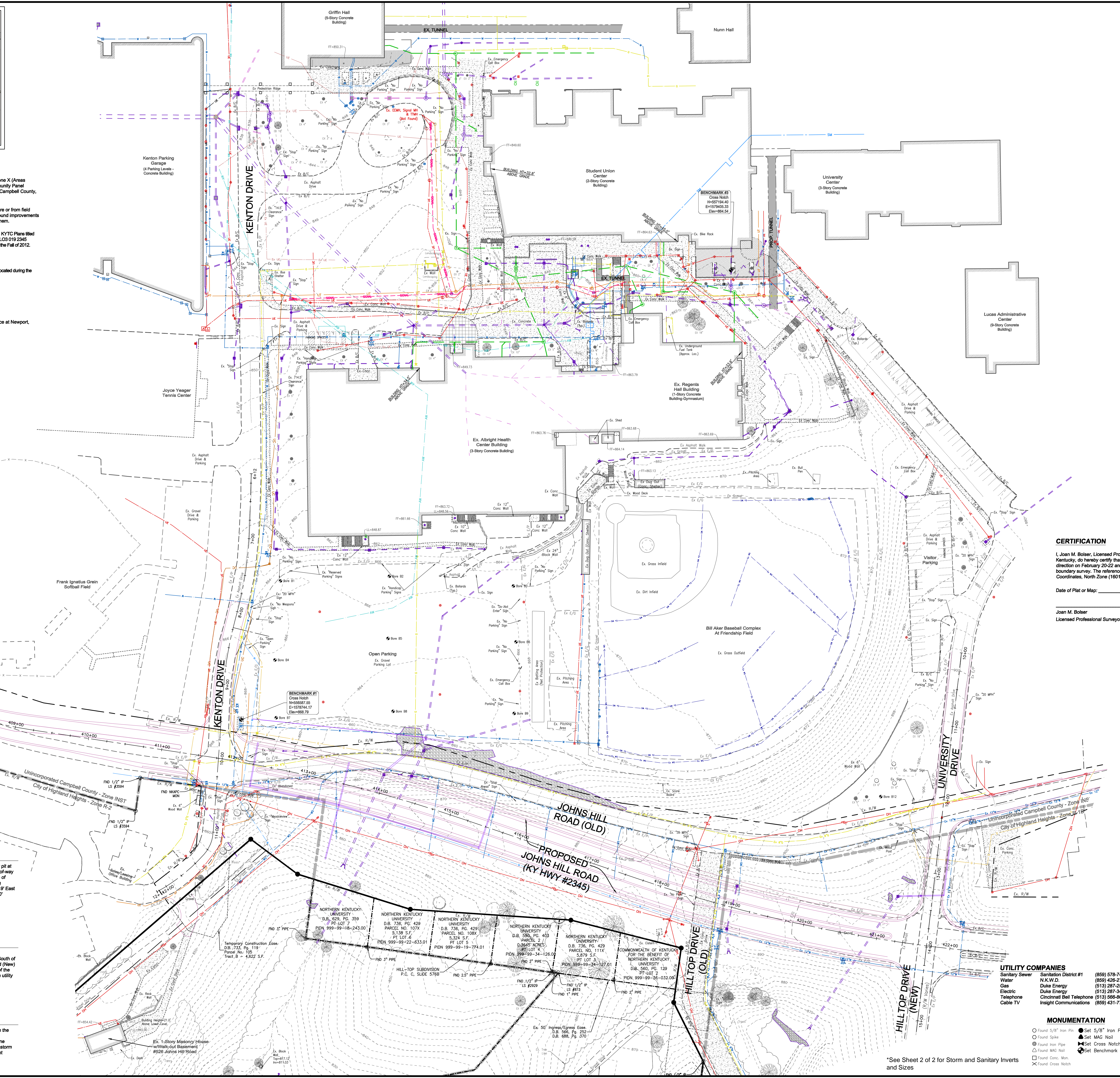

LEGEND, CERTIFICATION, BENCHMARK #1-3, UTILITY COMPANIES, MONUMENTATION, and other technical details.

Plot time: Mar 20, 2012, 3:17pm. Drawing name: J:\2012\12\2017-000\SD\DWG\12\017-000\BM.dwg - Layout Tab - Phase 2.

Project title: NKU RCR PROJECT PHASE II. Topographic & Utility Survey. Includes logos for bayer becker and NKU.