

**SD PHASE MEETING MINUTES****DATE** April 5, 2012**FROM** Michael Jacobs, AIA, CID, LEED AP
Principal Architect**TO** Rob Knarr, PE (for distribution to NKU)
Project Manager**SUBJECT** **Campus Recreation Center**
Northern Kentucky University
Highland Heights, KY**5a**

COMMENTS: The Project Executive Committee (PEC) meeting convened at 9:00am this date with NKU Project Executive Committee, Cannon Design, Omni Architects, BFMJ, CMTA, and VLA in Room SU302 of the Student Union. The first meeting was at 9:00am to review the preliminary schematic design schemes and discuss which options and elements from the designs should the design team continue to pursue. The second meeting was to review the same information with the NKU Project Steering Committee. Refer to sign-in sheets for those in attendance.

Kick-off Schematic Design**9:00am – 12:00pm****SU 302**

Michael Jacobs began the meeting with a summary of the progress to date since the previous programming meeting. Mike noted that the final draft of the Program Validation Phase Document will be sent to NKU next week. Michael pointed out that there were 3 broad concepts for review & response. These are broad-brush concepts, and do not include every component. Michael requested the PEC focus more on the attributes of the concepts and less on the details. The goal is to reach a consensus on which approach might be most successful. The team was reminded to evaluate the concepts within the broad goals framed during the programming phase.

- Clear way finding
- Interior visual interest
- Transforms exterior
- Identifiable as a Recreation Center

**SD PHASE MEETING MINUTES**

Page 2

George introduced the schematic design options that have been created. George pointed out that the purpose of the meeting is to encourage an interactive open discussion with the owner and the design team. The schematic design concepts are observations in the form of 3 different concepts.

- George noted 3 points in regards to the design concepts
 - Would prefer that the design not look like an addition
 - It should be inviting from all directions of campus, not one in particular
 - Will provide "Light" into the building

Design A:

- The design reaches out and creates a "community" to invite from all parts of the campus. Does not turn it's back to any parts of campus
- The design entry evolved during yesterday's meeting to include a plaza which extends out to the entry/exit to the garage
- Provides a natural day lighting strategy for the building
- MEP and Site/Civil discussions from yesterday's meeting were reviewed for potential design implications
- Night views of the design were presented and show the potential transparency and the building as a kind of "Lantern"
- Michael Jacobs noted that the re-routing of the delivery trucks to come from the Student Union car drop-off loop back to the loading area was reviewed by the design team in yesterday's consultant meeting. The design team discussed how the same issue of students crossing the path of the trucks still existed. So the idea of shifting the utility road over to align with the entry/exit of the parking garage was developed as an option. This provides a "front yard" to the entrance.
- Reviewed the Sketch-up model & Building Section that shows opening up the main weight room & exercise rooms & eliminating the 2nd Floor Albright Restrooms
- Reviewed the new exercise areas west of the existing track & views outside, down to the gym and down to the proposed recreation pool location
- Reviewed mechanical concepts that allow for the most efficient locations of mechanical rooms so there is an even distribution of spaces throughout the building to service main spaces by proximity. These locations and concepts are being considered for possible future expansions (mechanical exhaust through roofs vs. through walls)
- This design allows for a second entry, which lends toward the flexibility of future expansion of the recreation center and campus. Mary Paula noted that a second entry will need to be a secured entry point
- Larry Blake pointed out that large amounts of glass are difficult to keep clean (example: Griffin Hall) and the design team should take that into consideration when designing large expanses of glass

**SD PHASE MEETING MINUTES**

Page 3

- Vivian Llambi discussed the building form & how it incorporates the landscape with interior & exterior views from around the building. The turn radius for the largest delivery truck will be reviewed to make easy entry and exit
- The forms & shapes on the roof (where visible from road) will be considered so people are not just looking at a blank white roof (a Japanese garden was one design suggestion)
- This design does not identify all program elements, although they are included (for example, the athletic training lab, the equipment storage room, distribution counter and laundry facility)
- CMTA prepared a listing of mechanical room requirements:

NKU Mechanical Space Planning

New

OA Units	2x800sf =	1600sf
AHU's	6x800sf =	3600sf
HPC/wells		700sf
Dom. Water		400sf
Pool – Roof Equipment		TBA
Electric Room		<u>TBA</u>
		6300sf

Renovation

OA Units	1x800sf =	800sf
AHU's	7x600sf =	4200sf
STM/CW		400sf
Elec. Room	Maintain Existing	<u>5400sf</u>

Well field 60 wells @ 20'-0" O.C.

Design #B:

- This design approach takes most of the program & puts it on the 2nd Floor which creates a 2nd level entry in the green space north of the CRC. This requires bridging over the access road
- A basketball court and administration area are located at the entry and on the "bridge"
- The new recreation pool is located on the 2nd level
- Existing track becomes fitness area (12' AFF)
- Track moves to 3rd Floor by itself

**SD PHASE MEETING MINUTES**

Page 4

NKU Comments:

- Does feel like an addition
- Very Long Building
- Will be a more expensive building than option #1
- Does have a clearly defined "front door"

Design #C:

- This design approach takes most of the program & puts it on the 2nd Floor
- The main entry is by a pedestrian bridge to the 2nd level over the access road
- The track is a long element on the west façade
- Existing track becomes fitness area & circulation
- The new recreation pool is located on the 2nd level

NKU Comments:

- The track would be expensive
- The least "smart" of all three designs

The discussion moved back to the initial Design #1:

- Mary Paula and Jeff questioned whether the ramp is forcing itself in a way that works against the project issues
- In regards to the location of the Administration area on the 2nd Level of the new recreation center:
 - Matt stated that the physical separation from the rest of the recreation center and the views to outside are desirable for the administrators only
 - Mary Paula asked if the administrators would feel too isolated as if they were on an "island"
- Level of track will need to remain @ 12'-0" above finish floor and the fitness areas around it will be at 14'-0" or 16'-0"
- In regards to the 2nd Floor Restroom removal from Albright:
 - Should it stay or be removed? Should there be a physical disconnection from the recreation center to the Albright Center
 - Mary Paula stated that there needed to be a physical connection between Albright and the new recreation center, at the main entry level, and that at that connection there needed to be a control point. There also needs to be an elevator and a stair prior to the control point
 - Matt stated that he felt that at least certain elements of the administration suite needed to be on the first floor near the entry
- Peyman mentioned the possibility of moving Kinesiology to the third floor
 - Steve suggested that the Kinesiology stay in it's current location and that the group should try to work out Matt's issues with the administration area

**SD PHASE MEETING MINUTES**

Page 5

- Matt stated that office space for their staff will need to be near the control point. This would allow for recreation administration to be on the 2nd Floor.

Mary Paula reviewed her discussion that she had with the Department of Highways engineers regarding the road work proposed to cut across the existing recreation field

- The road can be lowered several feet and the redesign would likely delay start of construction. The high elevation of the road is required due to the need to connect to the parking lots along the west edge of campus; as its is, the connector road is about 10 below the parking lots (i.e. lots K,L,P). Thus, lowering of the road isn't possible along the recreation field area.

Mary Paula reviewed her discussion with Duke Energy regarding the overhead power lines that cross the existing recreation field. Duke Energy reported that the overhead lines must be a minimum of 35'-0" above the field (and the road); currently, the lines are 50'-60' above the fields. The pole on the west side of connector road will have the effect of raising the lines 35' above the connector road, which results in the lines being 57'-60' above the fields. The alignment of the lines in relation to the fields is less of a problem than originally anticipated. NKU asked that \$50,000 (rather than \$300,000) be held in the budget for possible utility pole replacement/relocation on the east side of the field area.

- Tony noted that the electric pole locations will need to be coordinated with the location of the sport lighting for the fields

Jeff and Matt discussed the size of the football field proposed for the new recreation field and will be able to reduce the size of the field to an intramural size, which will also reduce the required height and design of the retaining walls on the north west corner of the field.

End of Meeting

**SD PHASE MEETING MINUTES**

Page 6

Meeting minutes have been prepared to establish a record of the meeting and information shared. If you have any questions, additions, comments, or corrections, please forward to Omni Architects for inclusion.

Attachments:

Sign-in Sheet
Schematic Design Schemes A, B & C
Images of physical model studies

cc:

Mary Paula Schuh	NKU
Michael Jacobs	Omni Architects
Don Adams	Omni Architects
Jay Copley	Omni Architects
George Nikolajevich	Cannon Design
Reed Voorhees	Cannon Design
David Body	Cannon Design
John McAlister	Cannon Design
Steve Crocker	Counsilman-Hunsaker
Tony Hans	CMTA
Peyman Jahed	BFMJ
Vivian Llambi	VLA
Fred Bowling	VLA
Mark Gillis	The Sextant Group
Robert Pass	RP+A
Correspondence File	

MWJ/mwj

Meeting Attendees

Omni ARCHITECTS **CANNON** DESIGN

Subject: Northern Kentucky University Campus Recreation Center

Location: 5A 302
(Please Print)

Date: 4.5.12 Time: 9:00 AM

NAME	REPRESENTING / ROLE	TELEPHONE	EMAIL
Jay Corbett	OMNI ARCHITECTS		JCORBET@OMNIARCHITECTS.COM
DON ADAMS	OMNI ARCHITECTS		DLADAMS@OMNIARCHITECTS.COM
KELLYN VELANDER	OMNI ARCHITECTS		KELLYN@OMNIARCHITECTS.COM
VIVIAN CLAMBY	VIVIAN CLAMBY & ASSOC.		VIVIAN@CLAMBYEXCAV.NET
FRED BOWLING	VLA		FRED.BOWLING@VLA.NET
MICHAEL JACOBS	OMNI		mjacobs@omniarchitects.com
Matt Hackel	NKU		hackel@ncu.edu
JEFFREY WAPLE	NKU		WAPLE@NKU.EDU
STEVE NIGANBERG	NKU		NIGANBERG1@NKU.EDU
Mary Paul Schuch	NKU		schuch@ncu.edu
Peyman Jahed	BFMJ Structural Engrs.	(89)278-5050	P.jahed@bfmj.com
Tony Hans	CMTA		THANS@CMTAREGERS.COM
harry Blok	NKU		BLAKELI@NKU.EDU
TRACY STEWARD	CMTA		tsteward@CMTAREGERS.COM
GEORGE NIKOLAJEVICH	CANNON	(314)241-6250	
PEER VOORKEES	CANNON	314.425.8702	rvoorkees@cannondesign.com
JOHN MAWSTER	CANNON		

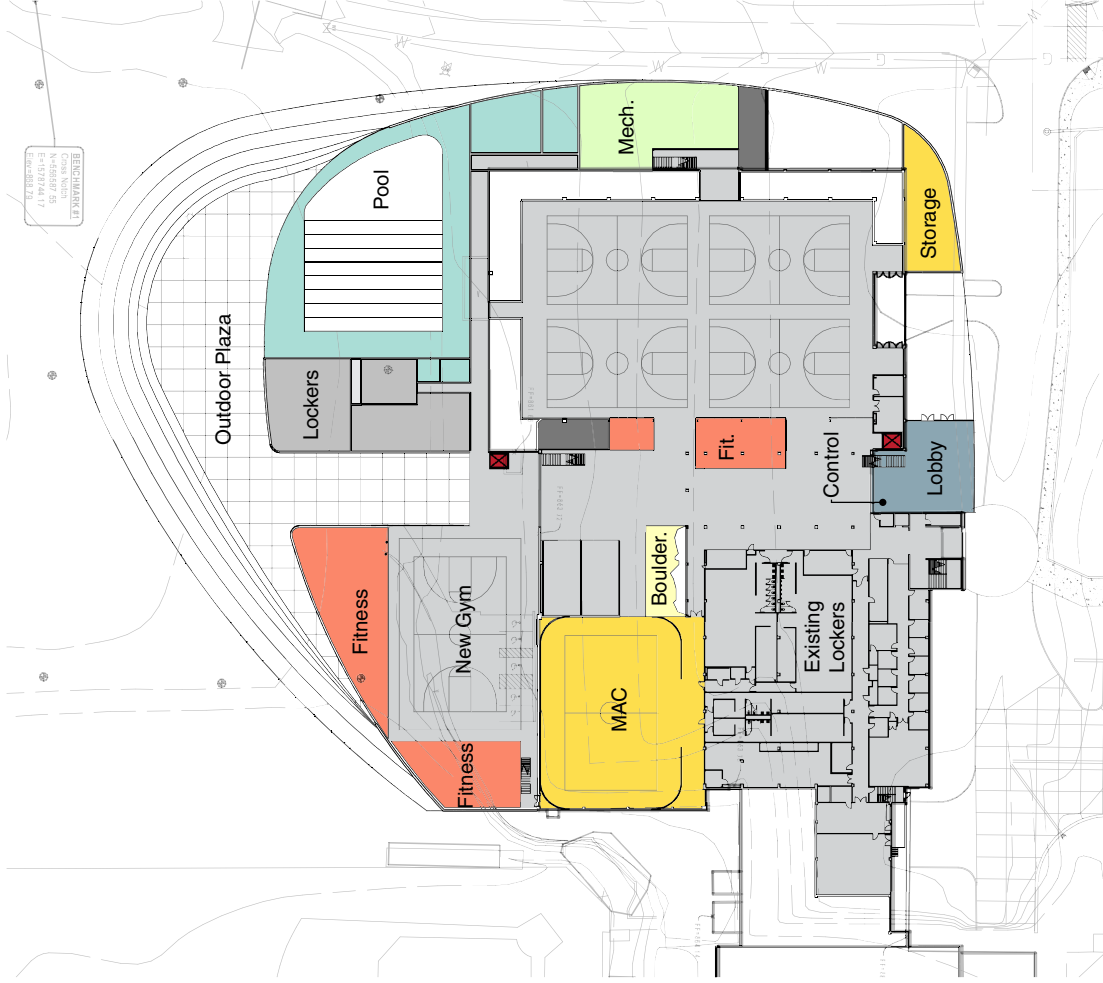

Scheme A
First Floor Plan



North

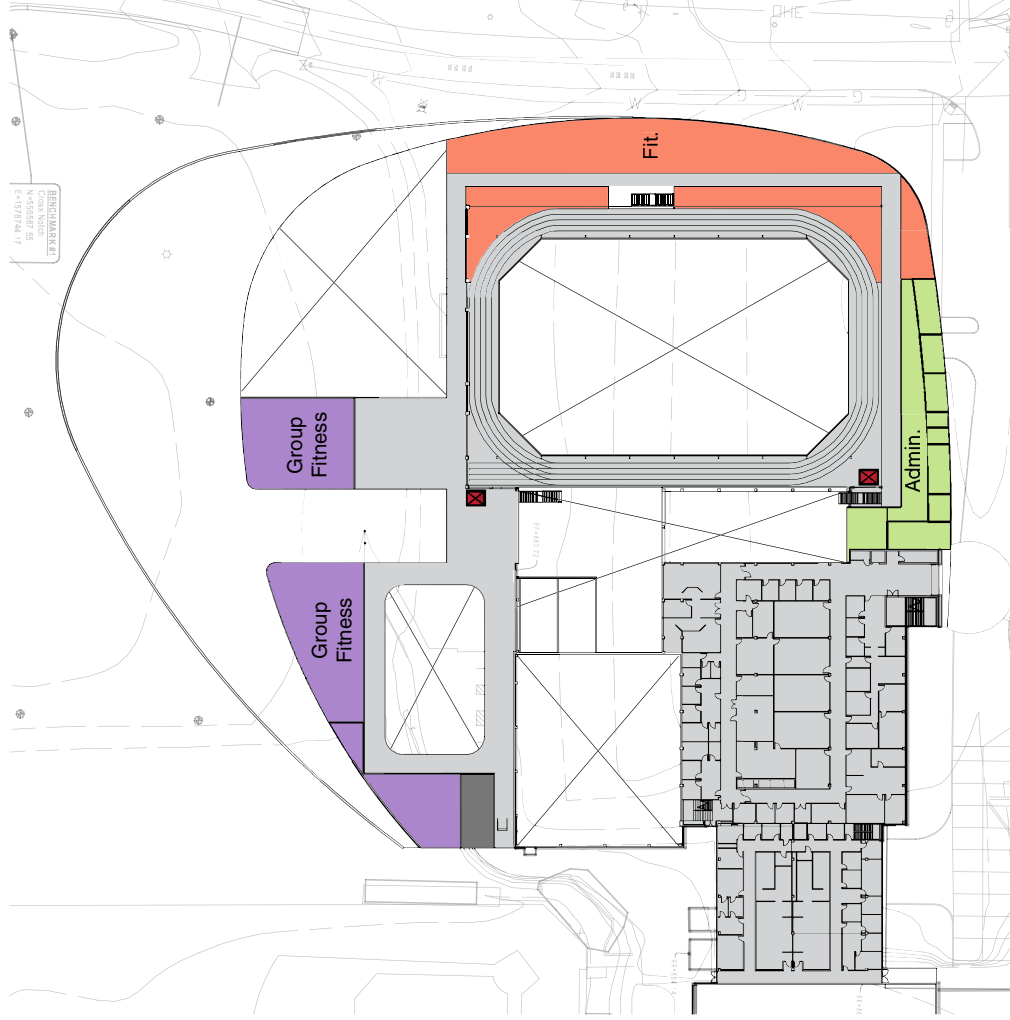

Scheme A
Second Floor Plan





Scheme A
Site Plan



North

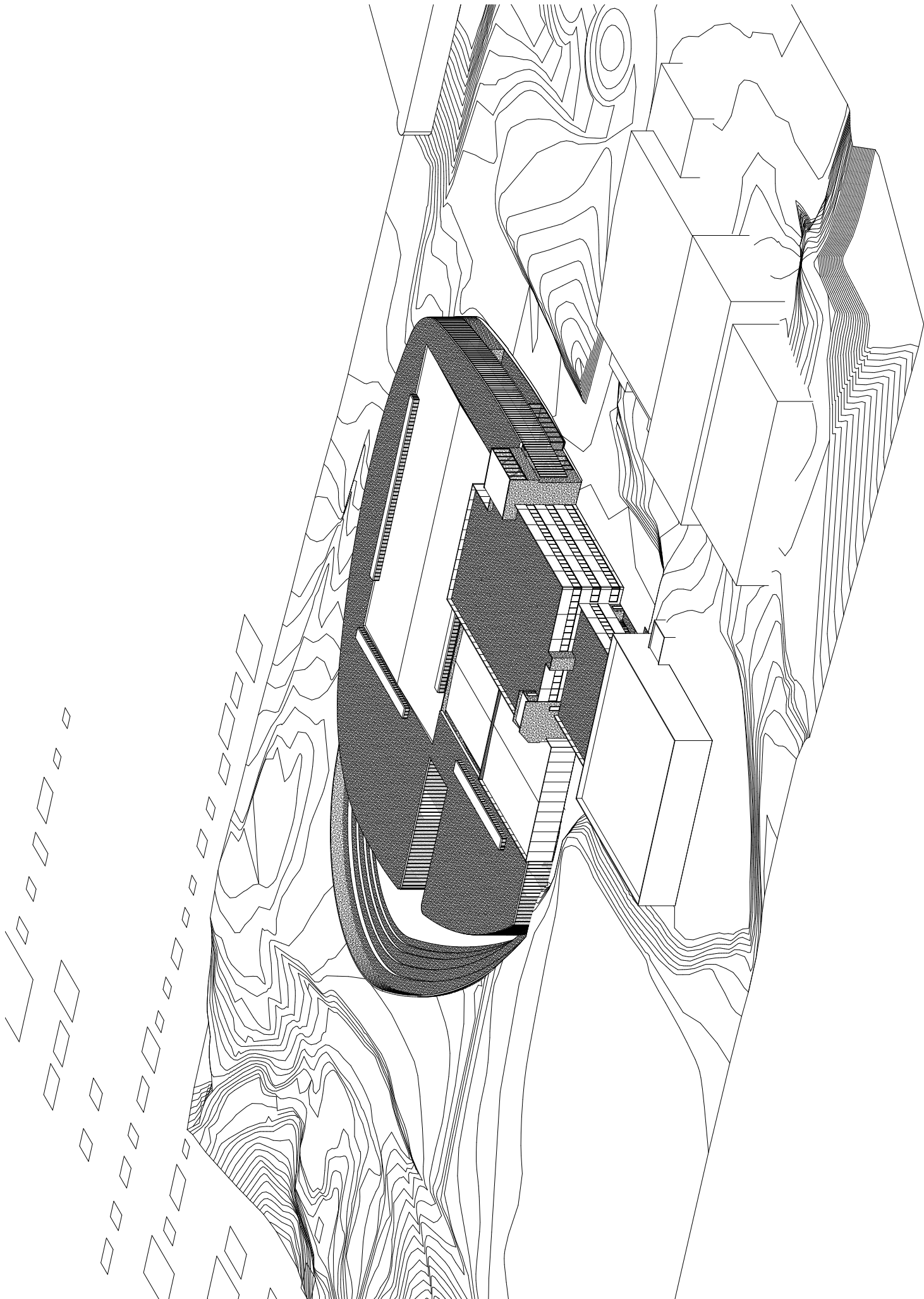

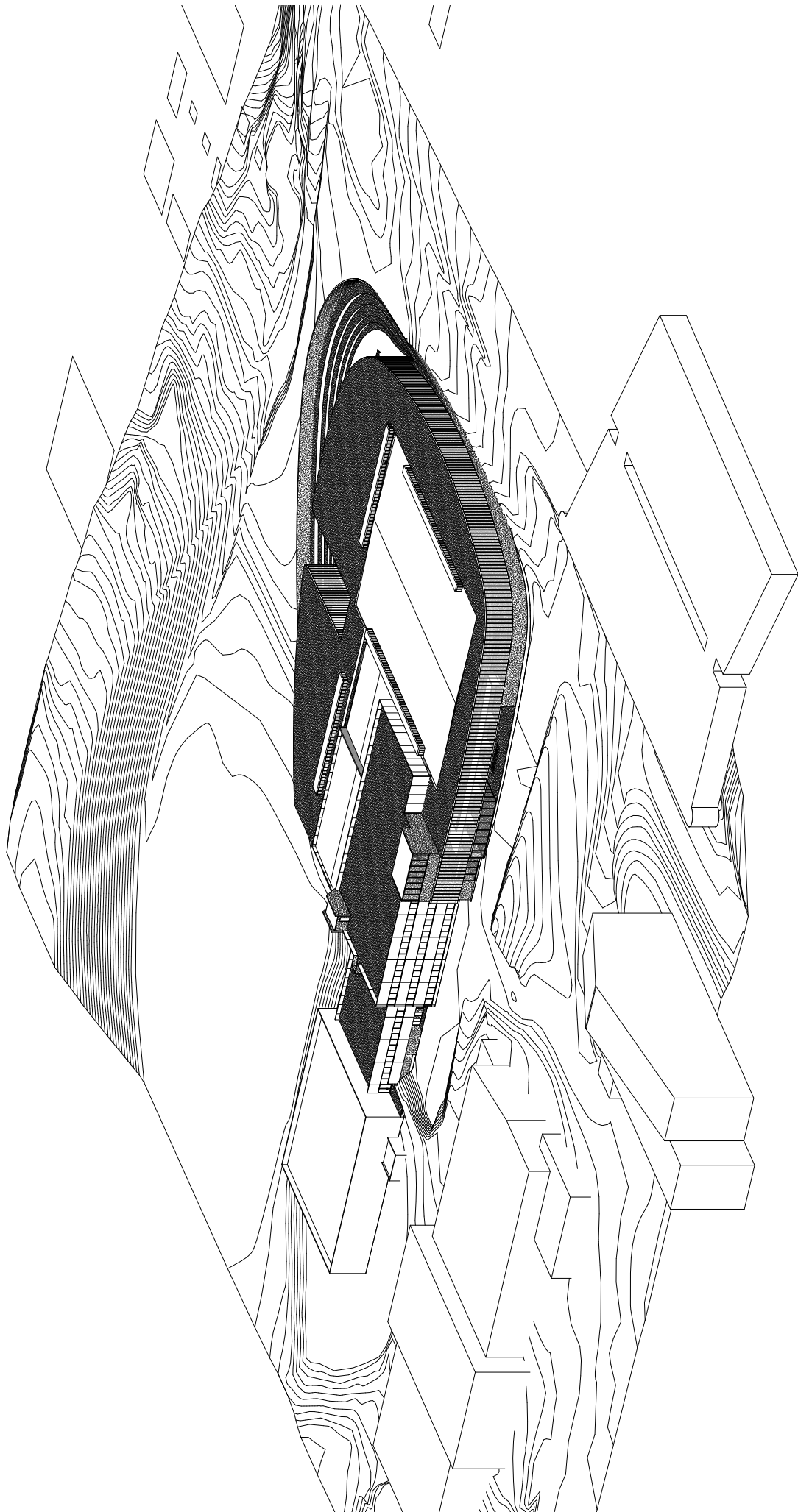

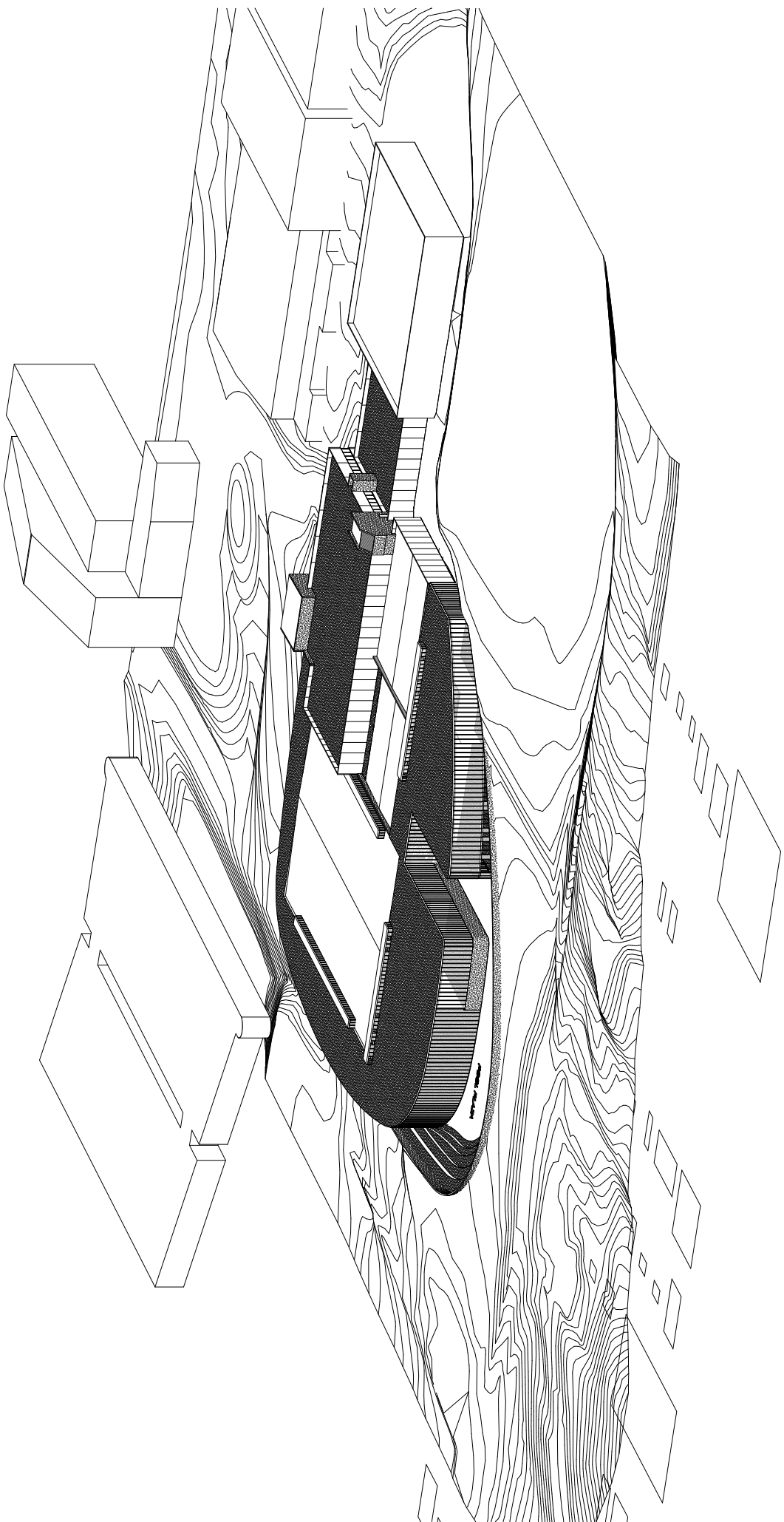

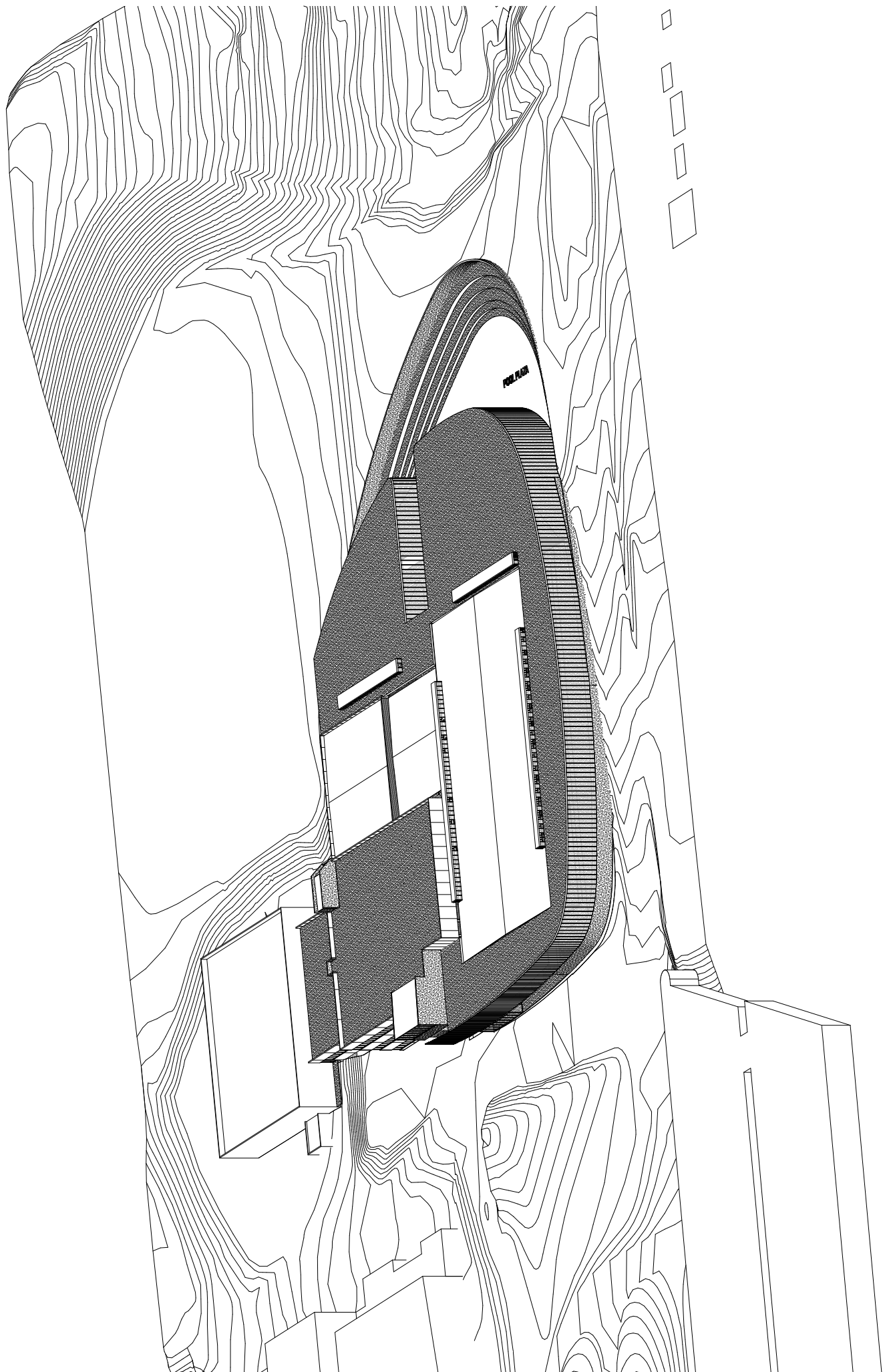

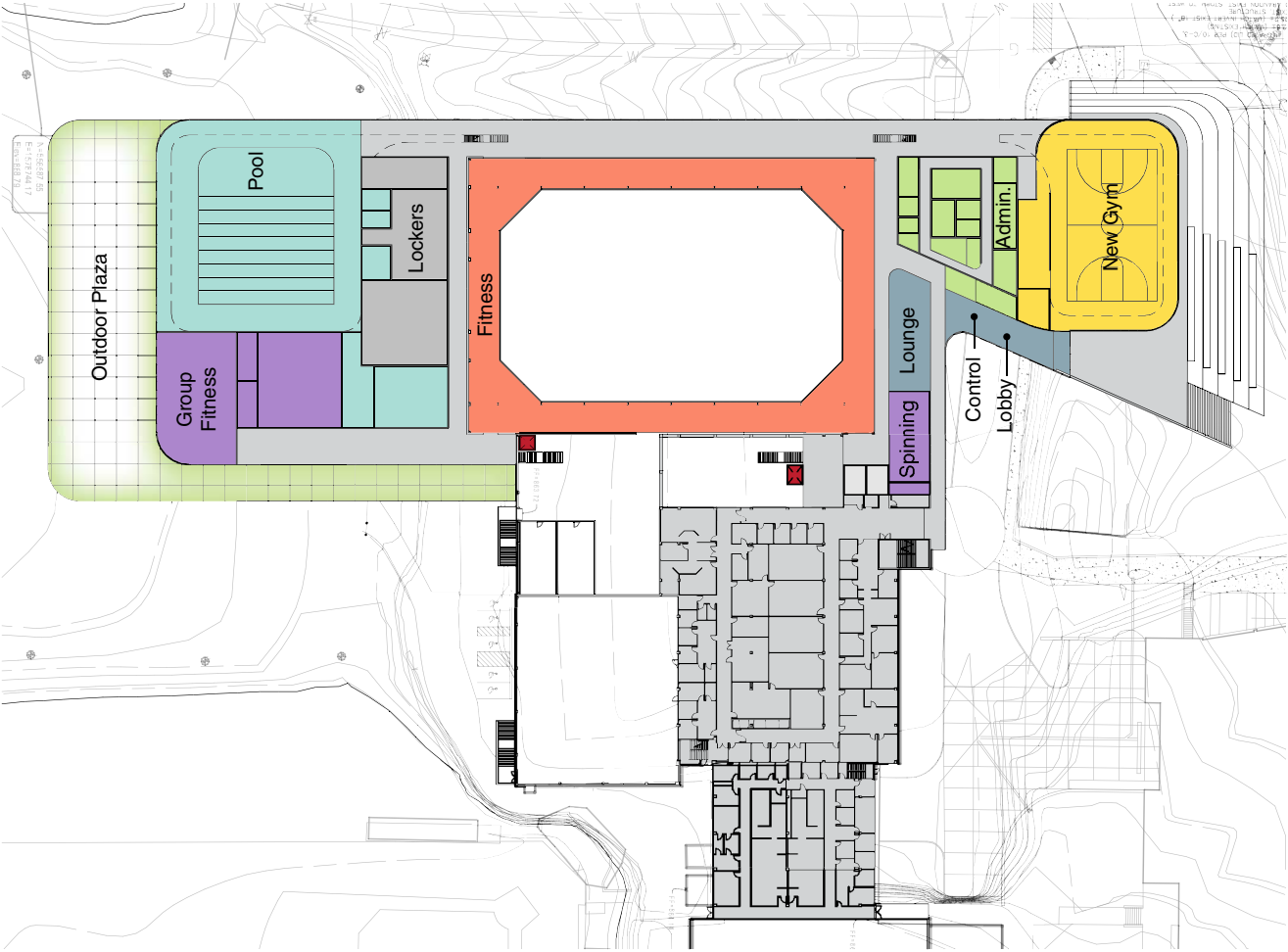

Scheme B
Second Floor Plan



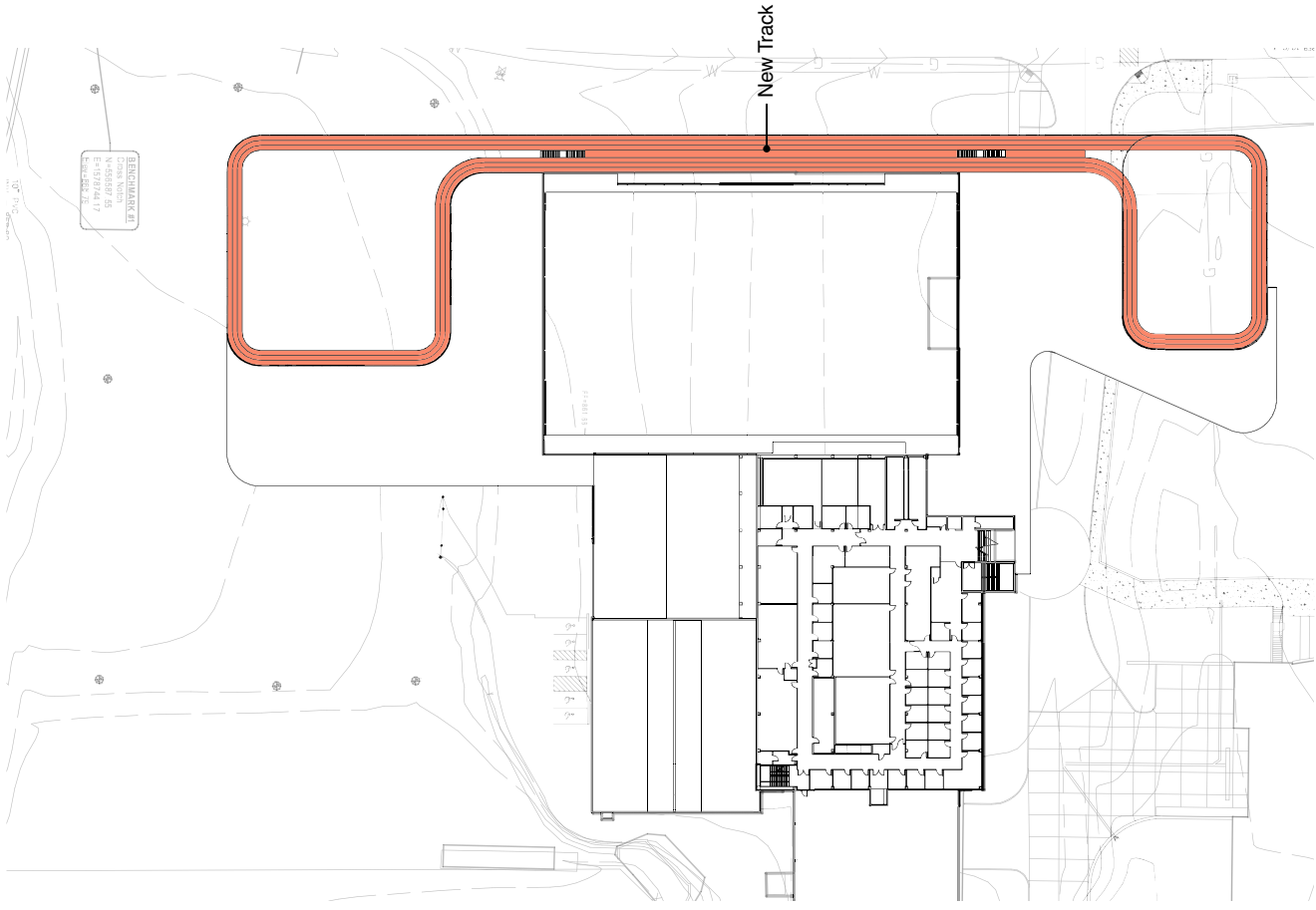

Scheme B
Track Level Plan



Scheme B
Site Plan



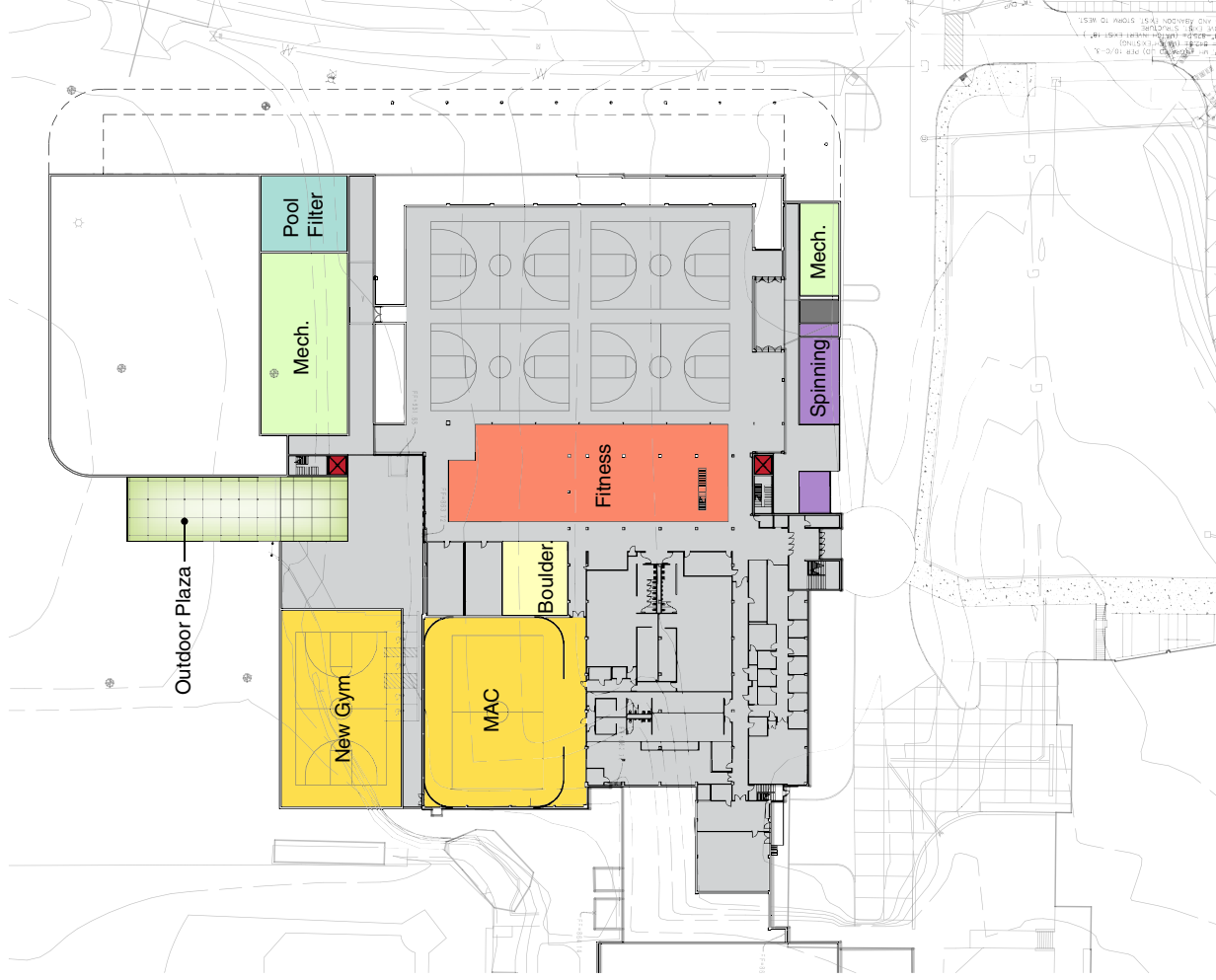

Scheme C
First Floor Plan

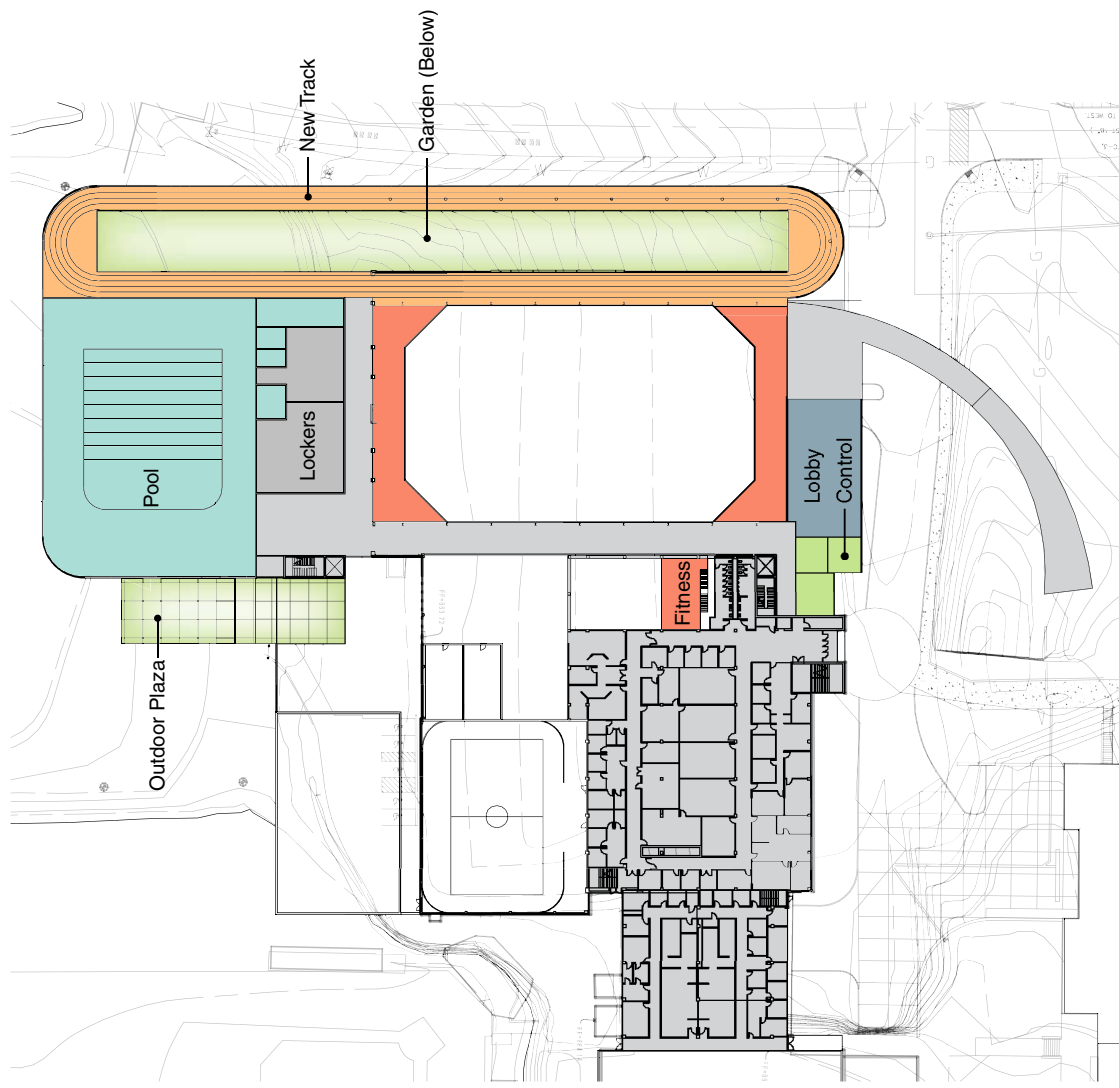

Scheme C
Second Floor Plan

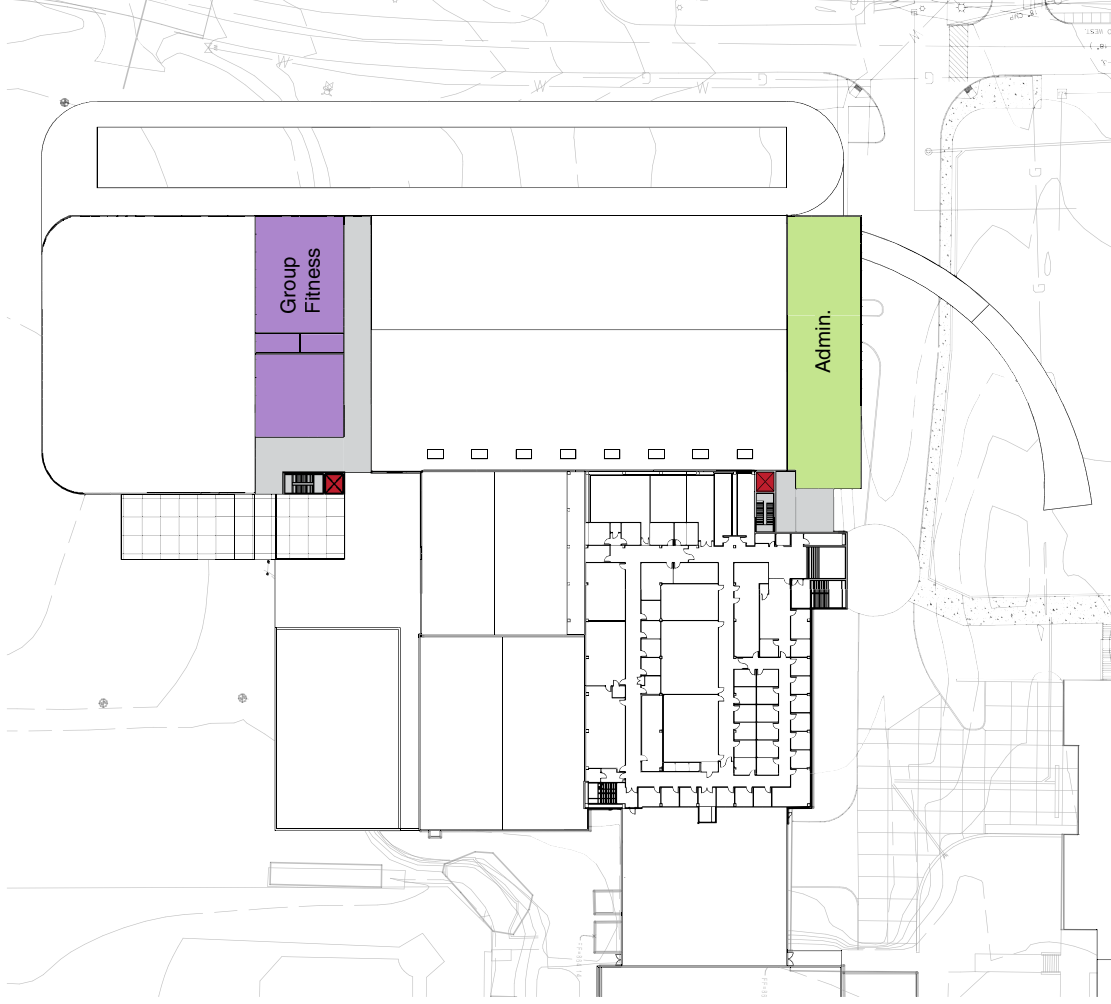

Scheme C
Third Floor Plan



