

**SD PHASE MEETING MINUTES****DATE** April 5, 2012**FROM** Michael Jacobs, AIA, CID, LEED AP
Principal Architect**TO** Rob Knarr, PE (for distribution to NKU)
Project Manager**SUBJECT** **Campus Recreation Center**
Northern Kentucky University
Highland Heights, KY**5c**

COMMENTS: The Project Steering Committee (PSC) meeting convened at 3:00pm and The Project Executive Committee reconvened after to summarize the previous two meetings. This summary meeting included the NKU Project Executive Committee, Cannon Design and Omni Architects in Room SU302 of the Student Union. The summary meeting was to review the preliminary schematic design schemes and discussions from the previous two meetings to decide which options and elements from the designs the team should continue to pursue.

Schematic Design Summary**3:00pm – 4:00pm****SU 302**

Based upon the reaction of the PSC, the design team was instructed to proceed with Scheme A.

Mary Paula began the meeting by suggesting that the group review some key elements that need to be considered for the next phase of schematic design.

- If the 2nd floor restroom is removed the restroom will need to be replaced in the new building. Since it serves the Albright Center then it will need to be accessible from the Albright Center
- Larry stated that the 2nd Level Pedestrian Bridge/Entry needs to be considered by the design team until the idea is ruled out as a concept that doesn't work for this project
 - Mary Paula questioned if everyone that enters the recreation center would use such a bridge and if not, that may be something to consider when reviewing the idea in the next phase.
- Larry asked about the relocation/replacement of the existing parking spaces in front of the existing recreation center if the "plaza" concept is going to proceed forward
 - The current parking spaces for the existing Recreation Center and Albright Center are located in 3 separate locations, but just replacing/relocating the

**SD PHASE MEETING MINUTES**

Page 2

- o existing accessible spaces near the entry to Albright would work since these spaces are utilized by COHP.
- Could the o accessible spaces be located to the east side of the entry to the Albright Center?
- Could the o accessible spaces be located in the existing parking garage? Perhaps only the CRC spaces could be.
- Mary Paula noted that the proposed design takes away the service road entry to the baseball fields behind the existing recreation center. Service trucks will need access to this part of the baseball field. The EMS vehicles will need access to the field, Regents Hall, Albright Center and the CRC expansion (will they need a perimeter road). Satellite trucks for televised baseball games will need access to the field and will require a utility connection on the site. The fire department will also need access to Regents Hall, but this may be able to occur from the access drive shared by Albright, Regents and the Student Union. Building Services such as pool chemicals and deliveries are anticipated to arrive via the Albright Center dock. The design team will need to check for any code issues with Steve Crocker.
- How does the construction phasing plan for the current schematic design scheme work?
- Larry stated that the LEED credit points need to be verified throughout the design phases. The Griffin Hall project is having to purchase LEED points and NKU would prefer not to have to do that again.
- Mary Paula asked about the design of the proposed glass ribbon around the building exterior and if the material and composition of the ribbon changes in section and/or in elevation. In regards to the day light control of this ribbon, vertical elements could be introduced on the façade of the ribbon to help control the sunlight. Concerned was expressed that an all glass wall would not be very energy efficient.

End of Meeting

**SD PHASE MEETING MINUTES**

Page 3

Meeting minutes have been prepared to establish a record of the meeting and information shared. If you have any questions, additions, comments, or corrections, please forward to Omni Architects for inclusion.

Attachments: Schematic Design Scheme A
Images of physical model study

cc:	Mary Paula Schuh	NKU
	Michael Jacobs	Omni Architects
	Don Adams	Omni Architects
	Jay Copley	Omni Architects
	George Nikolajevich	Cannon Design
	Reed Voorhees	Cannon Design
	David Body	Cannon Design
	John McAlister	Cannon Design
	Steve Crocker	Counsilman-Hunsaker
	Tony Hans	CMTA
	Peyman Jahed	BFMJ
	Vivian Llambi	VLA
	Fred Bowling	VLA
	Mark Gillis	The Sextant Group
	Robert Pass	RP+A
	Correspondence File	

MWJ/mwj

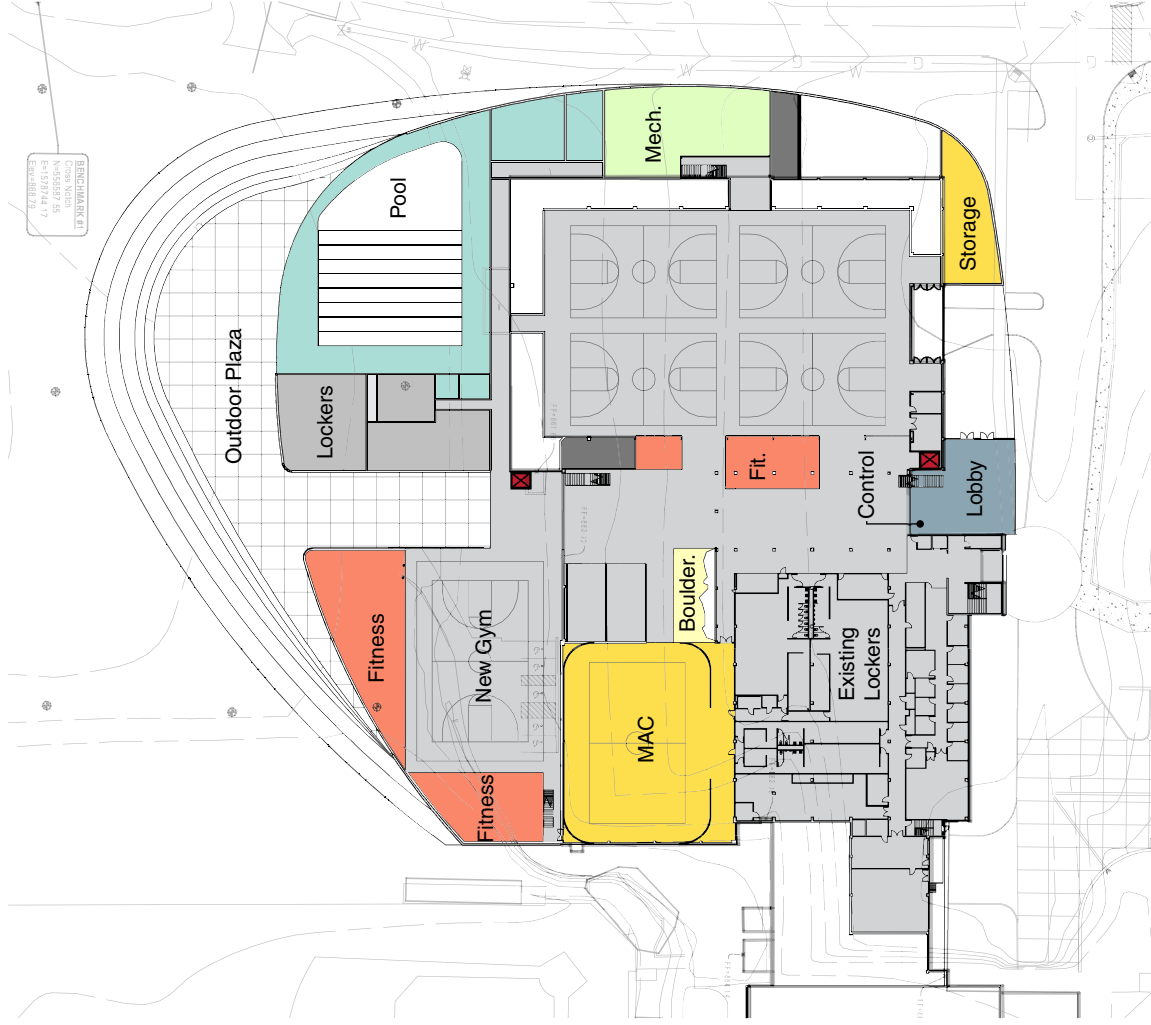

Scheme A
First Floor Plan

North



Scheme A
Site Plan

North

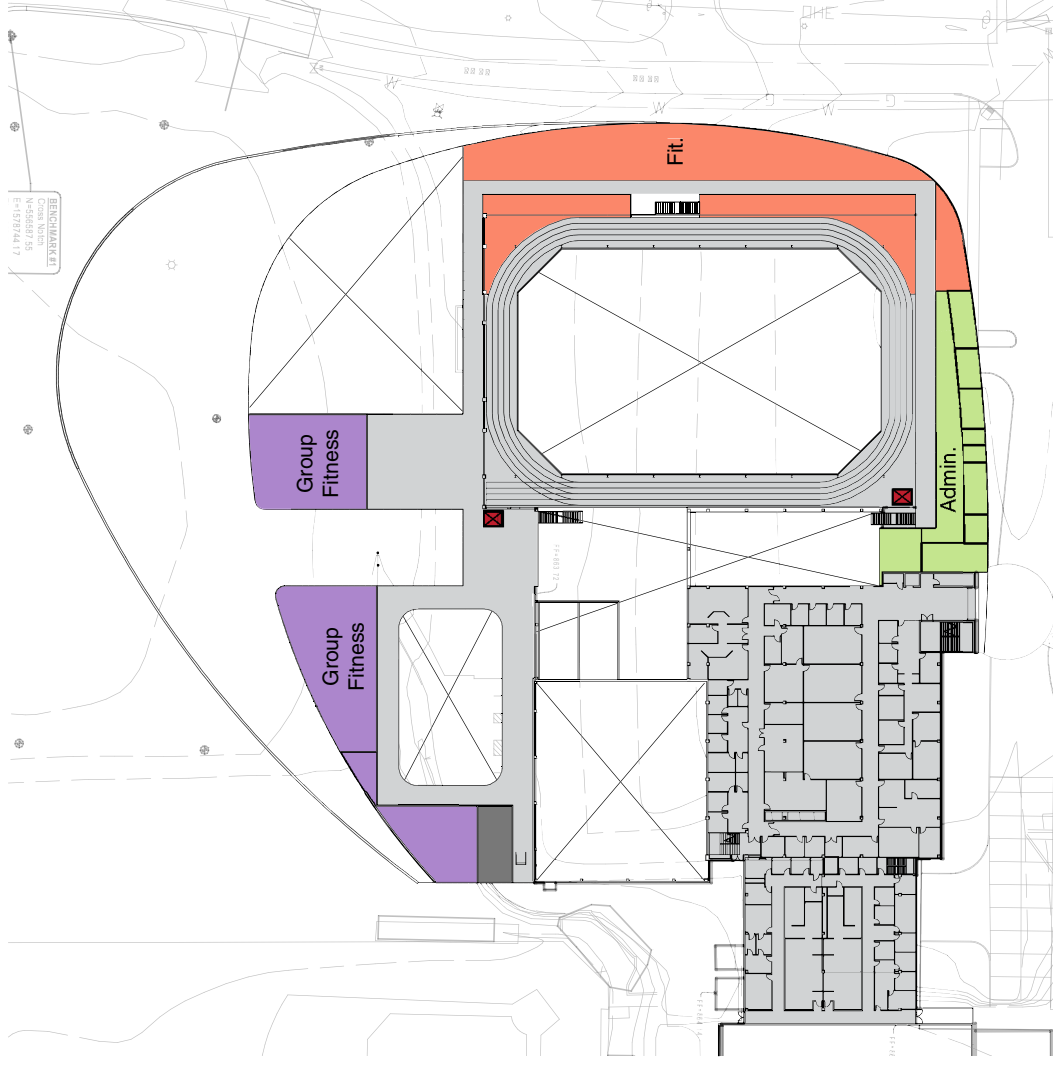

Scheme A
Second Floor Plan



